

- NOTE 1. THE WORK FOR LIGHTING TOWERS TO BE RELOCATED SHALL BE PERFORMED IN ACCORDANCE WITH APPLICABLE PORTIONS OF SECTION 844 OF THE STANDARD SPECIFICATIONS. EXISTING 1000 WATT LUMINAIRES SHALL BE REPLACED WITH NEW 400 WATT LUMINAIRES AND, WHERE NEEDED, ADDITIONAL LUMINAIRES SHALL BE INSTALLED WITH LUMINAIRE ORIENTATION AS SHOWN IN THE PLANS, THE STANDARD SPECIFICATIONS, AND AS DIRECTED BY THE ENGINEER. THE HANDHOLE OF THE RELOCATED TOWERS SHALL BE ORIENTED AS PER APPLICABLE PORTIONS OF SECTION 830 AND 835.
- NOTE 2. THE LUMINAIRE CIRCUIT IDENTIFICATION DECAL ON THE RELOCATED TOWERS SHALL BE CHANGED TO CONFORM WITH THE PLANS, AND SHALL BE IN ACCORDANCE WITH SECTION 844.03 AND AS DIRECTED BY THE ENGINEER.
- NOTE 3. THE FOUNDATION FOR RELOCATED EXISTING TOWERS WILL BE 42" DIAMETER AND WILL HAVE SIX (6) ANCHOR RODS. REFER TO THE DETAIL SHEETS FOR MORE INFORMATION.

REFER TO SHEET NUMBER 166 AND 167 FOR CULVERT DETAILS FOR CROSSING THE DRAINAGE DITCH

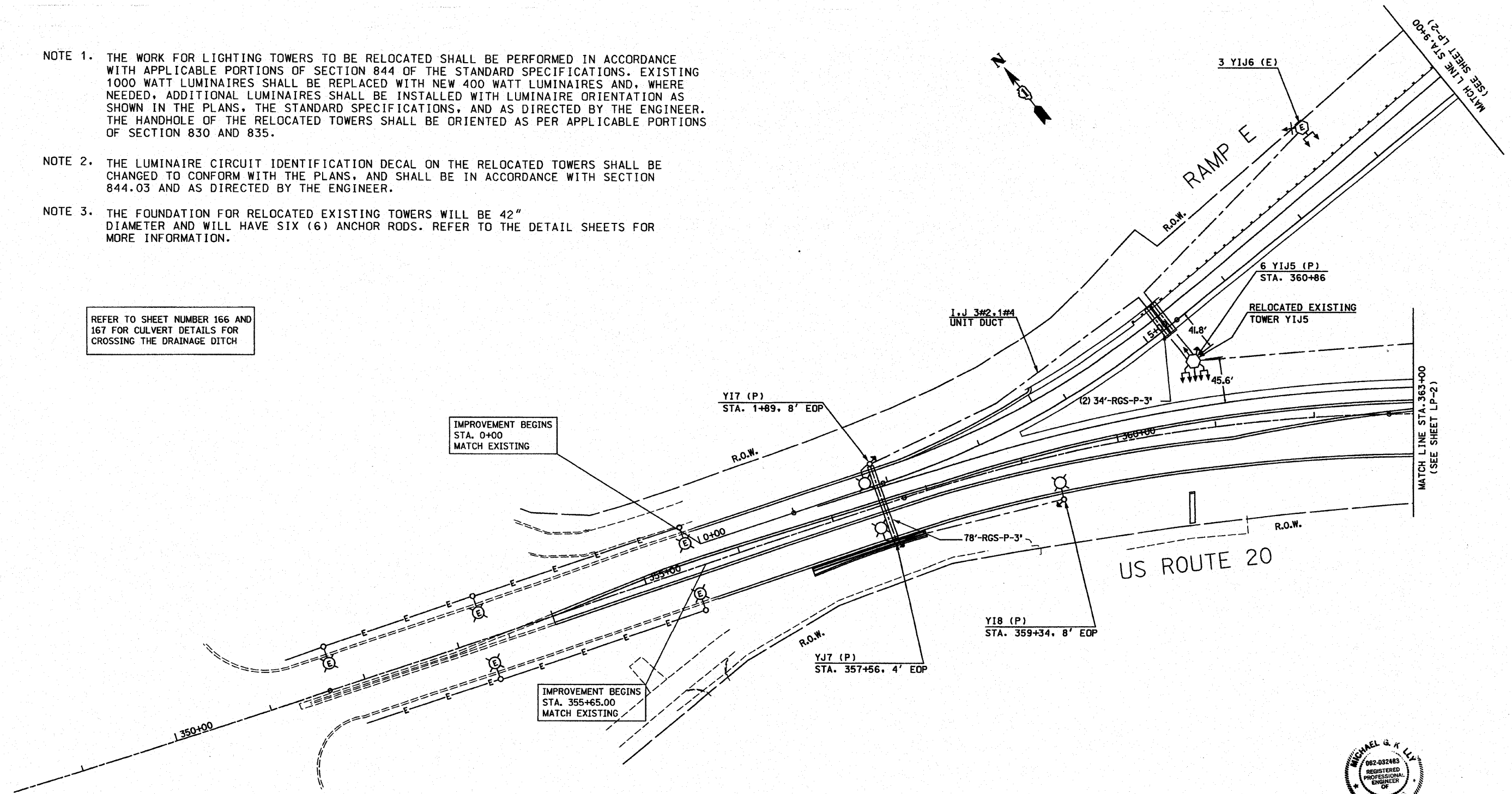

Michael B. Kelly 03/20/10
 Expires 01/30/2011

FILE NAME =	USER NAME = _GAL	DESIGNED - PKG	REVISED -	STATE OF ILLINOIS DEPARTMENT OF TRANSPORTATION	U.S. ROUTE 20 (LAKE STREET) PROPOSED LIGHTING (SHEET 1 OF 3) STA. 355+65 TO STA. 363+00	F.A.P. RTE.	SECTION	COUNTY	TOTAL SHEETS	SHEET NO.	
#FILEL#		DRAWN - MAA, SHM	REVISED -			3537	(4Y&22-3R-2)	DuPage	284	136	
PLOT SCALE = #SCALE#		CHECKED - PKG	REVISED -			CONTRACT NO. D-91-533-00					
PLOT DATE = 3/19/2010		DATE -	REVISED -			FED. ROAD DIST. NO. 1 ILLINOIS FED. AID PROJECT					
				SCALE: 1"=50'	SHEET NO. OF SHEETS	STA. TO STA.					

LP-1