

LEGEND

- WHITE SKIP-DASH PAVEMENT MARKING LINE
- ▶ ONE-WAY AMBER RAISED REFLECTIVE MARKER
- ▷ ONE-WAY CRYSTAL RAISED REFLECTIVE MARKER
- ◀ TWO-WAY AMBER RAISED REFLECTIVE MARKER
- ▲ PROPOSED SIGN
- ◻ EXISTING SIGN

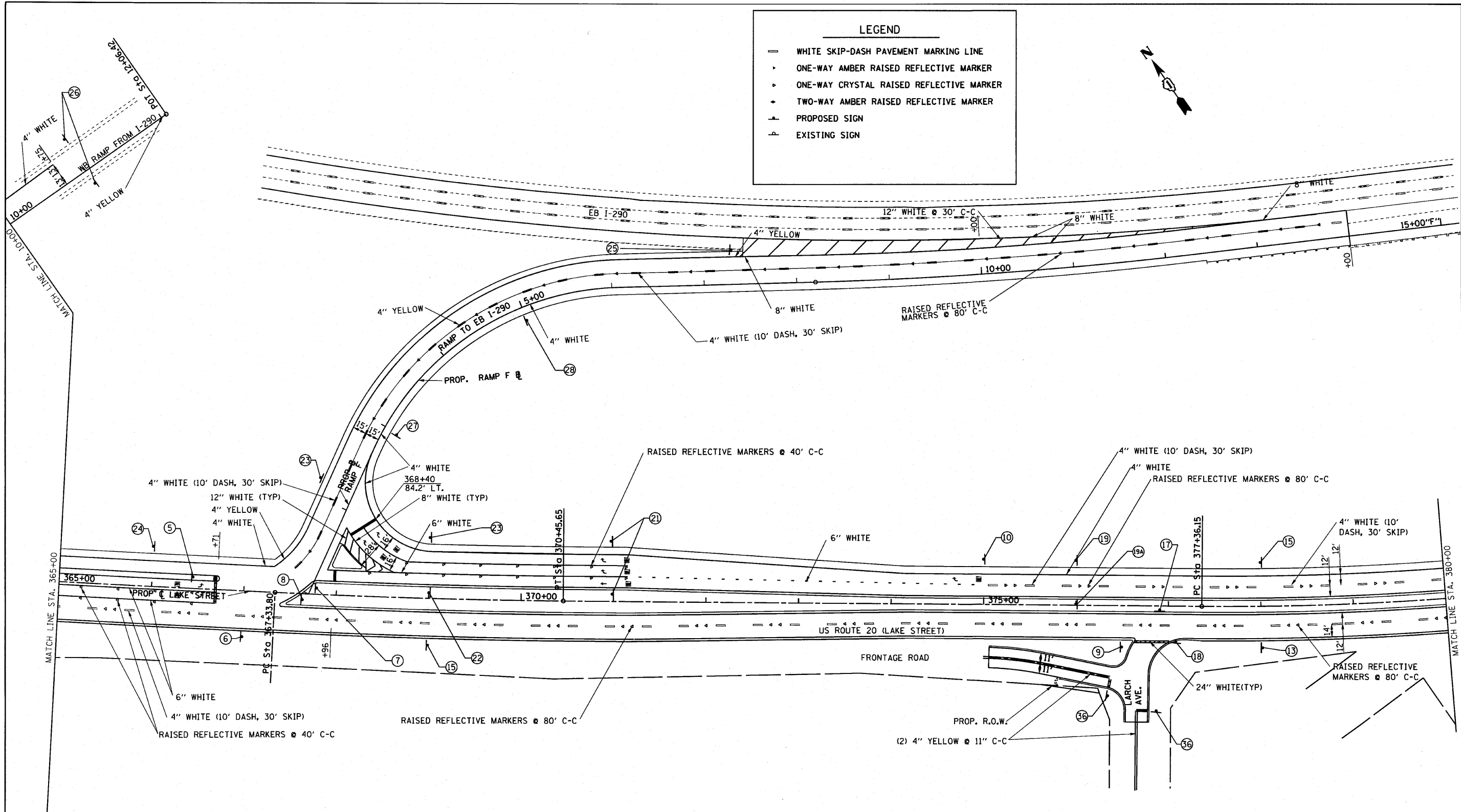

SIGN NOTES

- 1) ALL SIGNS SHALL BE FABRICATED AND ERECTED IN ACCORDANCE WITH THE ILLINOIS MANUAL ON UNIFORM TRAFFIC CONTROL DEVICES.
- 2) ALL NEW SIGNS ARE TO BE MOUNTED ON NEW SUPPORTS UNTIL COMPLETION OF DESIGN OF NEW SIGNALS AND LIGHTING.

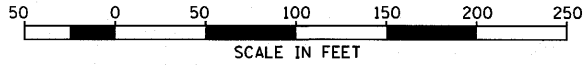

FILE NAME = signing_plan_prop.dgn	USER NAME = erampfer	DESIGNED -	REVISED -
#FILE#		DRAWN - BLV	REVISED -
PLOT SCALE = 1"=50'		CHECKED - SRG	REVISED -
PLOT DATE = 6/8/2010		DATE - 1/18/10	REVISED -

**STATE OF ILLINOIS
DEPARTMENT OF TRANSPORTATION**

**U.S. ROUTE 20 (LAKE STREET)
PROPOSED SIGNING PLAN**

SCALE: 1"=50' SHEET NO. 181 OF SHEETS STA. 365+00 TO STA. 380+00

F.A.J.U. RTE.	SECTION	COUNTY	TOTAL SHEETS	SHEET NO.
3537	(4Y & 22-3)R-2	DUPAGE	284	181
CONTRACT NO. 62093				
ILLINOIS FED. AID PROJECT				