

QUANTITY  
 4 (100) LINE = 64.1 ft. (19.7 m)  
 21.1 sq. ft. (1.97 sq. m)

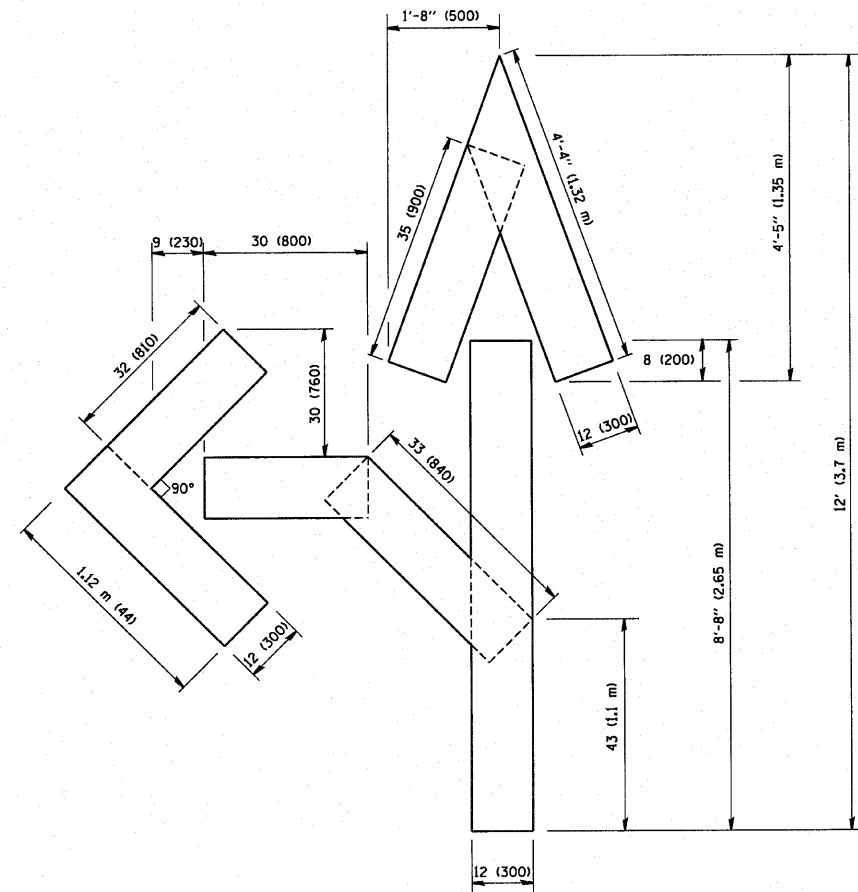

QUANTITY  
 4 (100) LINE = 82.5 ft. (25.3 m)  
 27.5 sq. ft. (2.53 sq. m)

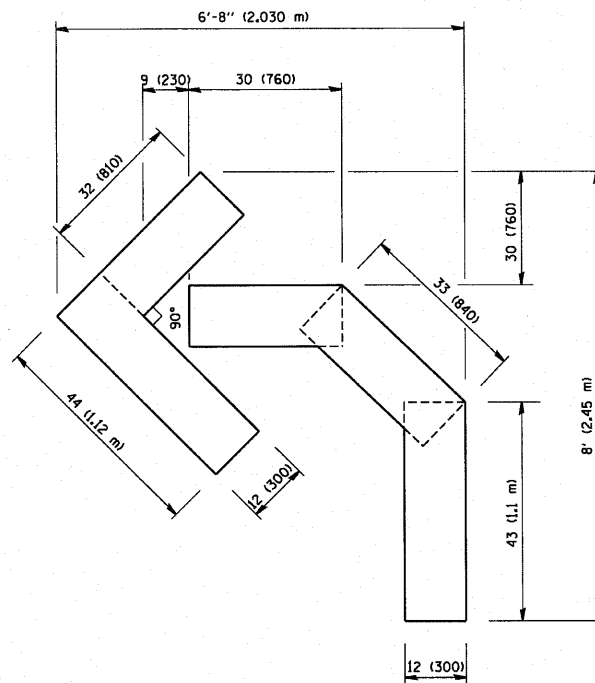

QUANTITY  
 4 (100) LINE = 45.5 ft. (13.9 m)  
 15.2 sq. ft. (1.39 sq. m)

All dimensions are in inches (millimeters) unless otherwise shown.

FILE NAME = W:\diststd\22x34\tcl6.dgn	USER NAME = gaglienobt	DESIGNED -	REVISED - T. RAMMACHER 06-05-96	<b>STATE OF ILLINOIS DEPARTMENT OF TRANSPORTATION</b>	<b>PAVEMENT MARKING LETTERS AND SYMBOLS FOR TRAFFIC STAGING</b>			F.A. RTE.	SECTION	COUNTY	TOTAL SHEETS	SHEET NO.
		DRAWN -	REVISED - T. RAMMACHER 11-04-97		SCALE: NONE	SHEET NO. 1	OF 1	SHEETS	STA.	TO STA.	284	231
		CHECKED -	REVISED - T. RAMMACHER 03-02-98									
		DATE - 09-18-94	REVISED - E. GOMEZ 08-28-00									
								<b>TC-16</b>		<b>CONTRACT NO. 62093</b>		
								FED. ROAD DIST. NO. 1   ILLINOIS FED. AID PROJECT				