

PLAN	DATE	BY
REVISION		
APPROVED		
INCHMENT CHECKED		
NOTE BOOK		
NO.		

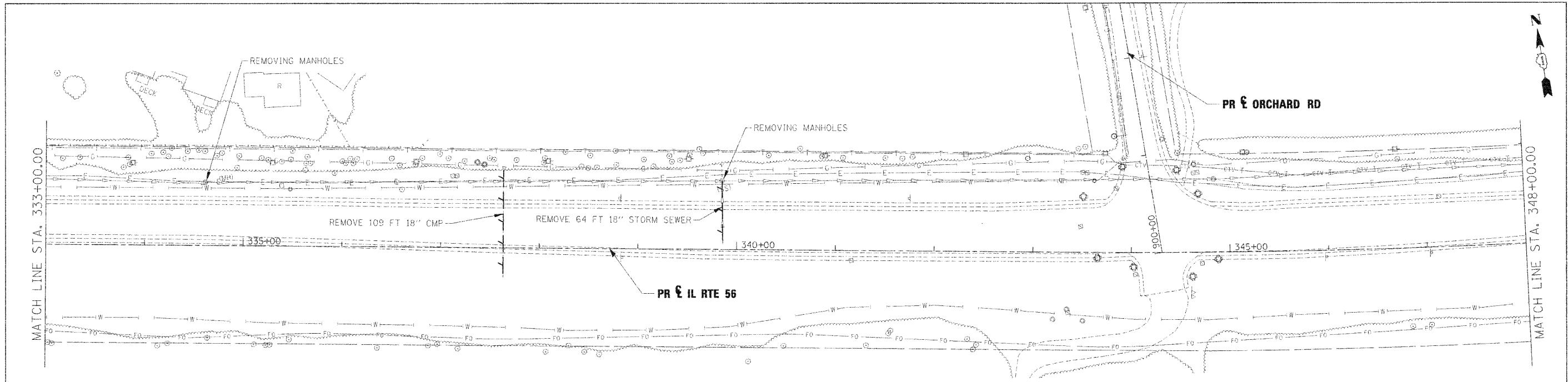

LEGEND

	SHEET FLOW		6' X 4' RCB		CATCH BASIN
	SWALE		CULVERT SIZE (HxV) TYPE		HEADWALL
	DITCH		BRIDGE LOCATION		INLET
	CHANNEL		STORM SEWER		MANHOLE
			LOCAL STORM SEWER		
			END SECTION		
			OUTLET		

NOTES:

- EXISTING STORM SEWER REMOVAL OR CULVERT REMOVAL WILL NOT BE PAID FOR SEPARATELY WHEN LOCATED WITHIN THE PROPOSED STORM SEWER OR CULVERT TRENCH. THIS WORK TO BE CONSIDERED AS PART OF THE PROPOSED STORM SEWER OR CULVERT INSTALLATION AND WILL NOT BE PAID SEPARATELY. (THIS DOES NOT INCLUDE BOX CULVERT REMOVAL)
- STORM SEWER REMOVAL TO BE PAID FOR AS STORM SEWER REMOVAL XX" (PAY ITEM 5510XXXX)

PROFILE	DATE	BY
REVISION		
APPROVED		
INCHMENT CHECKED		
NOTE BOOK		
NO.		

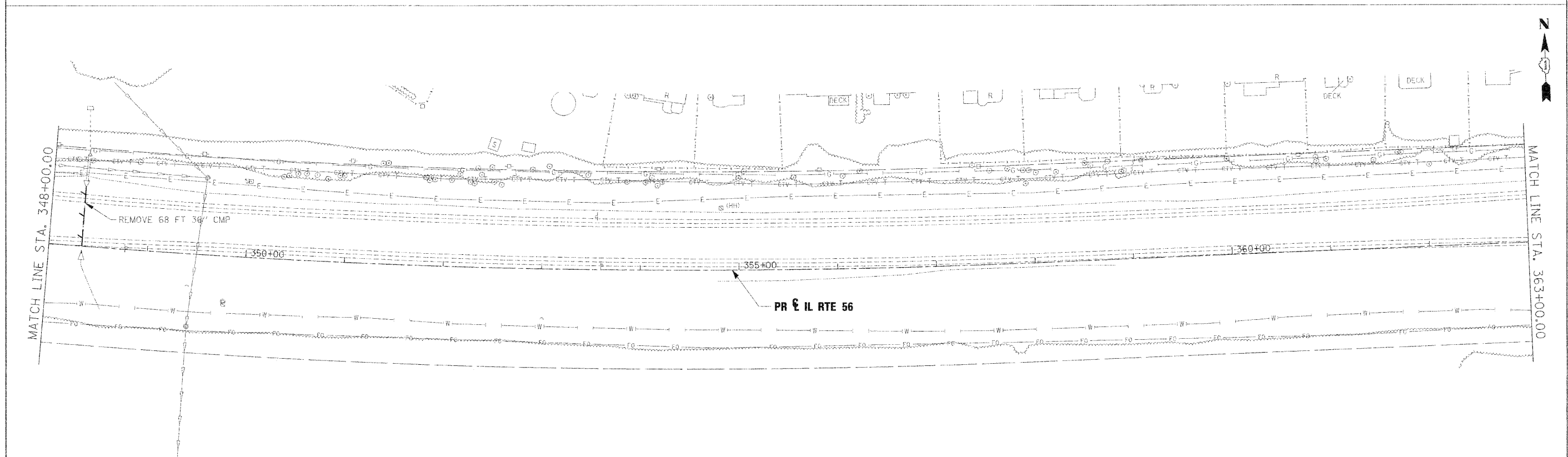

USER NAME	DESIGNED - KEM	REVISED - ADDENDUM I- 1/4/2011		STATE OF ILLINOIS DEPARTMENT OF TRANSPORTATION	DRAINAGE REMOVAL PLAN IL RTE 56	F.A.P. RTE.	SECTION	COUNTY	TOTAL SHEET NO.	
PLOT SCALE = 1" = 50'	DRAWN - KEM	REVISED -				365	157 & 581WRS-2	DUPAGE	681	255
PLOT DATE	CHECKED - LSM	REVISED -				CONTRACT NO. 62419		ILLINOIS FED. AID PROJECT		

SCALE: 1"=50' SHEET NO. 4 OF 9 SHEETS STA. 333+00.00 TO STA. 363+00.00