

DATE	
BY	
REVISION	
APPROVED	
DESIGNED	
DRAWN	
CHECKED	
DATE	

DATE	
BY	
REVISION	
APPROVED	
DESIGNED	
DRAWN	
CHECKED	
DATE	

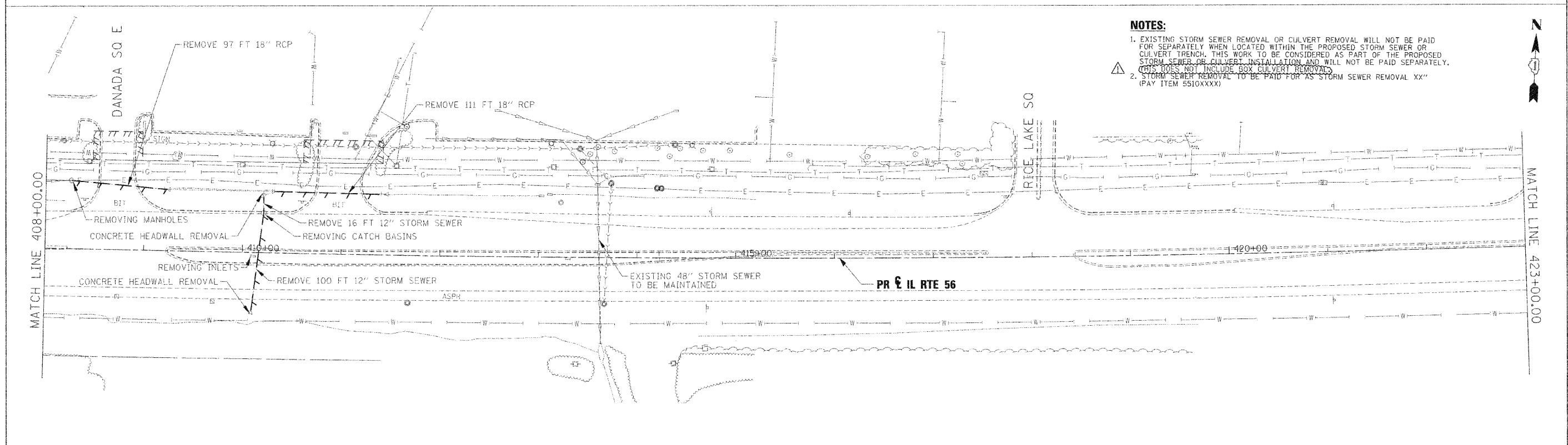
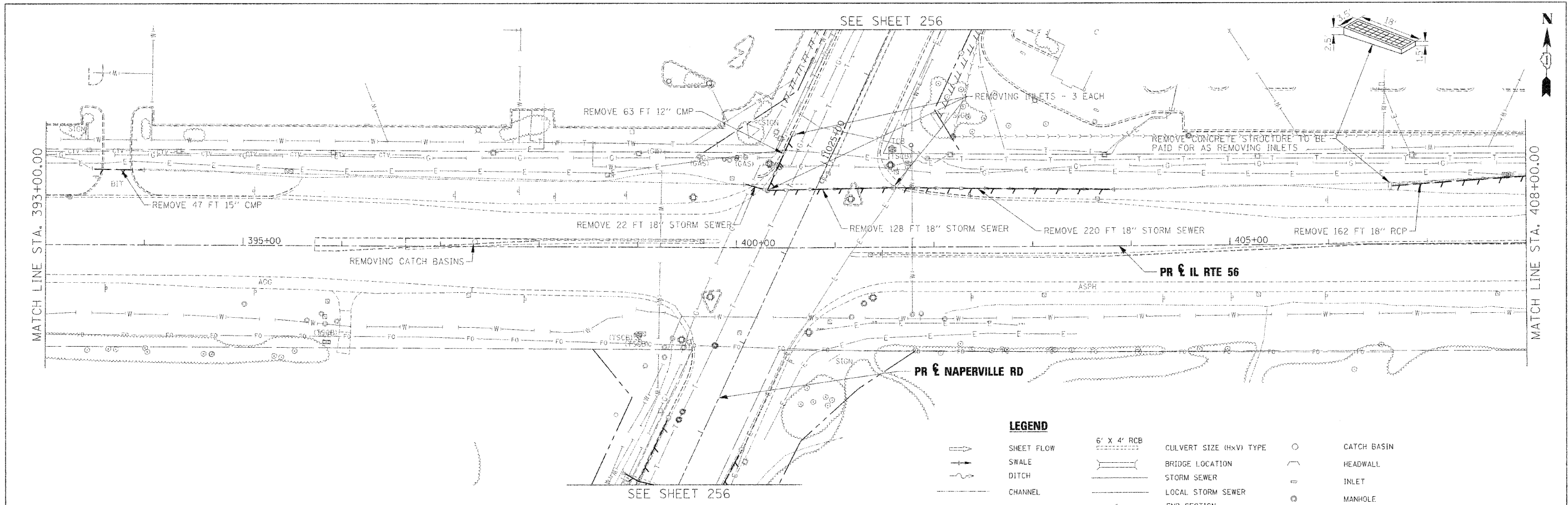

**NOTES:**  
 1. EXISTING STORM SEWER REMOVAL OR CULVERT REMOVAL WILL NOT BE PAID FOR SEPARATELY WHEN LOCATED WITHIN THE PROPOSED STORM SEWER OR CULVERT TRENCH. THIS WORK TO BE CONSIDERED AS PART OF THE PROPOSED STORM SEWER OR CULVERT INSTALLATION AND WILL NOT BE PAID SEPARATELY. (THIS DOES NOT INCLUDE BOX CULVERT REMOVAL)  
 2. STORM SEWER REMOVAL TO BE PAID FOR AS STORM SEWER REMOVAL XX" (PAY ITEM 5510XXXX)

USER NAME *	DESIGNED - KEM	REVISED - ADDENDUM 1- 1/4/2011
PILOT SCALE = 1" = 50'	DRAWN - KEM	REVISED -
PILOT DATE *	CHECKED - LSM	REVISED -
	DATE - 12/6/10	REVISED -



STATE OF ILLINOIS  
DEPARTMENT OF TRANSPORTATION

DRAINAGE REMOVAL PLAN  
IL RTE 56  
SCALE: 1"=50' SHEET NO. 6 OF 9 SHEETS STA. 393+00.00 TO STA. 423+00.00

F.A.P. RTE.	SECTION	COUNTY	TOTAL SHEETS	SHEET NO.
365	157 & 58WRS-2	DUPAGE	681	257
CONTRACT NO.			62419	
ILLINOIS FED. AID PROJECT				