

DATE	BY	REVISIONS
		1. REVISED
		2. PLOTTED
		3. CHECKED
		4. APPROVED
		5. FILED
		6. NO.

DATE	BY	REVISIONS
		1. REVISED
		2. PLOTTED
		3. CHECKED
		4. APPROVED
		5. FILED
		6. NO.

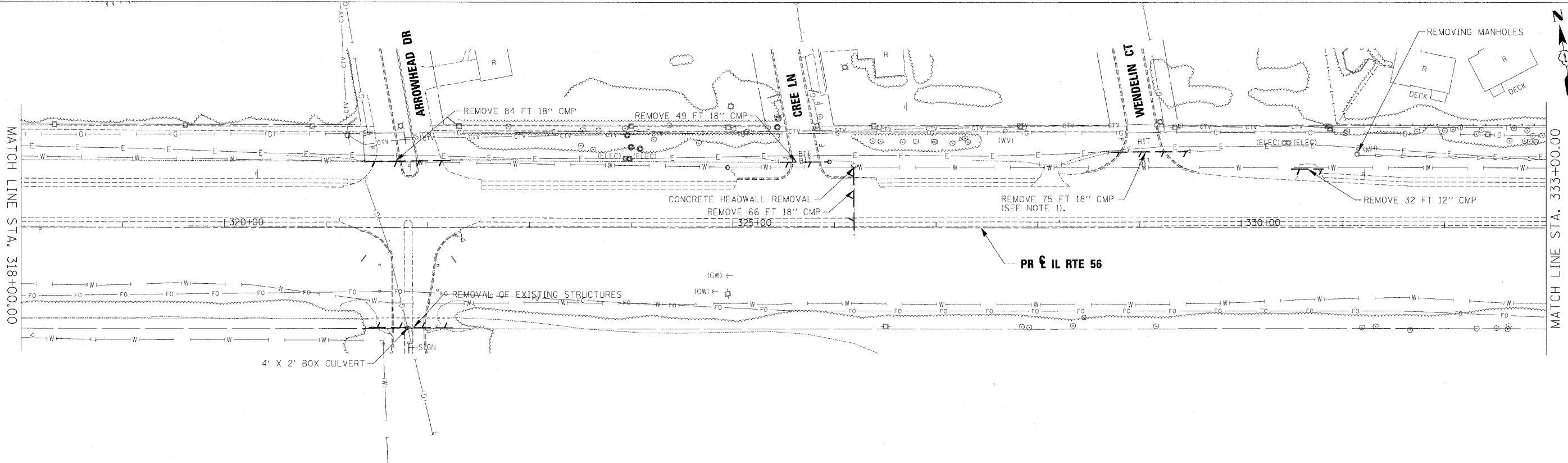
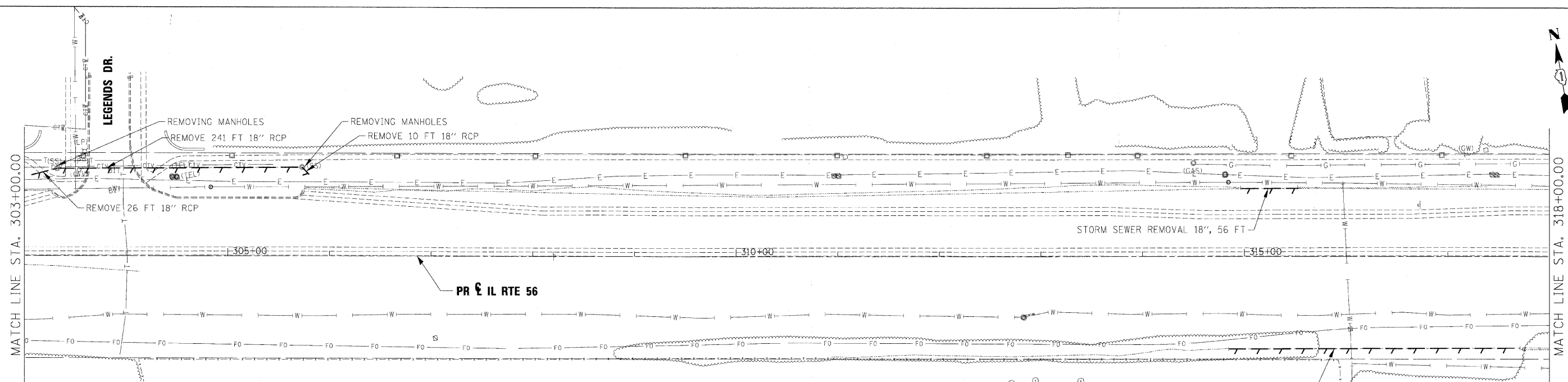

**NOTES:**  
 1. EXISTING STORM SEWER REMOVAL OR CULVERT REMOVAL WILL NOT BE PAID FOR SEPARATELY WHEN LOCATED WITHIN THE PROPOSED STORM SEWER OR CULVERT TRENCH. THIS WORK TO BE CONSIDERED AS PART OF THE PROPOSED STORM SEWER OR CULVERT INSTALLATION AND WILL NOT BE PAID SEPARATELY.  
 2. STORM SEWER REMOVAL TO BE PAID FOR AS STORM SEWER REMOVAL "XX" (PAY ITEM 5510XXXX)

USER NAME	DESIGNED - KEM	REVISED -
	DRAWN - KEM	REVISED -
PLOT SCALE - 1" = 50'	CHECKED - LSM	REVISED -
PLOT DATE	DATE - 12/6/10	REVISED -



STATE OF ILLINOIS  
DEPARTMENT OF TRANSPORTATION

DRAINAGE REMOVAL PLAN IL RTE 56		
SCALE: 1"=50'	SHEET NO. 3 OF 9 SHEETS	STA. 303+00.00 TO STA. 333+00.00

F.A.P. RTE.	SECTION	COUNTY	TOTAL SHEETS	SHEET NO.
365	(57 & 58)WRS-2	DUPAGE	681	254
CONTRACT NO. 62419			ILLINOIS FED. AID PROJECT	