

DATE	BY
DESIGNED	BY
DRAWN	BY
CHECKED	BY
DATE	BY

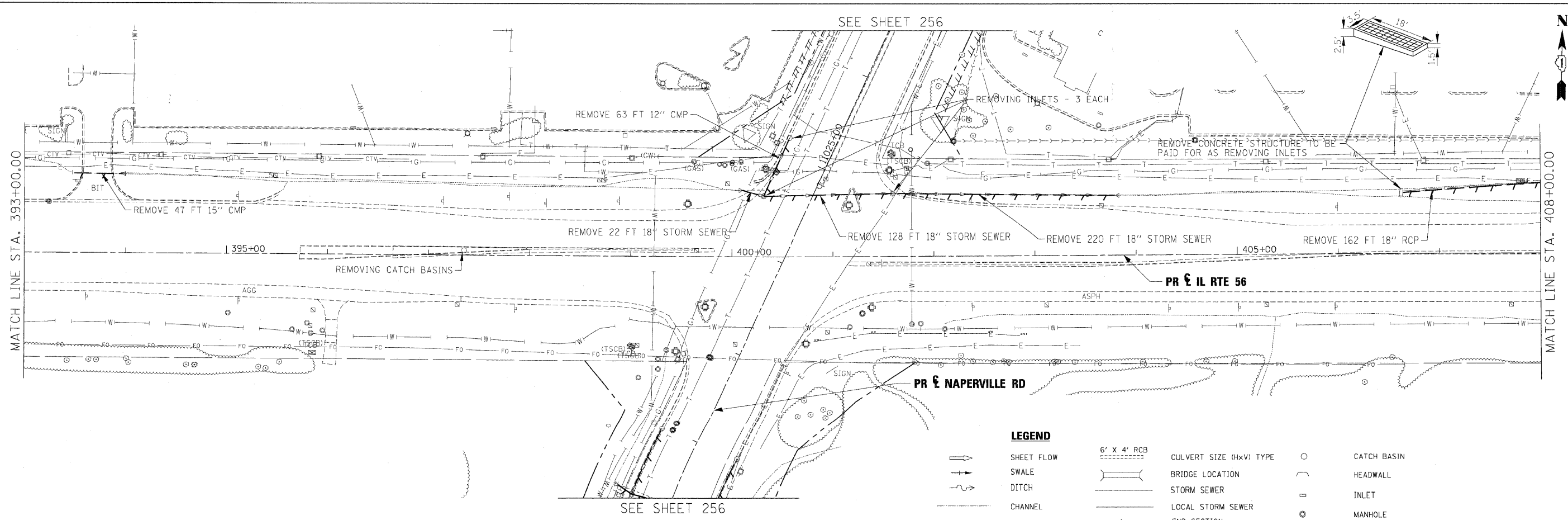

LEGEND

	SHEET FLOW		6' X 4' RCB		CULVERT SIZE (HxV) TYPE		CATCH BASIN
	SWALE		BRIDGE LOCATION		HEADWALL		INLET
	DITCH		STORM SEWER		MANHOLE		
	CHANNEL		LOCAL STORM SEWER		END SECTION		OUTLET

NOTES:

- EXISTING STORM SEWER REMOVAL OR CULVERT REMOVAL WILL NOT BE PAID FOR SEPARATELY WHEN LOCATED WITHIN THE PROPOSED STORM SEWER OR CULVERT TRENCH. THIS WORK TO BE CONSIDERED AS PART OF THE PROPOSED STORM SEWER OR CULVERT INSTALLATION AND WILL NOT BE PAID SEPARATELY.
- STORM SEWER REMOVAL TO BE PAID FOR AS STORM SEWER REMOVAL XX" (PAY ITEM 5510XXXX)

DATE	BY
DESIGNED	BY
DRAWN	BY
CHECKED	BY
DATE	BY

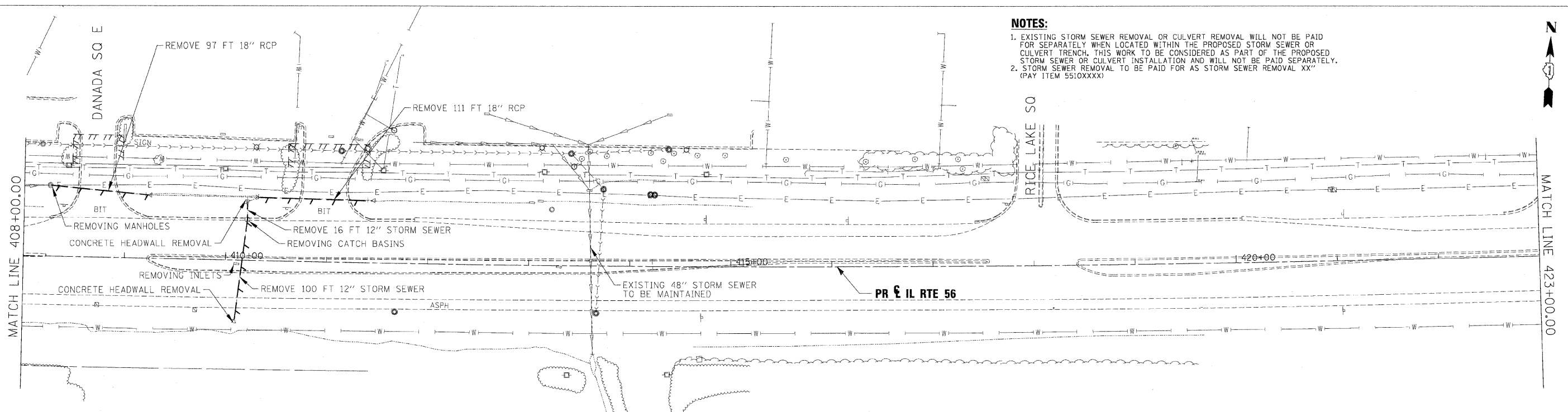

USER NAME =	DESIGNED - KEM	REVISED -
	DRAWN - KEM	REVISED -
PLOT SCALE = 1" = 52'	CHECKED - LSM	REVISED -
PLOT DATE =	DATE 12/6/10	REVISED -



**STATE OF ILLINOIS
DEPARTMENT OF TRANSPORTATION**

**DRAINAGE REMOVAL PLAN
IL RTE 56**

SCALE: 1"=50' SHEET NO. 6 OF 9 SHEETS STA. 393+00.00 TO STA. 423+00.00

F.A.P. RTE. 365	SECTION (57 & 58)WRS-2	COUNTY DUPAGE	TOTAL SHEETS 681	SHEET NO. 257
CONTRACT NO. 62419			ILLINOIS FED. AID PROJECT	