

PLAN	SURVEYED	DATE
	NOTED	
	ALIGNED	
	CHECKED	
	AS BUILT	
	FILE NAME	
	NO.	

PROFILE	SURVEYED	DATE
	NOTED	
	GRADES CHECKED	
	STRUCTURE	
	NOTATIONS CHECKED	
	NO.	

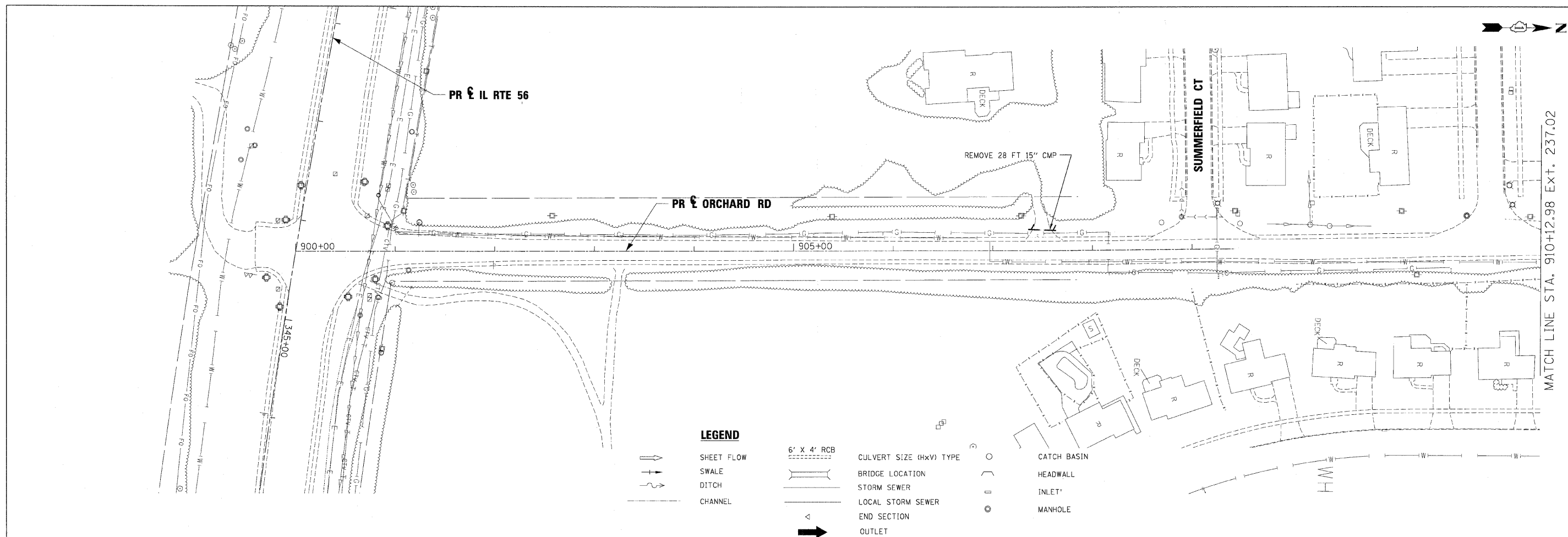

NOTES:

- EXISTING STORM SEWER REMOVAL OR CULVERT REMOVAL WILL NOT BE PAID FOR SEPARATELY WHEN LOCATED WITHIN THE PROPOSED STORM SEWER OR CULVERT TRENCH. THIS WORK TO BE CONSIDERED AS PART OF THE PROPOSED STORM SEWER OR CULVERT INSTALLATION AND WILL NOT BE PAID SEPARATELY.
- STORM SEWER REMOVAL TO BE PAID FOR AS STORM SEWER REMOVAL XX* (PAY ITEM 5510XXXX)

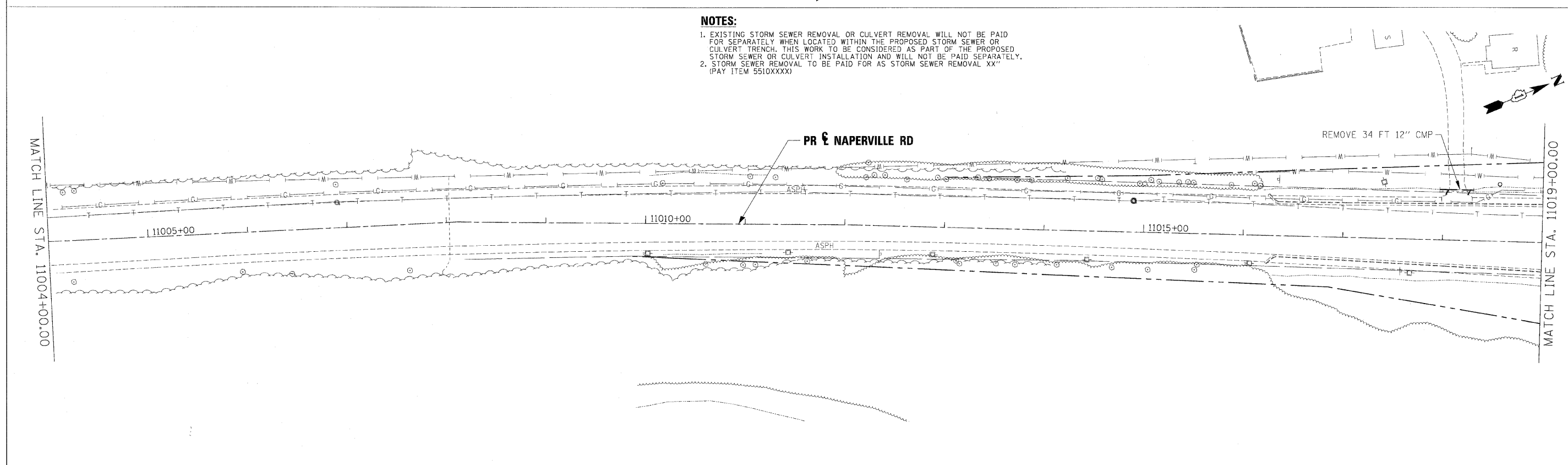

USER NAME =	DESIGNED - KEM	REVISED -
PLLOT SCALE = 1" = 50'	DRAWN - KEM	REVISED -
PLLOT DATE =	CHECKED - LSM	REVISED -
	DATE - 12/6/10	REVISED -



STATE OF ILLINOIS
DEPARTMENT OF TRANSPORTATION

DRAINAGE REMOVAL PLAN	
IL RTE 56	
STA. 900+00.00	TO STA. 910+12.98
SCALE: 1"=50'	SHEET NO. 8 OF 9 SHEETS
STA. 11004+00.00 TO STA. 11019+00.00	

F.A.P. RTE.	SECTION	COUNTY	TOTAL SHEETS	SHEET NO.
365	(57 & 58)WRS-2	DUPAGE	681	259
CONTRACT NO. 62419			ILLINOIS FED. AID PROJECT	