

PLAN	DESIGNED	BY	DATE
NO.	CHECKED		
	NOTED		
	FILED		
	DATE		

PROFILE	DESIGNED	BY	DATE
NO.	CHECKED		
	NOTED		
	FILED		
	DATE		

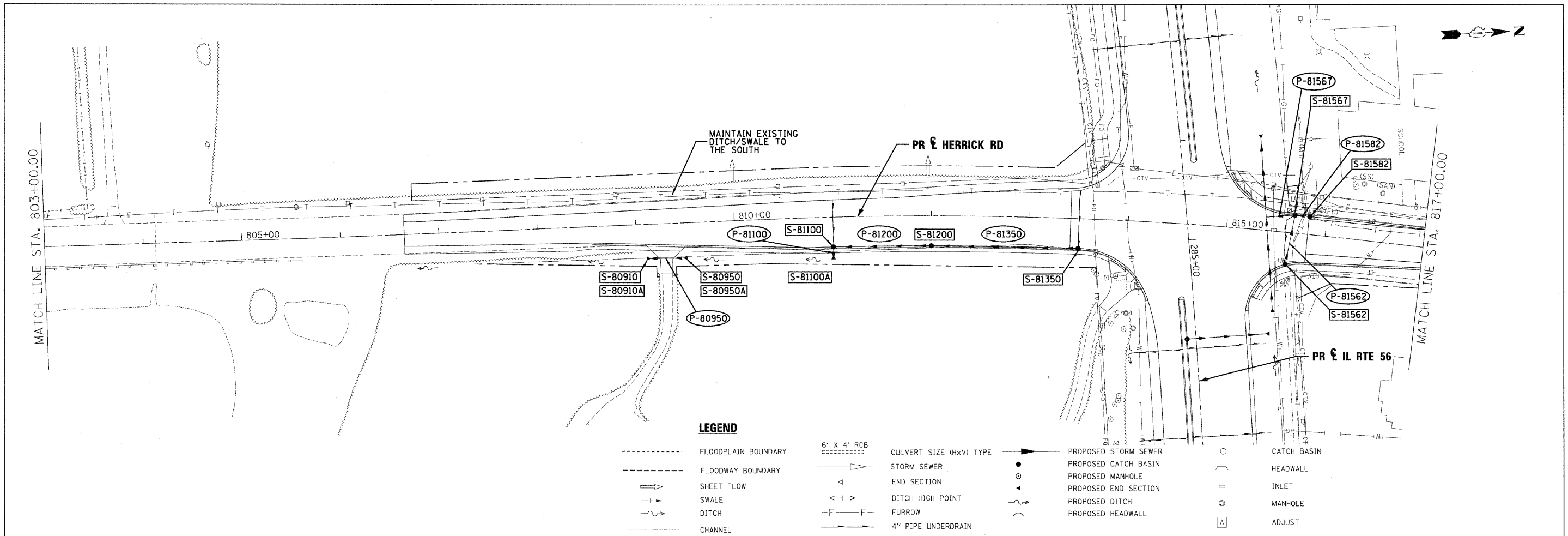

**LEGEND**

- FLOODPLAIN BOUNDARY
- - - FLOODWAY BOUNDARY
- SHEET FLOW
- SWALE
- DITCH
- CHANNEL
- 6' x 4' RCB
- CULVERT SIZE (HxV) TYPE
- STORM SEWER
- △ END SECTION
- ↔ DITCH HIGH POINT
- F-F- FURROW
- 4" PIPE UNDERDRAIN
- PROPOSED STORM SEWER
- PROPOSED CATCH BASIN
- PROPOSED MANHOLE
- PROPOSED END SECTION
- PROPOSED DITCH
- PROPOSED HEADWALL
- CATCH BASIN
- HEADWALL
- INLET
- MANHOLE
- ADJUST

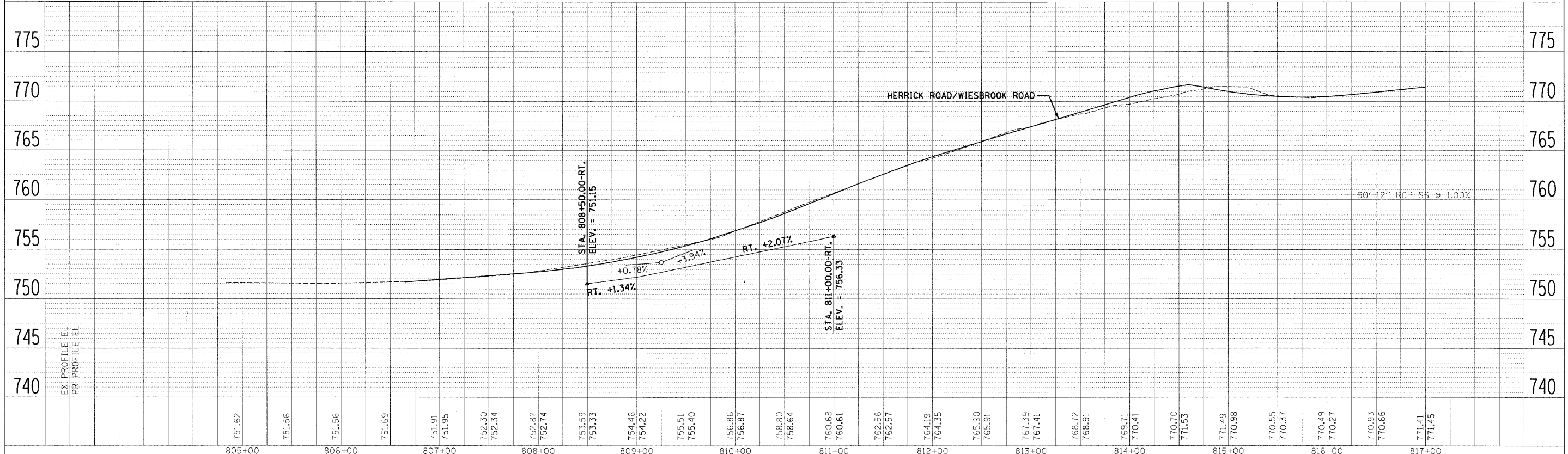

FILE NAME =	DESIGNED - KEM	REVISED -	<b>2im</b>	<b>STATE OF ILLINOIS DEPARTMENT OF TRANSPORTATION</b>	<b>DRAINAGE PLAN AND PROFILE IL RTE 56</b>	F.A.P. RT.:	SECTION	COUNTY	TOTAL SHEETS	SHEET NO.
USER NAME =	DRAWN - KEM	REVISED -				365	(57 & 58)WRS-2	DUPAGE	681	278
PLLOT DATE =	CHECKED - LSM	REVISED -				CONTRACT NO. 62419		ILLINOIS FED. AID PROJECT		
	DATE - 12/6/10	REVISED -				SCALE: 1"=50'		SHEET NO. 13 OF 18 SHEETS		STA. 803+00.00 TO STA. 817+00.00