

PI AN	DATE
DESIGNED	BY
PLOTTED	DATE
CHECKED	DATE
FILE NAME	

PROFILE	DATE
DESIGNED	BY
PLOTTED	DATE
CHECKED	DATE
FILE NAME	

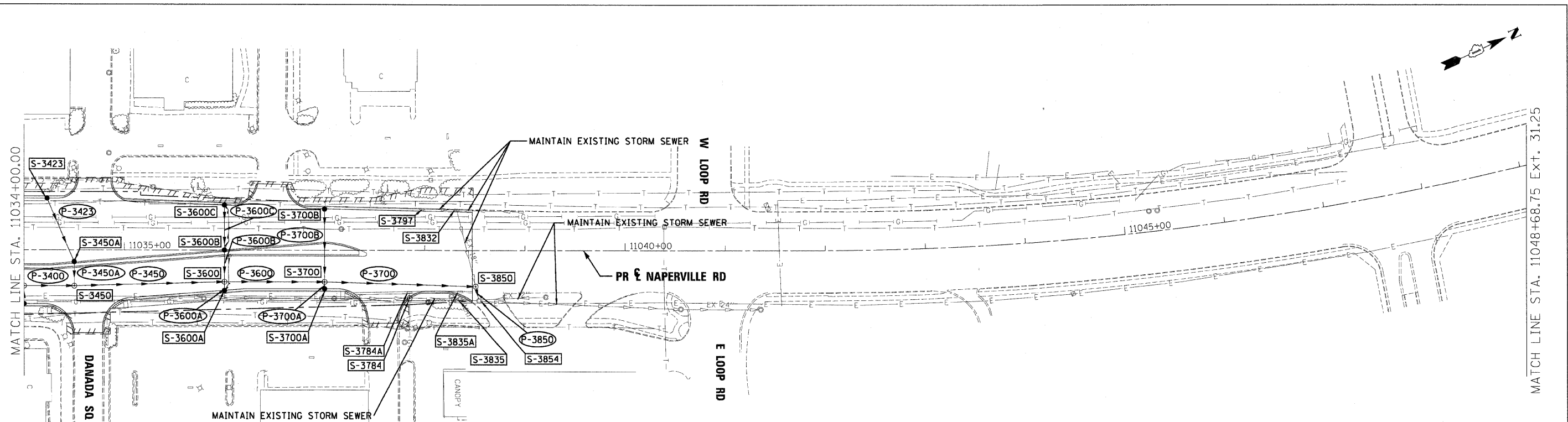

**LEGEND**

- FLOODPLAIN BOUNDARY
- FLOODWAY BOUNDARY
- SHEET FLOW
- SWALE
- DITCH
- CHANNEL
- 6' X 4' RCB
- CULVERT SIZE (HXV) TYPE
- ▽ STORM SEWER
- △ END SECTION
- ↔ DITCH HIGH POINT
- F-F- FURROW
- 4" PIPE UNDERDRAIN
- PROPOSED STORM SEWER
- PROPOSED CATCH BASIN
- PROPOSED MANHOLE
- △ PROPOSED END SECTION
- ~ PROPOSED DITCH
- ∩ PROPOSED HEADWALL
- CATCH BASIN
- ∩ HEADWALL
- INLET
- MANHOLE
- ADJUST

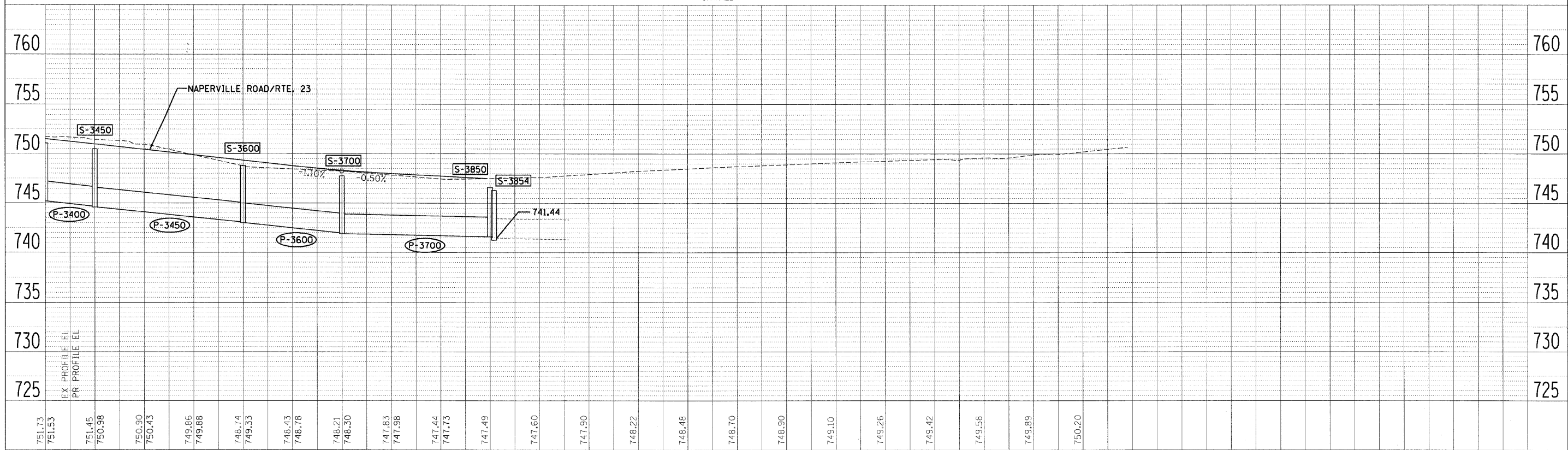

FILE NAME =	DESIGNED - KEM	REvised -		<b>STATE OF ILLINOIS</b> <b>DEPARTMENT OF TRANSPORTATION</b>	<b>DRAINAGE PLAN AND PROFILE</b> <b>IL RTE 56</b>	F.A.P. RTE. 365	SECTION 157 & 581WRS-2	COUNTY DUPAGE	TOTAL SHEETS 681	SHEET NO. 283			
USER NAME =	CHECKED - LSM	REvised -				SCALE: 1"=50'	SHEET NO. 18 OF 18 SHEETS	STA. 11034+00.00 TO STA. 11048+68.75	CONTRACT NO. 62419		ILLINOIS FED. AID PROJECT		
PLOT DATE =	DATE - 12/6/10	REvised -											