

DATE	
BY	
REVISIONS	
NO.	
DATE	
BY	
REVISIONS	
NO.	
DATE	
BY	
REVISIONS	
NO.	

DATE	
BY	
REVISIONS	
NO.	
DATE	
BY	
REVISIONS	
NO.	
DATE	
BY	
REVISIONS	
NO.	

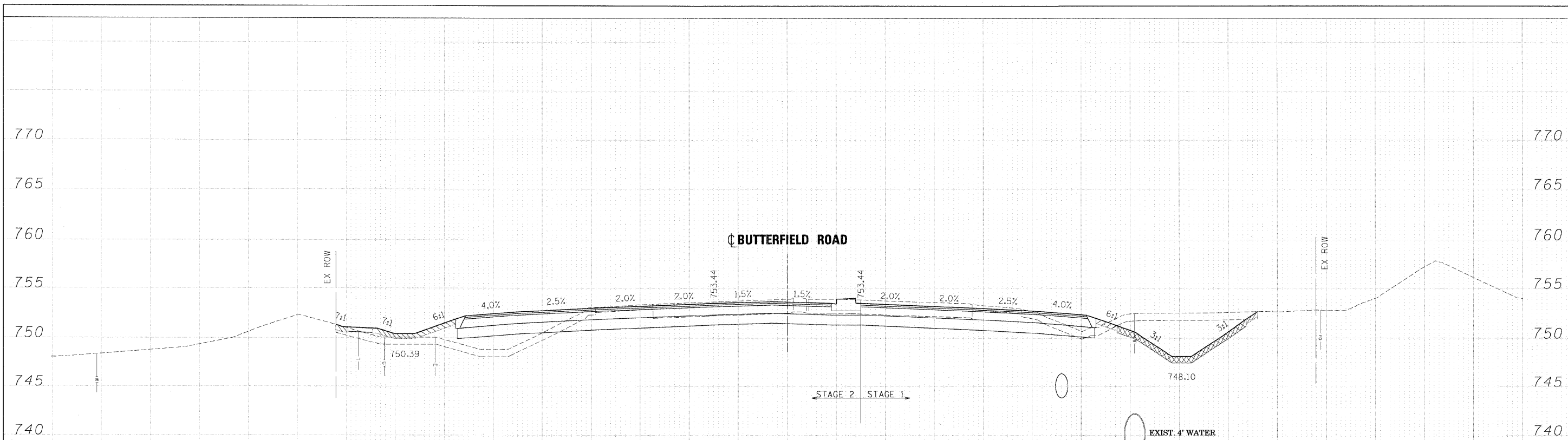

STAGE 2 FILL = 55.7 S.F.  
 STAGE 2 CUT = 78.7 S.F.  
 STAGE 2 TOPSOIL PLACEMENT 6" = 9.7 S.F.  
 STAGE 2 TOPSOIL PLACEMENT 8" = 0.0 S.F.  
 STAGE 2 TOPSOIL PLACEMENT 12" = 0.0 S.F.  
 STAGE 2 TOPSOIL PLACEMENT 24" = 0.0 S.F.  
 STAGE 2 TOPSOIL STRIPPING = 50.4 S.F.

STAGE 1 FILL = 4.3 S.F.  
 STAGE 1 CUT = 127.1 S.F.  
 STAGE 1 TOPSOIL PLACEMENT 6" = 3.3 S.F.  
 STAGE 1 TOPSOIL PLACEMENT 8" = 17.5 S.F.  
 STAGE 1 TOPSOIL STRIPPING = 36.2 S.F.

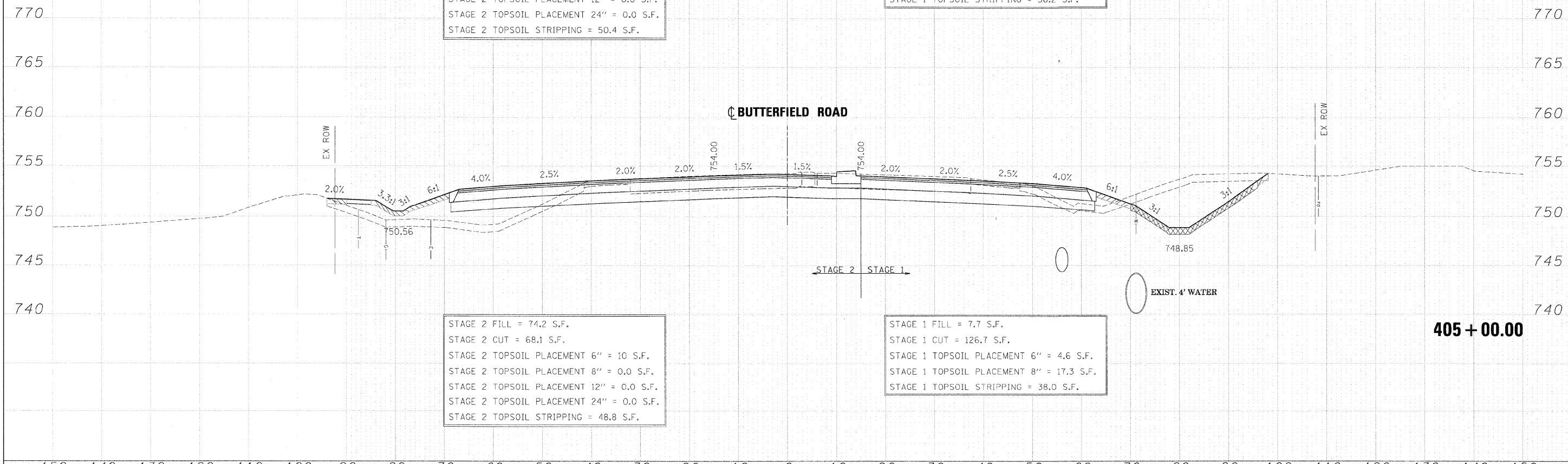

STAGE 2 FILL = 74.2 S.F.  
 STAGE 2 CUT = 68.1 S.F.  
 STAGE 2 TOPSOIL PLACEMENT 6" = 10 S.F.  
 STAGE 2 TOPSOIL PLACEMENT 8" = 0.0 S.F.  
 STAGE 2 TOPSOIL PLACEMENT 12" = 0.0 S.F.  
 STAGE 2 TOPSOIL PLACEMENT 24" = 0.0 S.F.  
 STAGE 2 TOPSOIL STRIPPING = 48.8 S.F.

STAGE 1 FILL = 7.7 S.F.  
 STAGE 1 CUT = 126.7 S.F.  
 STAGE 1 TOPSOIL PLACEMENT 6" = 4.6 S.F.  
 STAGE 1 TOPSOIL PLACEMENT 8" = 17.3 S.F.  
 STAGE 1 TOPSOIL STRIPPING = 38.0 S.F.

FILE NAME =	DESIGNED - JMM	REVISED -	<b>benesch</b>	<b>STATE OF ILLINOIS DEPARTMENT OF TRANSPORTATION</b>	<b>CROSS SECTIONS - IL RTE 56</b>	F.A. RTE.	SECTION	COUNTY	TOTAL SHEETS	SHEET NO.
...ND162419-XS.56.DGN	DRAWN - BMH	REVISED -				365	(57 & 58)WRS-2	DUPAGE	681	612
USER NAME = tblank	CHECKED - RMT	REVISED -				CONTRACT NO. 62419				
DATE = 12/7/2010	DATE - 12/6/10	REVISED -				ILLINOIS FED. AID PROJECT				

SCALE: SHEET NO. 170 OF 189 SHEETS STA. 405+00.00 TO STA. 405+50.00