

DATE	
BY	
SURVEYED	
PLOTTED	
TEMPLATE	
AREAS	
CHECKED	
FINAL SURVEY	
NOTE BOOK	
NO.	

DATE	
BY	
SURVEYED	
PLOTTED	
TEMPLATE	
AREAS	
CHECKED	
ORIGINAL SURVEY	
NOTE BOOK	
NO.	

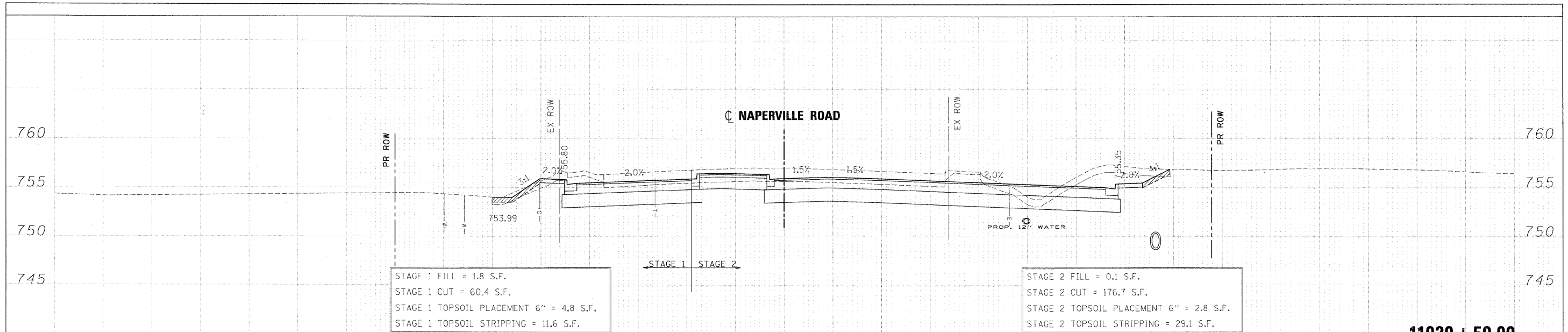

STAGE 1 FILL = 1.8 S.F.
 STAGE 1 CUT = 60.4 S.F.
 STAGE 1 TOPSOIL PLACEMENT 6" = 4.8 S.F.
 STAGE 1 TOPSOIL STRIPPING = 11.6 S.F.

STAGE 2 FILL = 0.1 S.F.
 STAGE 2 CUT = 176.7 S.F.
 STAGE 2 TOPSOIL PLACEMENT 6" = 2.8 S.F.
 STAGE 2 TOPSOIL STRIPPING = 29.1 S.F.

11020 + 50.00

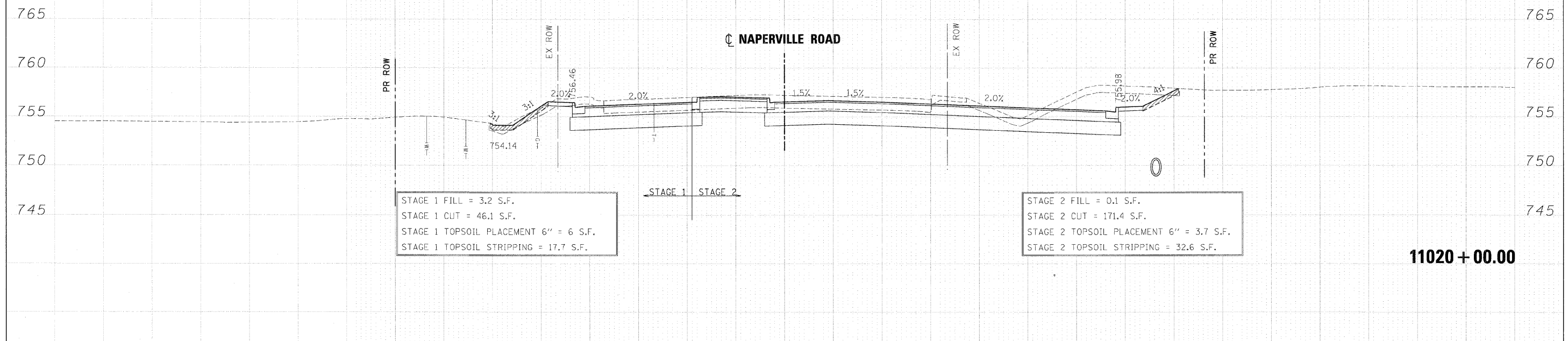

STAGE 1 FILL = 3.2 S.F.
 STAGE 1 CUT = 46.1 S.F.
 STAGE 1 TOPSOIL PLACEMENT 6" = 6 S.F.
 STAGE 1 TOPSOIL STRIPPING = 17.7 S.F.

STAGE 2 FILL = 0.1 S.F.
 STAGE 2 CUT = 171.4 S.F.
 STAGE 2 TOPSOIL PLACEMENT 6" = 3.7 S.F.
 STAGE 2 TOPSOIL STRIPPING = 32.6 S.F.

11020 + 00.00

FILE NAME =	DESIGNED - JMM	REVISED -	benesch	STATE OF ILLINOIS DEPARTMENT OF TRANSPORTATION	CROSS SECTIONS - NAPERVILLE ROAD	F.A. RTE.	SECTION	COUNTY	TOTAL SHEETS	SHEET NO.
... \D162419-XS_Naper.dgn	DRAWN - BMH	REVISED -				365	(57 & 58)WRS-2	DUPAGE	681	664
USER NAME = tblonk	CHECKED - RMT	REVISED -				CONTRACT NO. 62419				
PLOT DATE = 12/7/2010	DATE - 12/6/10	REVISED -				ILLINOIS FED. AID PROJECT				
SCALE:						SHEET NO. 11 OF 28 SHEETS		STA. 11020+00.00 TO STA. 11020+50.00		