

CITY OF WARRENVILLE  
NW 1/4 SECTION 34 - 39 - 9

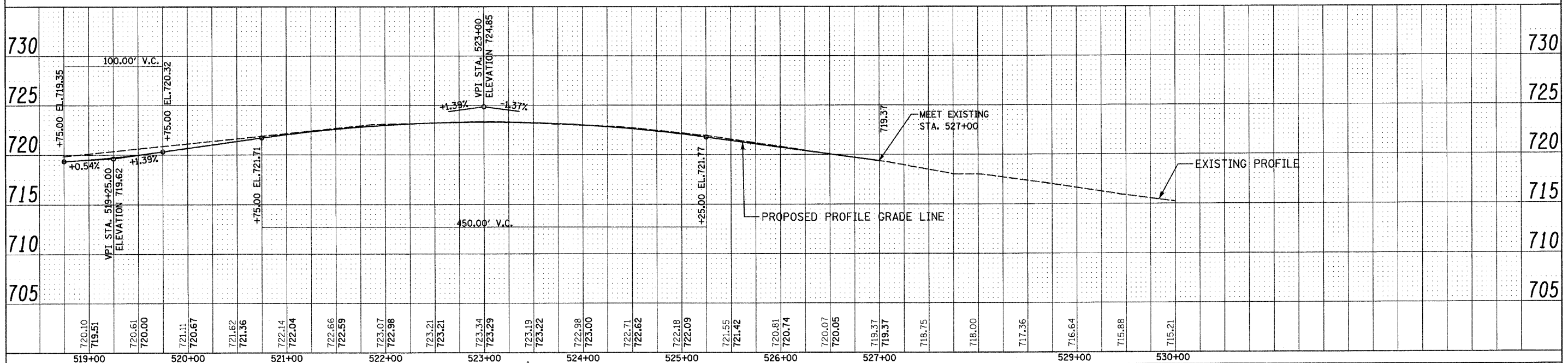
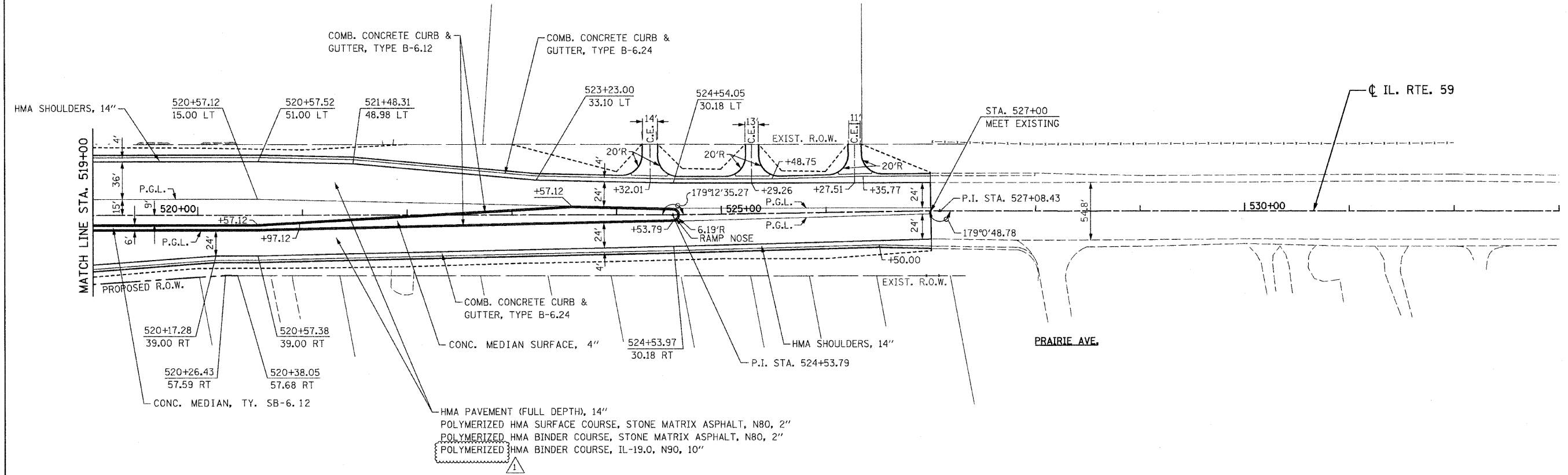

FILE NAME = D:\62420-shr-plnprf592.dgn	<b>CHRISTIAN-ROGE &amp; ASSOCIATES, INC.</b> ENGINEERS-PLANNERS-SURVEYORS 211 WEST WACKER DRIVE CHICAGO, ILLINOIS 60606 PHONE: (312)372-2023 FAX: (312)372-5274	DESIGNED - S.J.P.	REVISED 1 ADDENDUM 1 12-28-2010	<b>STATE OF ILLINOIS</b> <b>DEPARTMENT OF TRANSPORTATION</b>	<b>ROADWAY PLAN AND PROFILE</b> <b>IL. RTE. 59</b>		F.A.P. RTE. 365	SECTION (58&59) WRS-3	COUNTY DuPAGE	TOTAL SHEETS 466	SHEET NO. 103	
PLOT DATE = 12/29/2010		DRAWN - B.K.	REVISED -		SCALE: 1" = 50'		SHEET NO. 2 OF 2 SHEETS	STA. 519+00	TO STA. 527+00	FED. ROAD DIST. NO. 1 (ILLINOIS) FED. AID PROJECT		
PLOT SCALE = 50.000' / 1"		CHECKED - M.P.	REVISED -		CONTRACT NO. 62420							
		DATE - DECEMBER 3, 2010	REVISED -									