

DATE	BY

DATE	BY

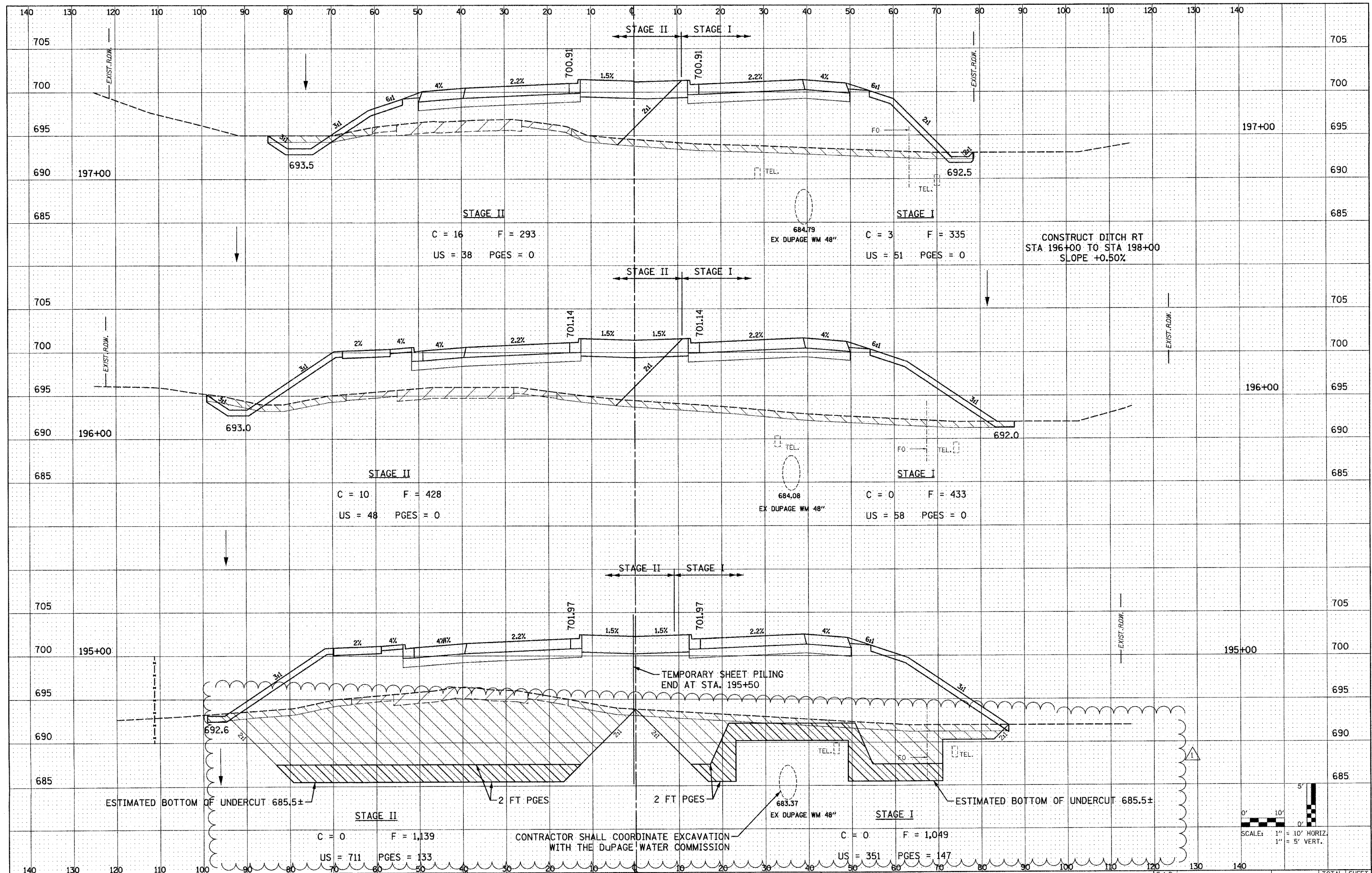

FILE NAME = 0162420-sh1t-xsh1.dgn	CHRISTIAN-ROGE & ASSOCIATES, INC. ENGINEERS-PLANNERS-SURVEYORS 211 WEST WACKER DRIVE CHICAGO, ILLINOIS 60606 PHONE: (312)372-2023 FAX: (312)372-5274	DESIGNED - S.J.P.	REVISED / ADDENDUM 1 12-28-2010	STATE OF ILLINOIS DEPARTMENT OF TRANSPORTATION	CROSS SECTIONS IL. RTE. 56		F.A.P. RTE. 365	SECTION (58&59) WRS-3	COUNTY DuPAGE	TOTAL SHEETS 466	SHEET NO. 383	
PLOT DATE = 12/29/2010		DRAWN - W.A.M.	REVISED -		SCALE: NONE	SHEET NO. 46 OF 74 SHEETS	STA. TO STA.	CONTRACT NO. 62420				
PLOT SCALE = 1/8" = 1' IN.		CHECKED - M.P.	REVISED -		DATE - DECEMBER 3, 2010	REVISED -	FED. ROAD DIST. NO. 1 ILLINOIS FED. AID PROJECT					