

CITY OF WARRENVILLE
NE 1/4 SECTION 33 - 39 - 9

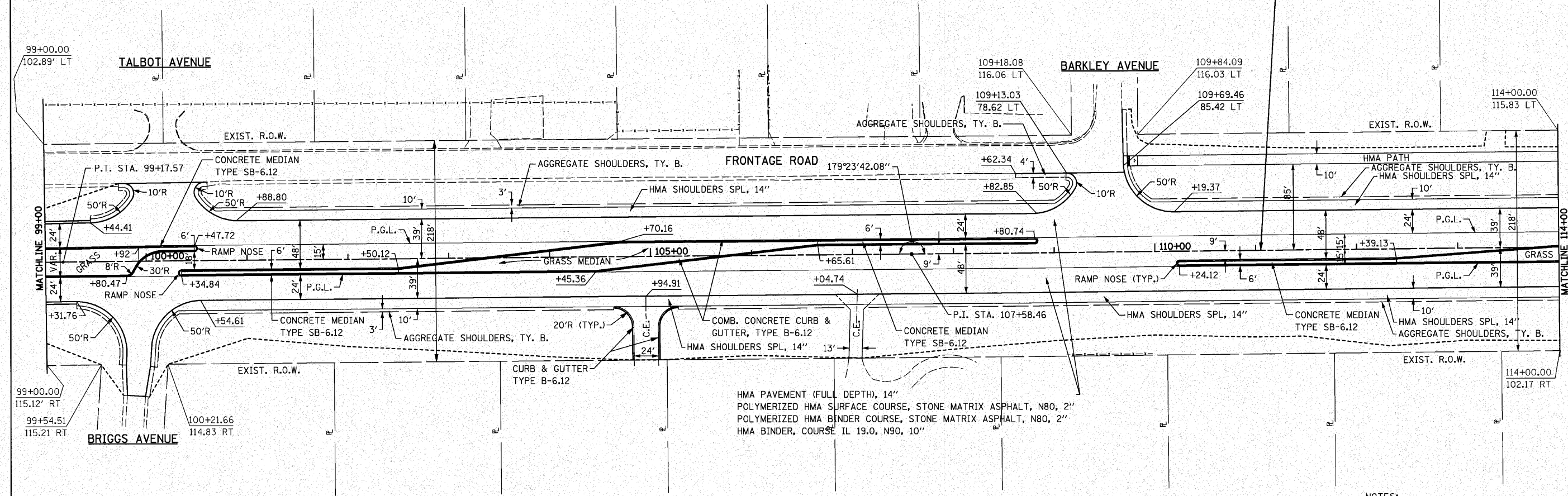

SE 1/4 SECTION 33 - 39 - 9

NOTES:
1. FOR TALBOT AVENUE, BARKLEY AVENUE AND BRIGGS AVENUE INTERSECTIONS, SEE INTERSECTION DETAILS SHEET.

CP 101 ELEV. 730.89
STA. 100+30.88 43.85' RT.
IRON PIPE WITH CAP

CRA 15 ELEV. 723.54
STA. 109+82.02 132.88' LT.
N.W. BOLT ON FIRE HYDRANT

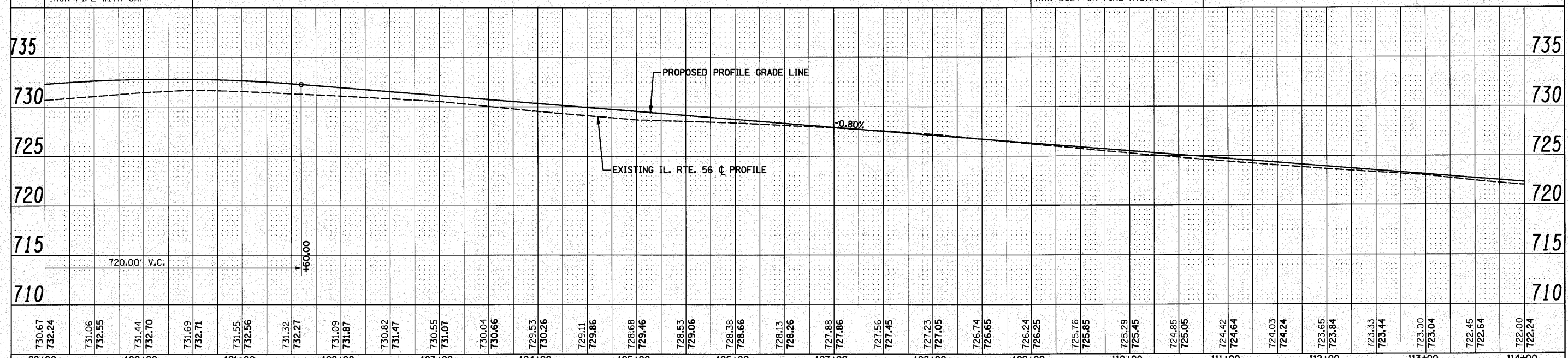

730.67	732.24	731.06	732.55	731.44	732.70	731.69	732.71	731.55	732.56	731.32	732.27	731.09	731.87	730.82	731.47	730.55	731.07	730.04	730.66	729.53	730.26	729.11	729.86	728.68	729.46	728.53	729.06	728.38	728.66	728.13	728.26	727.88	727.86	727.56	727.45	727.23	727.05	726.74	726.65	726.24	726.25	725.76	725.85	725.29	725.45	724.85	725.05	724.42	724.64	724.03	724.24	723.65	723.84	723.33	723.44	723.00	723.04	722.45	722.64	722.00	722.24
99+00	100+00	101+00	102+00	103+00	104+00	105+00	106+00	107+00	108+00	109+00	110+00	111+00	112+00	113+00	114+00																																														

FILE NAME = 0162420-sh-t-plnpr f82.dgn
PLOT DATE = 12/22/2010
PLOT SCALE = 50.000' / IN.

CHRISTIAN-ROGE & ASSOCIATES, INC.
ENGINEERS-PLANNERS-SURVEYORS
211 WEST WACKER DRIVE
CHICAGO, ILLINOIS 60606
PHONE: (312)372-2023 FAX: (312)372-5274

DESIGNED - S.J.P.	REVISED -
DRAWN - B.K.	REVISED -
CHECKED - M.P.	REVISED -
DATE - DECEMBER 3, 2010	REVISED -

STATE OF ILLINOIS
DEPARTMENT OF TRANSPORTATION

ROADWAY PLAN AND PROFILE
IL. RTE. 56
SCALE: 1" = 50' SHEET NO. 2 OF 12 SHEETS STA. 99+00 TO STA. 114+00

F.A.P. RTE. 365	SECTION (58&59) WRS-3	COUNTY DuPAGE	TOTAL SHEETS 466	SHEET NO. 91
FED. ROAD DIST. NO. 1 ILLINOIS FED. AID PROJECT			CONTRACT NO. 62420	