

HMA PAVEMENT (FULL DEPTH), 14"
 POLYMERIZED HMA SURFACE COURSE, STONE MATRIX ASPHALT, N80, 2"
 POLYMERIZED HMA BINDER COURSE, STONE MATRIX ASPHALT, N80, 2"
 HMA BINDER, COURSE IL 19.0, N90, 10"

NW 1/4 SECTION 35 - 39 - 9
 CITY OF WARRENVILLE

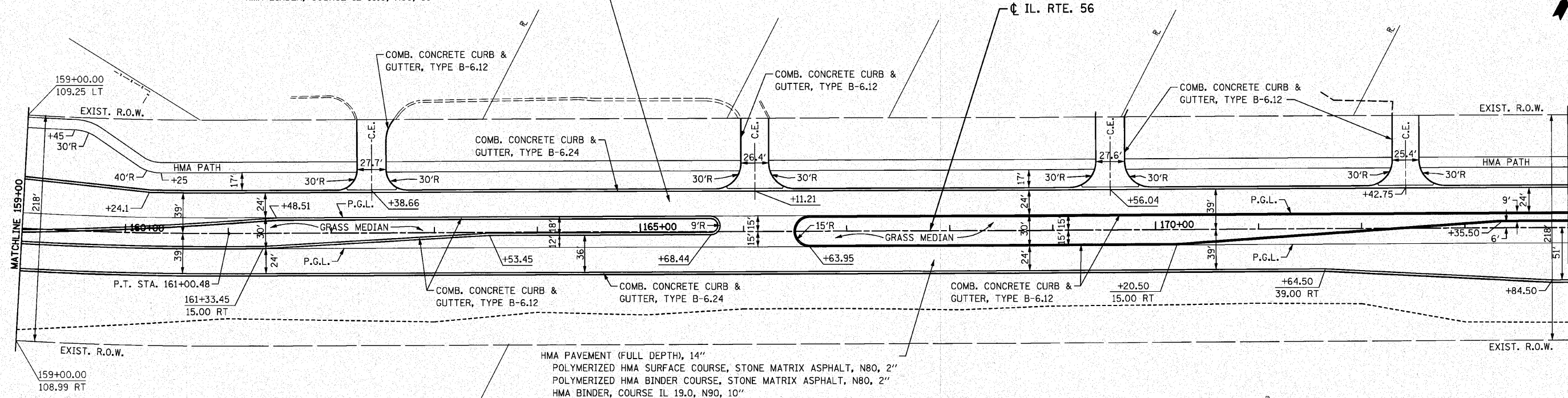

CURVE 2
 PI STA. =152+72.86
 $\Delta = 29^\circ 07' 26''$ (LT)
 $D = 1^\circ 43' 14''$
 $R = 3,330.00'$
 $T = 865.04'$
 $L = 1,692.66'$
 $E = 110.52'$
 $e = 3.14\%$
 $T.R. = 72.61'$
 $S.E. RUN = 114'$
 $P.C. STA. = 144+07.82$
 $P.T. STA. = 161+00.48$

CURVE 2 (LEFT) SUPERELEVATION TRANSITION								
LEFT ELEVATIONS			STATION			RIGHT ELEVATIONS		
EP - 39'	CL PAVT. - 27'	PGL - 15'	X-SLOPE (%)	STATION	X-SLOPE (%)	PGL - 15'	CL PAVT. - 27'	EP - 39'
716.66	717.03	717.41	-3.14	160+82.48	3.14	717.41	717.79	718.16
716.71	717.04	717.38	-2.80	160+75.00	2.80	717.38	717.71	718.05
716.79	717.04	717.29	-2.11	161+00.00	2.11	717.29	717.54	717.80
716.79	717.04	717.29	-2.09	161+00.48	2.09	717.29	717.54	717.79
716.79	717.03	717.27	-2.00	161+03.87	2.00	717.27	717.51	717.75
716.69	716.93	717.17	-2.00	161+25.00	1.42	717.17	717.34	717.51
716.53	716.77	717.01	-2.00	161+50.00	0.73	717.01	717.09	717.18
716.33	716.57	716.81	-2.00	161+75.00	0.04	716.81	716.81	716.82
716.32	716.56	716.80	-2.00	161+76.48	0.00	716.80	716.80	716.80
716.09	716.33	716.57	-2.00	162+00.00	-0.65	716.57	716.50	716.42
715.82	716.06	716.30	-2.00	162+25.00	-1.34	716.30	716.14	715.98
715.52	715.76	716.00	-2.00	162+49.09	-2.00	716.00	715.76	715.52

CRA 18 ELEV. 703.64
 STA. 173+03.39 92.89' LT.
 S. BOLT ON FIRE HYDRANT

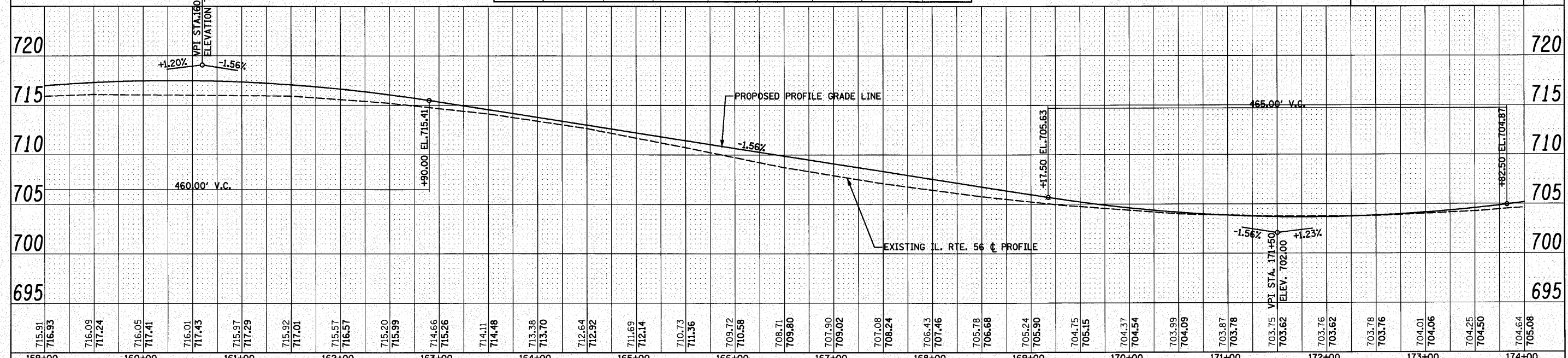

715.91 716.93	716.09 717.24	716.05 717.41	716.01 717.43	715.97 717.29	715.92 717.01	715.57 716.57	715.20 715.99	714.66 715.26	714.11 714.48	713.38 713.70	712.64 712.92	711.69 712.14	710.73 711.36	709.72 710.58	708.71 709.80	707.90 709.02	707.08 708.24	706.43 707.46	705.78 706.68	705.24 705.90	704.75 705.15	704.37 704.54	703.99 704.09	703.87 703.78	703.75 703.62	703.76 703.62	703.78 703.76	704.01 704.06	704.25 704.50	704.64 705.08
159+00	160+00	161+00	162+00	163+00	164+00	165+00	166+00	167+00	168+00	169+00	170+00	171+00	172+00	173+00	174+00															

FILE NAME = D162420-shr-plnr-f06.dgn
 PLOT DATE = 12/2/2010
 PLOT SCALE = 50.000' / IN.

CR
 CHRISTIAN-ROGE & ASSOCIATES, INC.
 ENGINEERS-PLANNERS-SURVEYORS
 211 WEST WACKER DRIVE
 CHICAGO, ILLINOIS 60606
 PHONE: (312)372-2023 FAX: (312)372-5274

DESIGNED - S.J.P.	REVISED -
DRAWN - B.K.	REVISED -
CHECKED - M.P.	REVISED -
DATE - DECEMBER 3, 2010	REVISED -

STATE OF ILLINOIS
 DEPARTMENT OF TRANSPORTATION

ROADWAY PLAN AND PROFILE
 IL. RTE. 56
 SCALE: 1" = 50'
 SHEET NO. 6 OF 12 SHEETS
 STA. 159+00 TO STA. 174+00

F.A.P. RTE. 365	SECTION (58&59) WRS-3	COUNTY DuPAGE	TOTAL SHEETS 466	SHEET NO. 95
CONTRACT NO. 62420			FED. ROAD DIST. NO. 1 ILLINOIS FED. AID PROJECT	