

CITY OF WARRENVILLE
NW 1/4 SECTION 34 - 39 - 9

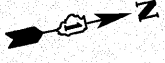

HMA PAVEMENT (FULL DEPTH), 14"
POLYMERIZED HMA SURFACE COURSE, STONE MATRIX ASPHALT, N80, 2"
POLYMERIZED HMA BINDER COURSE, STONE MATRIX ASPHALT, N80, 2"
HMA BINDER, COURSE IL 19.0, N90, 10"

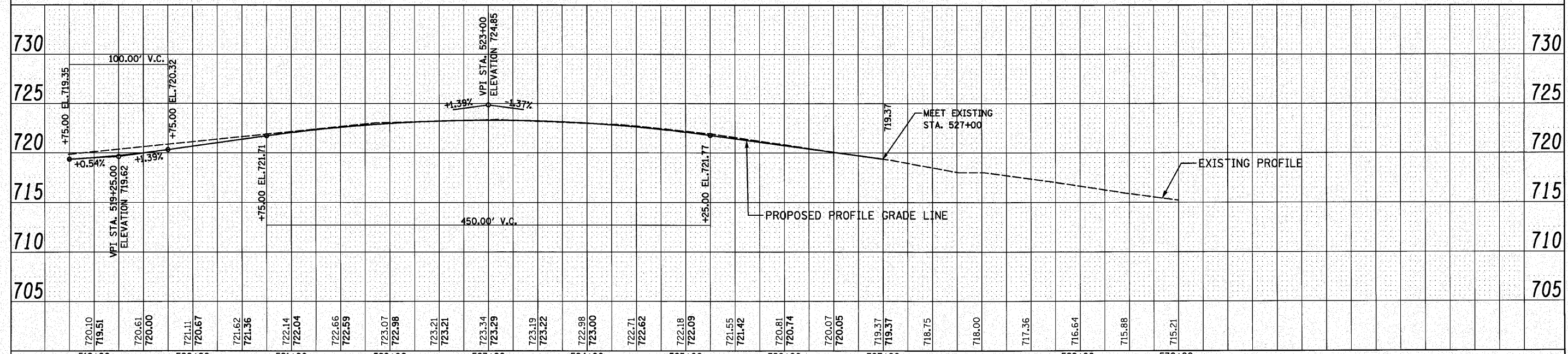
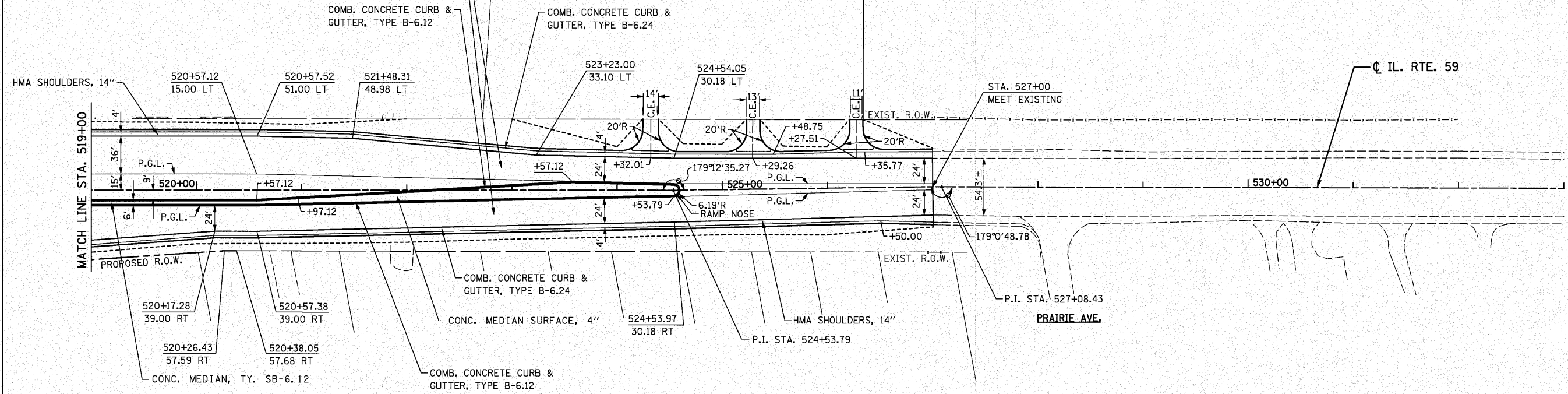

720.10 719.51	720.61 720.00	721.11 720.67	721.62 721.36	722.14 722.04	722.66 722.59	723.07 722.98	723.21 723.21	723.34 723.29	723.19 723.22	722.98 723.00	722.71 722.62	722.18 722.09	721.55 721.42	720.81 720.74	720.07 720.05	719.37 719.37	718.75	718.00	717.36	716.64	715.88	715.21
519+00	520+00	521+00	522+00	523+00	524+00	525+00	526+00	527+00	528+00	529+00	530+00											

FILE NAME = 0162428-shr-plnpr-F592.dgn
PLOT DATE = 12/2/2010
PLOT SCALE = 50.000' / IN.

CHRISTIAN-ROGE & ASSOCIATES, INC.
ENGINEERS-PLANNERS-SURVEYORS
211 WEST WACKER DRIVE
CHICAGO, ILLINOIS 60606
PHONE: (312)372-2023 FAX: (312)372-5274

DESIGNED - S.J.P.	REVISED -
DRAWN - B.K.	REVISED -
CHECKED - M.P.	REVISED -
DATE - DECEMBER 3, 2010	REVISED -

STATE OF ILLINOIS
DEPARTMENT OF TRANSPORTATION

ROADWAY PLAN AND PROFILE
IL. RTE. 59
SCALE: 1" = 50'
SHEET NO. 2 OF 2 SHEETS
STA. 519+00 TO STA. 527+00

F.A.P. RTE. 365	SECTION (58&59) WRS-3	COUNTY DuPAGE	TOTAL SHEETS 466	SHEET NO. 103
FED. ROAD DIST. NO. 1 ILLINOIS FED. AID PROJECT			CONTRACT NO. 62420	