

SW 1/4 SECTION 34 - 39 - 9
CITY OF WARRENVILLE

UNITED STATES POST OFFICE

NOTES:

1. FOR BATAVIA ROAD INTERSECTION, SEE DETAILS AND ELEVATIONS SHEET.

BM 440	ELEV. 708.43
STA. 187+36.27	14.22' LT.
"X" CUT ATOP CURB	

(A) PCC PAVEMENT JT, 10", SPL

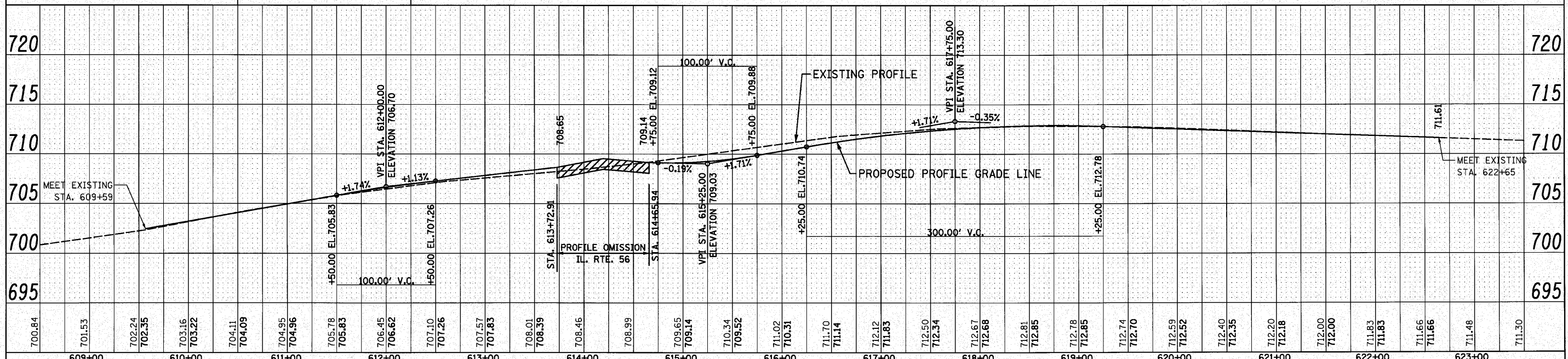

FILE NAME = D:\62420-shr-p\Inprfbat.dgn	DESIGNED - S.J.P.	REVISED -	STATE OF ILLINOIS DEPARTMENT OF TRANSPORTATION	ROADWAY PLAN AND PROFILE BATAVIA ROAD	F.A.P. RT#	SECTION	COUNTY	TOTAL SHEETS	SHEET NO.	
PLOT DATE = 12/2/2010	DRAWN - B.K.	REVISED -			365	(58&59) WRS-3	DUPAGE	466	104	
PLOT SCALE = 50.000' / IN.	CHECKED - M.P.	REVISED -			CONTRACT NO. 62420		FED. ROAD DIST. NO. 1 ILLINOIS FED. AID PROJECT			
CHRISTIAN-ROGE & ASSOCIATES, INC. ENGINEERS-PLANNERS-SURVEYORS 211 WEST WACKER DRIVE CHICAGO, ILLINOIS 60606 PHONE: (312)372-2023 FAX: (312)372-5274	DATE - DECEMBER 3, 2010	REVISED -			SCALE: 1" = 50'	SHEET NO. 1 OF 1 SHEETS	STA. 609+16	TO STA. 622+65		