

176
 STA 611+09, 18' LT
 CB TA 4' TIF OL
 RIM EL 704.76
 INV 701.50

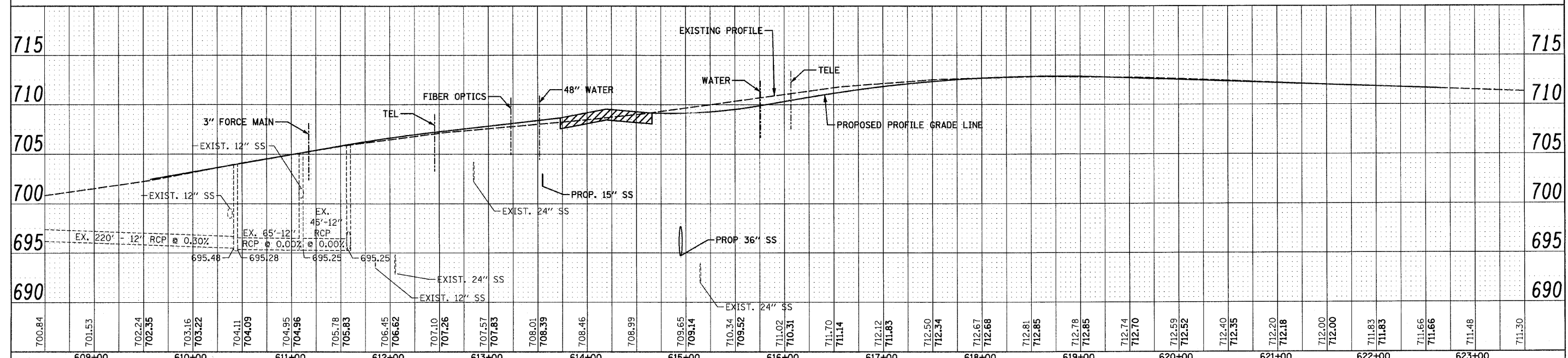

700.84	701.53	702.24	702.35	703.16	703.22	704.11	704.09	704.95	704.96	705.78	705.83	706.45	706.62	707.10	707.26	707.57	707.83	708.01	708.39	708.46	708.99	709.65	709.14	710.34	709.52	711.02	710.31	711.70	711.14	712.12	711.85	712.50	712.34	712.67	712.68	712.81	712.85	712.78	712.85	712.74	712.70	712.59	712.52	712.40	712.35	712.20	712.18	712.00	712.00	711.83	711.83	711.66	711.66	711.48	711.30
609+00	610+00	611+00	612+00	613+00	614+00	615+00	616+00	617+00	618+00	619+00	620+00	621+00	622+00	623+00																																									

FILE NAME = 0162420-shd-drain15bet.dgn
 PLOT DATE = 12/2/2010
 PLOT SCALE = 50.000' / IN.

CHRISTIAN-ROGE & ASSOCIATES, INC.
 ENGINEERS-PLANNERS-SURVEYORS
 211 WEST WACKER DRIVE
 CHICAGO, ILLINOIS 60606
 PHONE: (312)372-2023 FAX: (312)372-5274

DESIGNED - S.J.P.	REVISED -
DRAWN - A.C.S.	REVISED -
CHECKED - M.P.	REVISED -
DATE - DECEMBER 3, 2010	REVISED -

STATE OF ILLINOIS
DEPARTMENT OF TRANSPORTATION

DRAINAGE PLAN AND PROFILE
BATAVIA ROAD
 SCALE: 1" = 50'
 SHEET NO. 1 OF 1 SHEETS
 STA. 609+16 TO STA. 622+65

F.A.P. RTE. 365	SECTION (58&59) WRS-3	COUNTY DuPAGE	TOTAL SHEETS 466	SHEET NO. 149
FED. ROAD DIST. NO. 1 ILLINOIS FED. AID PROJECT			CONTRACT NO. 62420	