

PAVEMENT CORE NO. 8
13" BITUMINOUS
6" PCC

| F.A.P. RTE. | SECTION | COUNTY | TOTAL SHEETS | SHEET NO. |
|---|--------------|----------------|--------------|-----------|
| 353 | (12&13)WRS-4 | WILL | 608 | 62 |
| STA. 525+00 | | TO STA. 539+00 | | |
| FED. ROAD DIST. NO. 1 ILLINOIS FED. AID PROJECT | | | | |

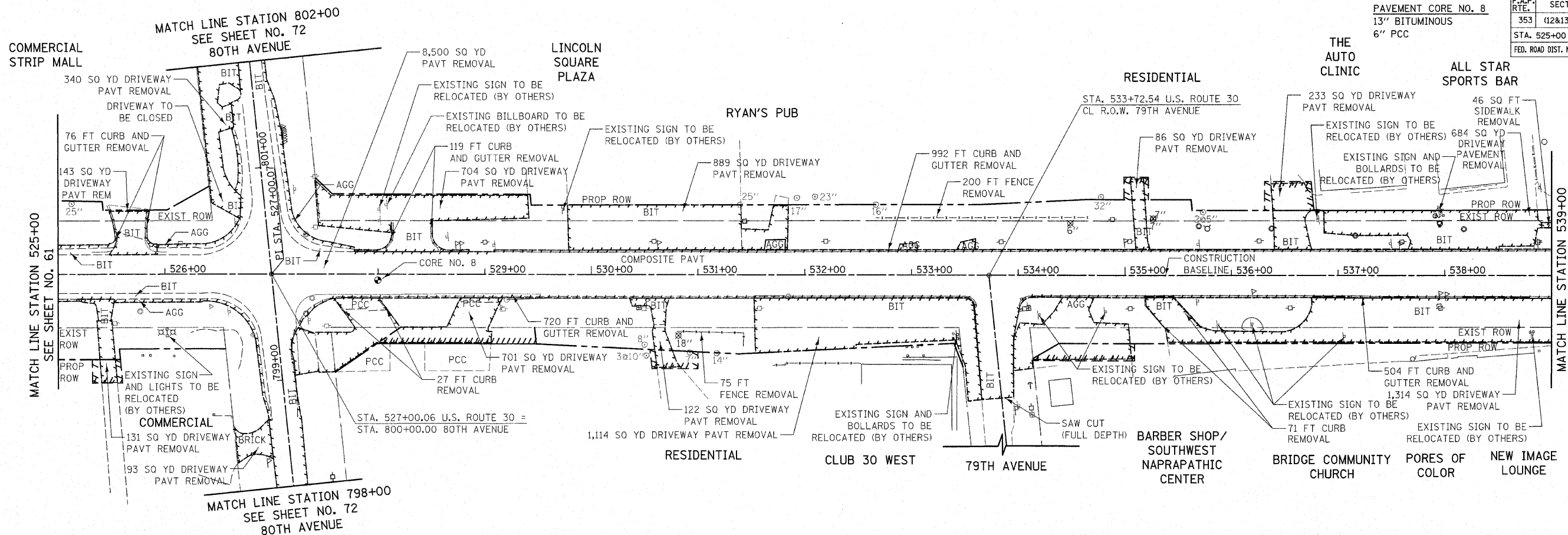

EXISTING U.S. ROUTE 30

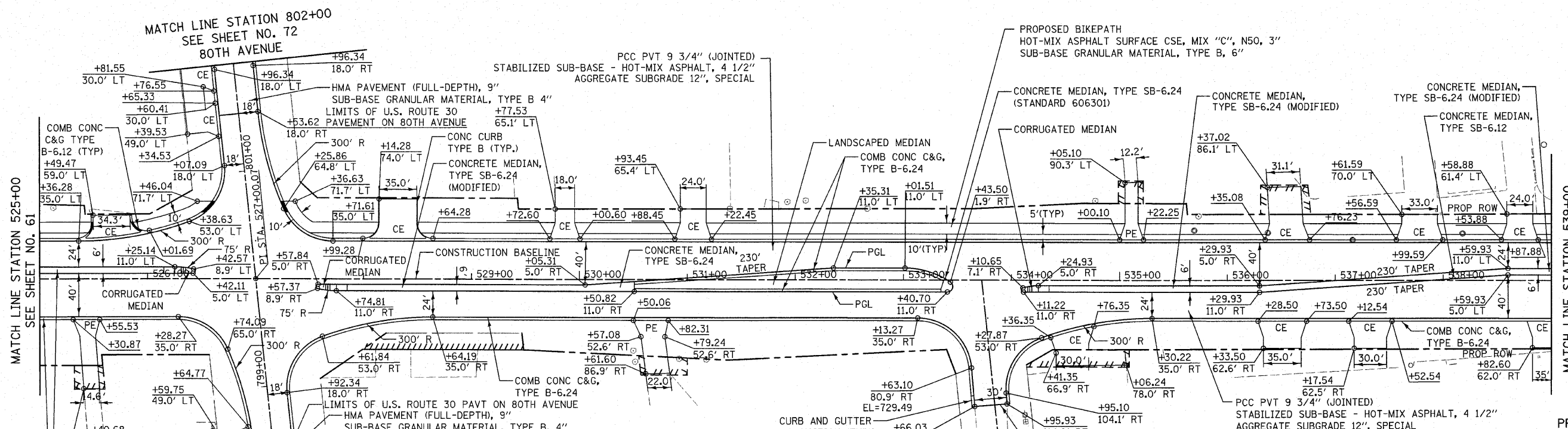

PROPOSED U.S. ROUTE 30

- NOTES:
1. ALL DRIVEWAY RADII SHALL BE 15' UNLESS OTHERWISE NOTED. FOR FLARE RATES AND ADDITIONAL DRIVEWAY DETAILS SEE SHEET 496.
 2. ALL SIDE STREET CORNER RADII SHALL BE 50' UNLESS OTHERWISE NOTED.
 3. FOR CONCRETE MEDIAN DETAILS, SEE SHEET NO. 494.
 4. FOR CURB AND GUTTER TRANSITION DETAILS, SEE SHEET NO. 494.

NOTE:
THE GENERAL CONTRACTOR IS REQUIRED TO HIRE AN ENVIRONMENTAL FIRM WITH AT LEAST FIVE (5) DOCUMENTED LEAKING UNDERGROUND STORAGE TANK (LUST) CLEANUPS OR THAT IS PRE-QUALIFIED IN HAZARDOUS WASTE BY THE DEPARTMENT TO REMEDIATE THE SOIL CONTAMINATION AND MONITOR FOR WORKER PROTECTION.

| REVISIONS | |
|-----------|------|
| NAME | DATE |
| | |
| | |
| | |
| | |
| | |

ILLINOIS DEPARTMENT OF TRANSPORTATION

U.S. ROUTE 30
ROADWAY PLANS

STATION 525+00 TO STATION 539+00

SCALE IN FEET

DATE 6/11/2010

DRAWN BY DJK
CHECKED BY JRV