

F.A.P. RTE.	SECTION	COUNTY	TOTAL SHEETS	SHEET NO.
353	(12&13)WRS-4	WILL	608	115
STA. 975+00		TO STA. 998+00		
FED. ROAD DIST. NO. 1   ILLINOIS   FED. AID PROJECT				

NOTES: SEE SHEET NO. 90-91 FOR DRAINAGE CALL-OFFS.

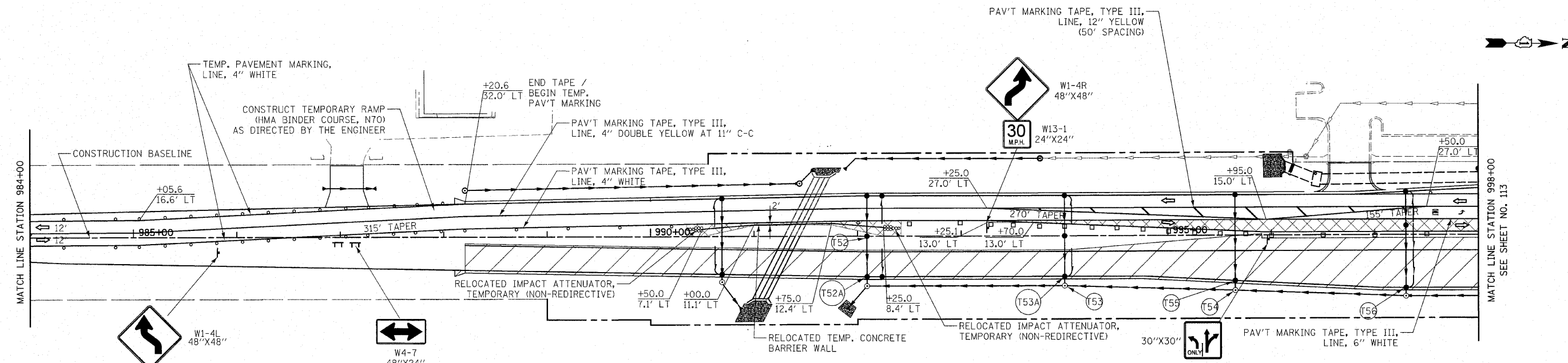
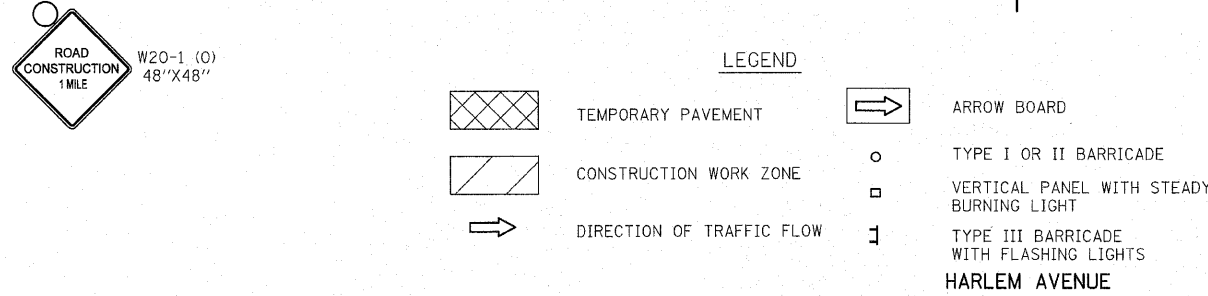
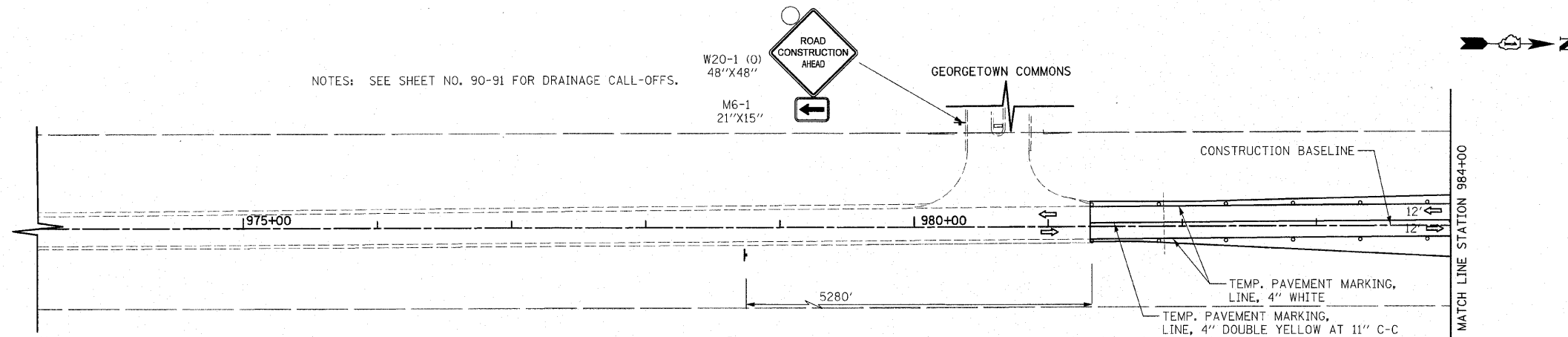

REVISIONS	
NAME	DATE

ILLINOIS DEPARTMENT OF TRANSPORTATION  
 HARLEM AVENUE  
 MAINTENANCE OF TRAFFIC  
 STAGE 2  
 STATION 975+00 TO STATION 998+00  
 SCALE IN FEET  
 DATE 6/11/2010  
 DRAWN BY DJK  
 CHECKED BY JRJ