

F.A.P. RTE.	SECTION	COUNTY	TOTAL SHEETS	SHEET NO.
353	(12&13)WRS-4	WILL	608	122
STA. 435+00		TO STA. 465+00		
FED. ROAD DIST. NO. 1 ILLINOIS FED. AID PROJECT				

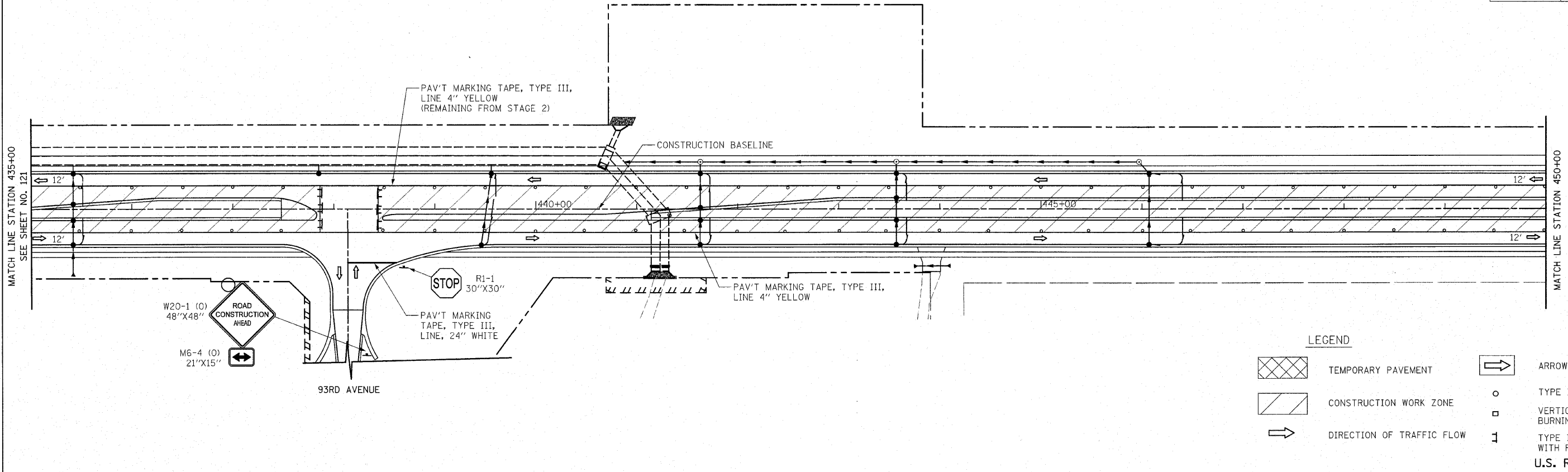

LEGEND

	TEMPORARY PAVEMENT		ARROW BOARD
	CONSTRUCTION WORK ZONE		TYPE I OR II BARRICADE
	DIRECTION OF TRAFFIC FLOW		VERTICAL PANEL WITH STEADY BURNING LIGHT
			TYPE III BARRICADE WITH FLASHING LIGHT

U.S. ROUTE 30

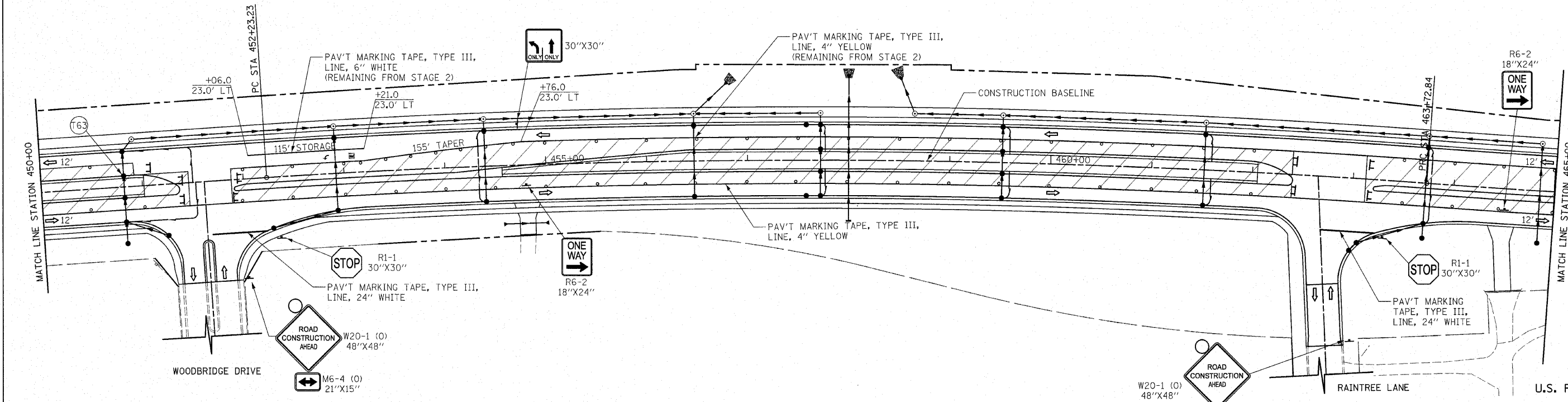

REVISIONS	
NAME	DATE

ILLINOIS DEPARTMENT OF TRANSPORTATION
 U.S. ROUTE 30
 MAINTENANCE OF TRAFFIC
 STAGE 3

STATION 435+00 TO STATION 465+00

50 0 50
 SCALE IN FEET

DATE 6/11/2010

DRAWN BY DJK
 CHECKED BY JRJ