

PART OF THE NW FRAC. 1/4 SEC. 23, S. OF I.B.L. & SW 1/4 FRAC. SECTION 23, T35N, R12E OF THE 3rd PM, FRANKFORT TOWNSHIP, WILL COUNTY, ILLINOIS.

PARCEL NUMBER	OWNER	TOTAL HOLDING ACRES	PART TAKEN ACRES	REMAINDER ACRES	PREV. DED. ACRES	EASEMENT ACRES	EASEMENT PURPOSE	PERMANENT TAX INDEX NUMBER	PROPERTY ACQUIRED BY
1FW0225	VILLAGE OF FRANKFORT	4.995	0.865	4.130				19-09-23-101-001	
1FW0226	CREEKSIDE OF FRANKFORT, LLC	3.699	0.511	3.188	0.279			19-09-23-100-011(PT) & 19-09-23-100-008	
1FW0226TE						0.238	CONSTRUCTION		

COORDINATE VALUE PROJECT COORDINATES ARE SHOWN

NO.	STATION	OFFSET	NORTH	EAST
1709	495+07.22	104.72' RT	N 1,763,319.1162	E 1,124,595.6776
1721	495+54.99	94.10' LT	N 1,763,523.5914	E 1,124,594.5619
411	495+79.00	94.00' LT	N 1,763,529.2343	E 1,124,617.9043
412	496+97.00	88.00' LT	N 1,763,551.5996	E 1,124,733.9207
416	498+13.00	91.00' RT	N 1,763,405.4969	E 1,124,889.3266
1719	498+42.79	75.47' LT	N 1,763,574.2639	E 1,124,878.4797
890	498+90.85	71.34' LT	N 1,763,581.7355	E 1,124,926.1358
549	499+11.19	156.40' LT	N 1,763,669.2040	E 1,124,925.6337
413	499+18.00	69.00' LT	N 1,763,585.9980	E 1,124,953.3228
1720	500+12.77	89.83' LT	N 1,763,627.2403	E 1,125,045.1931
1708	500+14.76	79.77' RT	N 1,763,461.0498	E 1,125,079.1004
84TH AVENUE STATIONING				
550	701+28.00	54.00' LT	N 1,763,669.7608	E 1,125,022.6322
551	702+15.02	42.00' LT	N 1,763,756.8483	E 1,125,034.1324
1661	702+27.25	1.36' RT	N 1,763,769.3288	E 1,125,077.4184
1672	702+27.26	31.64' LT	N 1,763,769.1488	E 1,125,044.4189
892	702+27.26	42.00' LT	N 1,763,769.0923	E 1,125,034.0622
891	702+95.48	31.62' LT	N 1,763,837.3675	E 1,125,044.0467
552	702+95.83	42.00' LT	N 1,763,837.6570	E 1,125,033.6686

CURVE DATA

CENTERLINE EXISTING CONSTRUCTION CURVE NO. 13

Δ = 19°07'11"
D = 02°51'02"
R = 1998.34'
L = 666.85'
T = 336.55'
E = 28.14'

2010 PC STA. 498+67.17
1,763,624.2798 E 1,124,902.8947

9276 PI STA. 502+03.72
1,763,603.9579 E 1,125,229.8799

2009 PT STA. 505+34.02
1,763,572.1392 E 1,125,564.9254

CURVE DATA

CENTERLINE PROPOSED CONSTRUCTION CURVE NO. 4

Δ = 19°14'50"
D = 02°51'53"
R = 2000.00'
L = 671.88'
T = 339.12'
E = 28.15'

516 PC STA. 499+10.27
1,763,517.1004 E 1,124,962.0381

503 PI STA. 502+49.40
1,763,598.1210 E 1,125,291.3415

518 PT STA. 505+82.13
1,763,566.0593 E 1,125,628.9465

LEGEND

- SECTION CORNER (Symbol)
- QUARTER SECTION CORNER (Symbol)
- SECTION LINE (Symbol)
- QUARTER SECTION LINE (Symbol)
- QUARTER SECTION LINE (Symbol)
- PLATTED LOT LINE (Symbol)
- PROPERTY (DEED) LINE (Symbol)
- APL APPARENT PROPERTY LINE (Symbol)
- CENTERLINE (Symbol)
- EXISTING RIGHT OF WAY LINE (Symbol)
- PROPOSED RIGHT OF WAY LINE (Symbol)
- PROPOSED EASEMENT (Symbol)
- EXISTING ACCESS CONTROL LINE (Symbol)
- PROPOSED ACCESS CONTROL LINE (Symbol)
- MEASURED DIMENSION METRIC WITH IMPERIAL RECORD DATA (Symbol)
- MEASURED DIMENSION METRIC WITH IMPERIAL RECORD DATA (Symbol)
- EXISTING BUILDING (Symbol)
- IRON PIPE OR ROD FOUND (Symbol)
- CUT CROSS FOUND OR SET (Symbol)
- SET 5/8" x 30" REBAR (Symbol)
- FOUND PK NAIL (Symbol)
- SET PK NAIL (Symbol)
- T1 THESE STAKES REFERENCE FOUND OR SET MONUMENTATION (Symbol)
- T2 SET 5/8 INCH REBAR FLUSH WITH GROUND TO THE FOUND IRON STAKE, IDENTIFIED BY COLORED PLASTIC CAP AND BEARING SURVEYORS PROFESSIONAL NUMBER. (Symbol)
- T3 BY COLORED PLASTIC CAP AND BEARING SURVEYORS PROFESSIONAL NUMBER. (Symbol)
- BT1 THESE STAKES, IN CULTIVATED AREAS, REFERENCE FOUND OR SET MONUMENTATION. BT2 BURIED 5/8 INCH REBAR 20 INCHES BELOW GROUND TO THE FOUND IRON STAKE. BT3 IDENTIFIED BY COLORED PLASTIC CAP BEARING SURVEYORS PROFESSIONAL NUMBER. (Symbol)
- STAKING OF PROPOSED RIGHT OF WAY. SET DIVISION OF HIGHWAYS SURVEY MARKER TO MONUMENT THE POSITION SHOWN. IDENTIFIED BY INSCRIPTION DATA AND SURVEYORS PROFESSIONAL NUMBER. (Symbol)
- STAKING OF PROPOSED RIGHT OF WAY IN CULTIVATED AREAS. BURIED 5/8 INCH REBAR 20 INCHES BELOW GROUND TO MARK FUTURE SURVEY MARKER POSITION. IDENTIFIED BY COLORED PLASTIC CAP BEARING SURVEYORS PROFESSIONAL NUMBER. (Symbol)
- PERMANENT SURVEY MARKER, IDOT STD. 2135 (TO BE SET BY OTHERS) (Symbol)
- RIGHT OF WAY STAKING PROPOSED TO BE SET. (Symbol)

STATE OF ILLINOIS)
COUNTY OF WILL) SS

THIS IS TO CERTIFY THAT WE, CLAASSEN, WHITE & ASSOCIATES, P.C., AN ILLINOIS PROFESSIONAL DESIGN FIRM LAND SURVEYING CORPORATION NUMBER 04-004039, HAVE SURVEYED THE PLAT OF HIGHWAYS SHOWN HEREON BETWEEN SECTION 22, TOWNSHIP 35 NORTH, RANGE 12 EAST, AND SECTION 23, TOWNSHIP 35 NORTH, RANGE 12 EAST OF THE THIRD PRINCIPAL MERIDIAN, WILL COUNTY, THAT THE SURVEY IS TRUE AND COMPLETE AS SHOWN TO THE BEST OF MY KNOWLEDGE AND BELIEF, THAT THE PLAT CORRECTLY REPRESENTS SAID SURVEY, THAT ALL MONUMENTS FOUND AND ESTABLISHED ARE OF PERMANENT QUALITY AND OCCUPY THE POSITIONS SHOWN THEREON AND THAT THE MONUMENTS ARE SUFFICIENT TO ENABLE THE SURVEY TO BE RETRACED. THIS SURVEY CONFORMS TO THE CURRENT ILLINOIS MINIMUM STANDARDS FOR A BOUNDARY SURVEY. MADE FOR THE DEPARTMENT OF TRANSPORTATION, STATE OF ILLINOIS.

DATED AT JOLIET, ILLINOIS THIS _____ DAY OF _____, 2009 A.D.

DAVID A. CLAASSEN VICE PRESIDENT
ILLINOIS PROFESSIONAL LAND SURVEYOR NO. 035-002962
LICENSE EXPIRES NOVEMBER 30, 2010
THIS PROFESSIONAL SERVICE CONFORMS TO THE CURRENT ILLINOIS MINIMUM STANDARDS FOR A BOUNDARY SURVEY.
Claassen, White & Associates, P.C.
121 AIRPORT DRIVE, UNIT 1
JOLIET, ILLINOIS 60431
(815) 744-3720

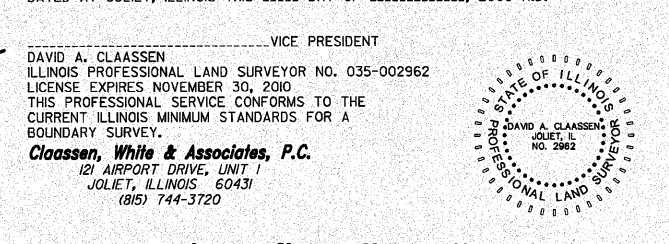

- NOTES:
- EXISTING CENTERLINE OF U.S. ROUTE 30 PER PLAT OF CENTERLINE BY RUETTIGER, TONELLI & ASSOCIATES, INC. PREPARED FOR THE ILLINOIS DEPARTMENT OF TRANSPORTATION, DATED JUNE 2nd, 2001, I.D.O.T. JOB NUMBER R-91-016-01.
 - COORDINATES LISTED ARE PROJECT COORDINATES AND CAN BE CONVERTED TO ILLINOIS STATE PLANE EAST ZONE, NAD 83 (2007) BY MULTIPLYING LISTED VALUES BY 0.999964.

RECEIVED
AUG 25 2009

PLATS & LEGALS

PLAT OF HIGHWAYS
STATE OF ILLINOIS
DEPARTMENT OF TRANSPORTATION
F.A.P. 353 US ROUTE 30 (LINCOLN HIGHWAY)

SECTION US 45 TO STA. 515+83 WILL COUNTY
PROJECT JOB NO. R-91-016-01
STATION 496+00 TO STATION 501+50
SCALE: 1" = 30' SHEET C12 OF C35

BUREAU OF LAND ACQUISITION
201 WEST CENTER COURT
SCHAUMBURG, ILLINOIS 60196-1096

PRINTING DATE: AUGUST 24, 2009 - JLS MicroStation/Sheet C12 RldgP