

F.A.P. RTE.	SECTION	COUNTY	TOTAL SHEETS	SHEET NO.
353	(12&13)WRS-4	WILL	608	307
STA.		TO STA.		
FED. ROAD DIST. NO. 1		ILLINOIS		
		FED. AID PROJECT		



HARLEM AVENUE

U.S. ROUTE 30

HARLEM AVENUE

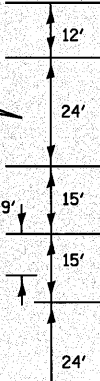
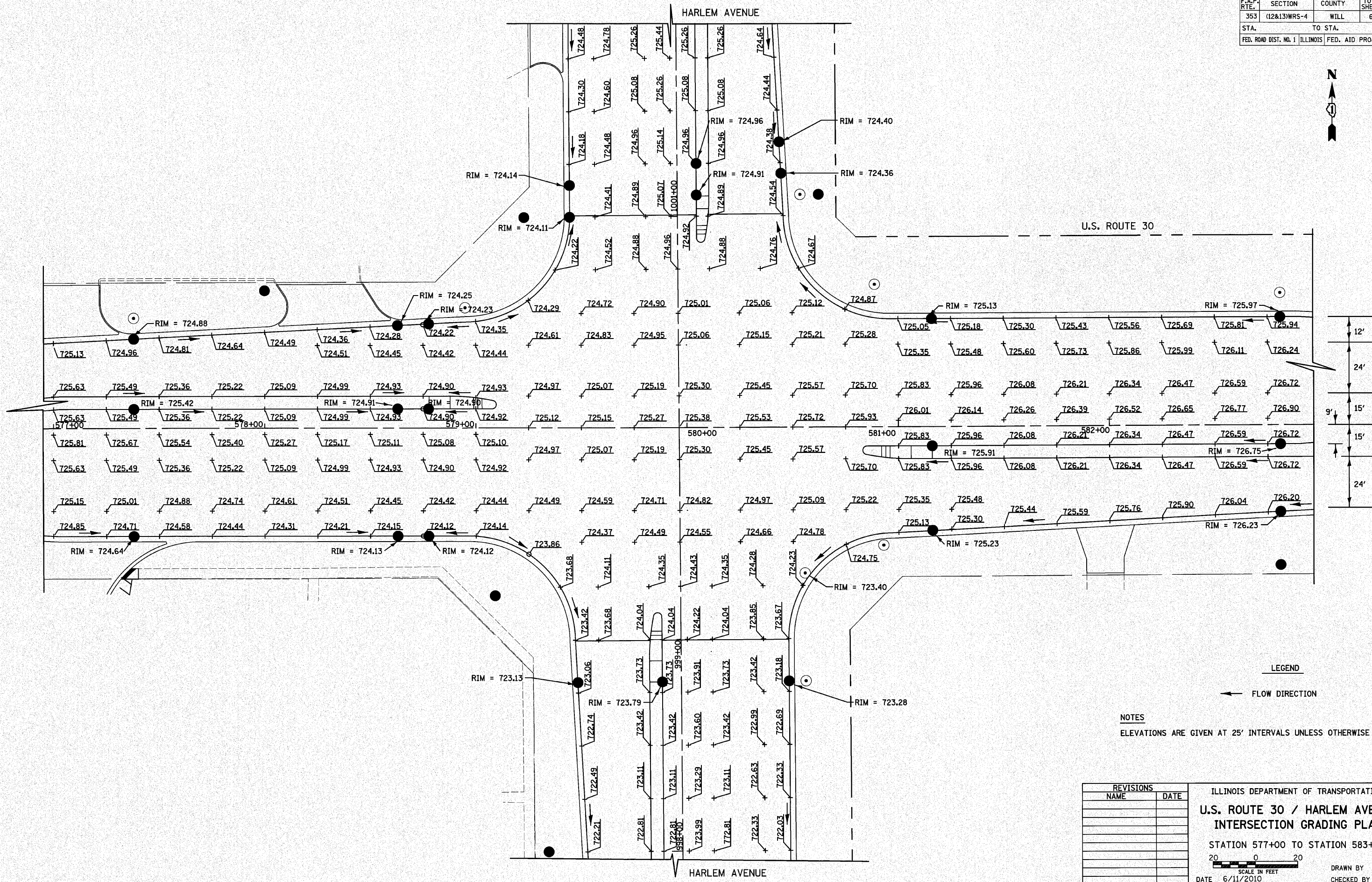

LEGEND

← FLOW DIRECTION

NOTES

ELEVATIONS ARE GIVEN AT 25' INTERVALS UNLESS OTHERWISE NOTED.

REVISIONS	
NAME	DATE

ILLINOIS DEPARTMENT OF TRANSPORTATION
U.S. ROUTE 30 / HARLEM AVENUE
INTERSECTION GRADING PLAN
 STATION 577+00 TO STATION 583+00

SCALE IN FEET
 DATE 6/11/2010

DRAWN BY DJK
 CHECKED BY JRV