

F.A.P. RTE.	SECTION	COUNTY	TOTAL SHEETS	SHEET NO.
353	(12&13)WRS-4	WILL	608	393
STA.		TO STA.		
FED. ROAD DIST. NO. 1		ILLINOIS	FED. AID PROJECT	
CONTRACT NO. 62478				

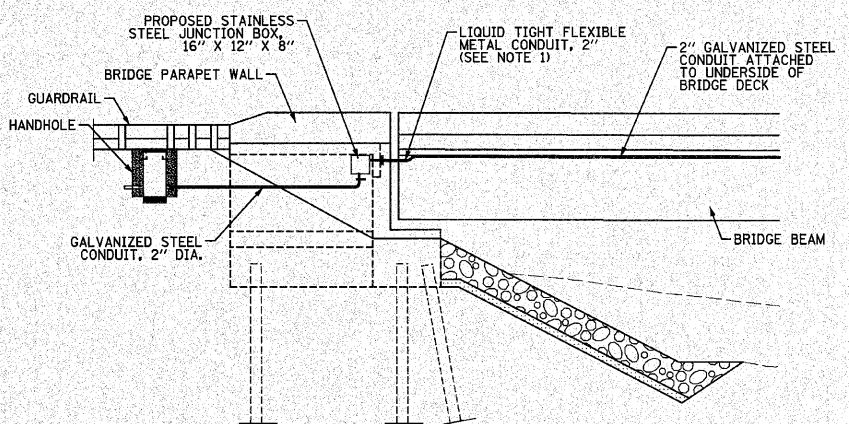
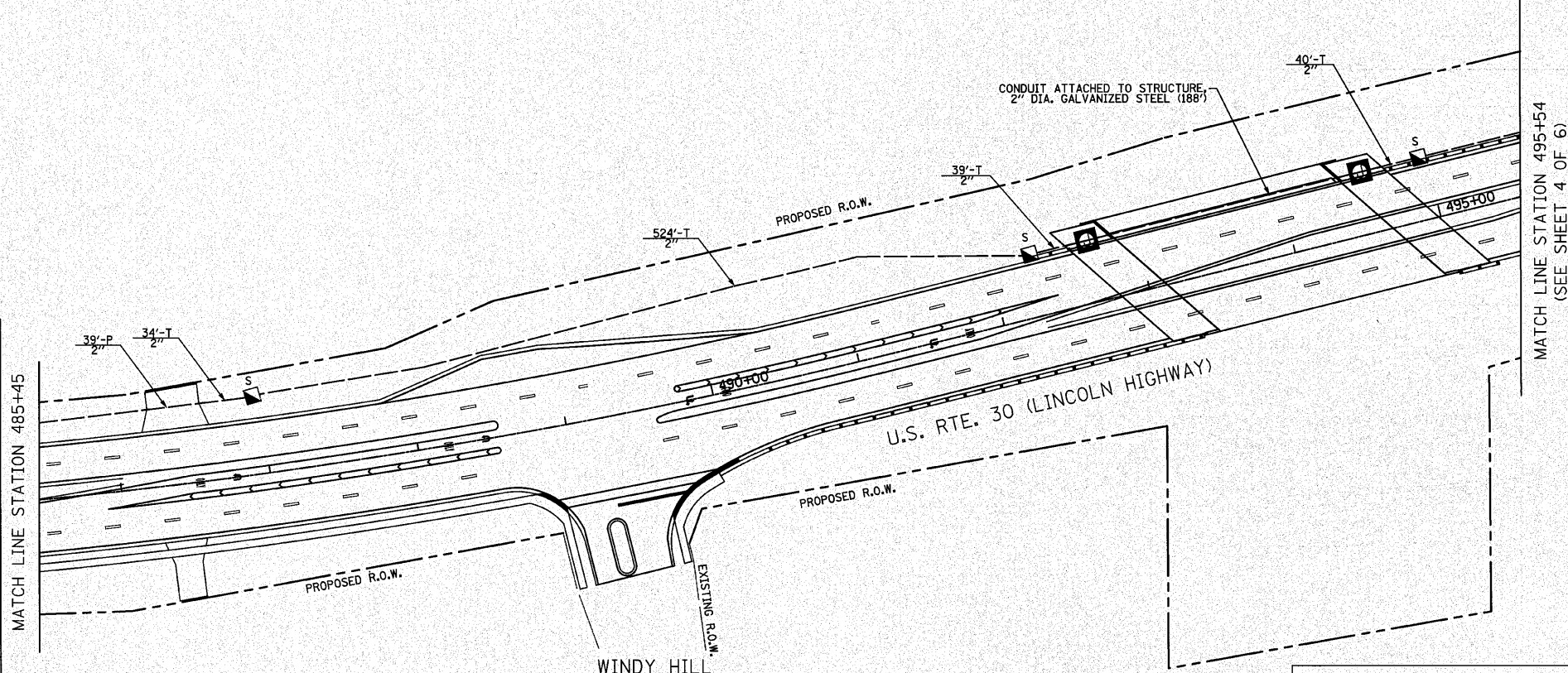
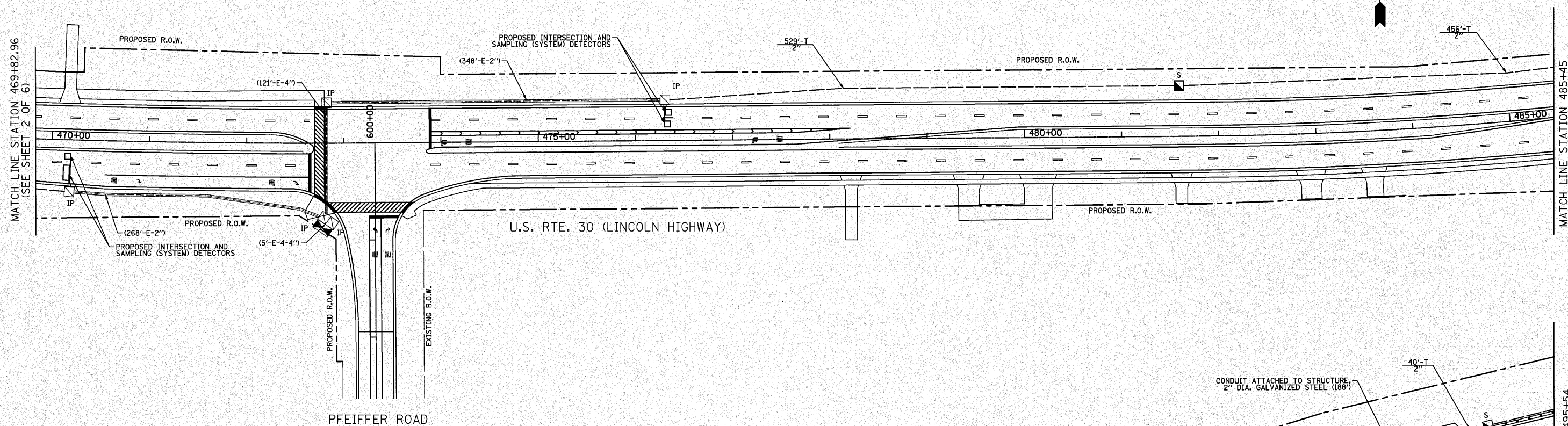

NOTE:
 1. THE LIQUID TIGHT FLEXIBLE METAL CONDUIT SHALL BE INCIDENTAL TO THE PAY ITEM "2" GALVANIZED STEEL CONDUIT ATTACHED TO STRUCTURE".
 2. NO HOLES SHALL BE DRILLED IN BRIDGE BEAMS FOR INSTALLATION OF CONDUIT OR JUNCTION BOXES.

INTERCONNECT DETAIL
JUNCTION BOX AND CONDUIT INSTALLATION
 (NOT TO SCALE)

RESTORATION OF WORK AREA.
 RESTORATION OF THE TRAFFIC SIGNAL WORK AREA SHALL BE INCIDENTAL TO THE RELATED PAY ITEM SUCH AS FOUNDATION, CONDUIT, HANDHOLE, TRENCH AND BACKFILL, ETC., AND NO EXTRA COMPENSATION SHALL BE ALLOWED. ALL ROADWAY SURFACES SUCH AS SHOULDER, MEDIAN, SIDEWALKS, PAVEMENT, ETC. SHALL BE REPLACED IN KIND. ALL DAMAGE TO MOWED LAWNS SHALL BE REPLACED WITH AN APPROVED SALT TOLERANT SOD, AND ALL DAMAGE TO UNMOWED FIELDS SHALL BE SEEDED IN ACCORDANCE WITH STANDARD SPECIFICATIONS 252 AND 250 RESPECTIVELY.

NOTE:
 THE TRAFFIC SIGNAL CONTROLLER EQUIPMENT FOR THIS PROJECT SHALL BE "ECONOLITE" TO MATCH THE EXISTING ADJACENT SYSTEM.

REVISIONS	
NAME	DATE

ILLINOIS DEPARTMENT OF TRANSPORTATION
TRAFFIC SIGNAL INTERCONNECT PLAN
 (SHEET 3 OF 6)
 U.S. RTE. 30 (LINCOLN HWY.)
 U.S. RTE. 45 (96th AVENUE) TO
 ILL. RTE. 43 (HARLEM AV.)

SCALE IN FEET
 50 0 50
 DATE 6/11/2010

DRAWN BY OJT
 DESIGNED BY BRD
 CHECKED BY JUE