

STATE OF ILLINOIS
DEPARTMENT OF TRANSPORTATION

ROUTE NO.	SECTION	COUNTY	TOTAL SHEETS	SHEET NO.	SHEET NO.
353	(12&13)WRS-4	Will	608	441	23 SHEETS
FED. ROAD DIST. NO. 7		ILLINOIS	FED. AID PROJECT-		Contract No. 62478

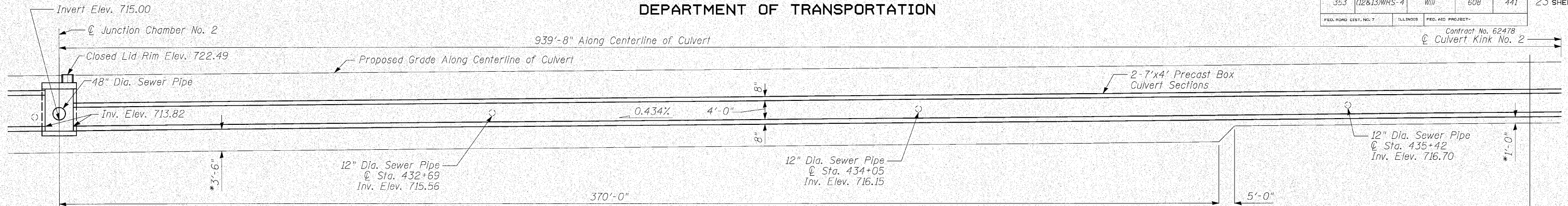

LONGITUDINAL SECTION

*Limits of Removal of Unsuitable Material and Limits of Porous Granular Embankment, Subgrade

Note:
1. See Sheet 4 for Section A-A.

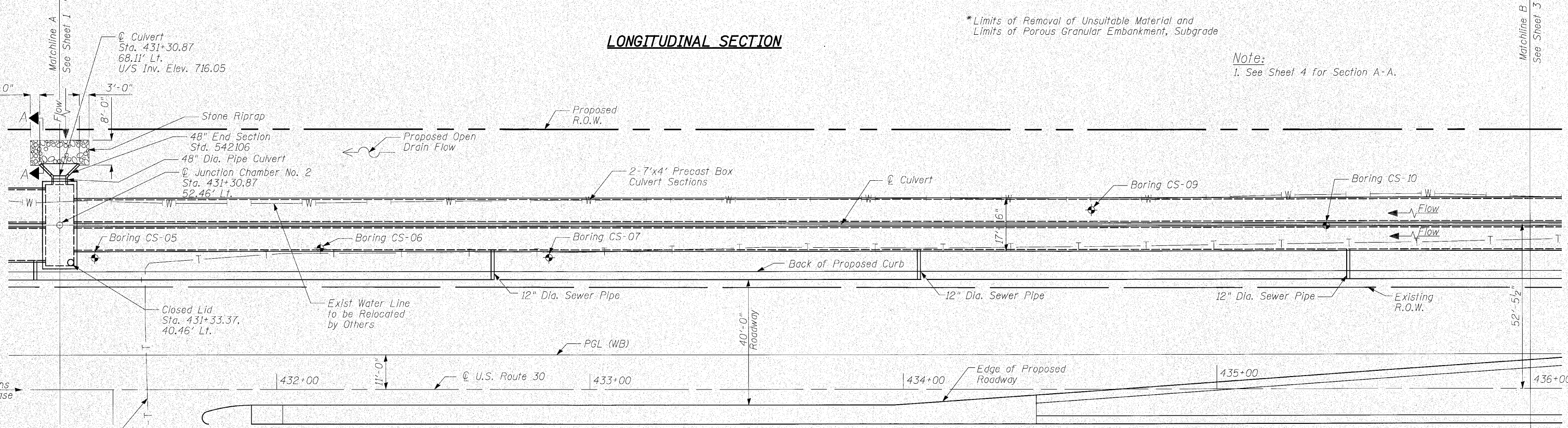

PLAN

GENERAL NOTES

- Precast concrete box culvert sections shall conform to the requirements of Article 540.06 of the Standard Specifications and the applicable requirements of either AASHTO M259 or M273 as applicable.
- Lifting holes shall be filled with concrete plugs and mastic after box sections are in place.
- Reinforcement bars shall conform to the requirements of ASTM A 706 Grade 60. See Special Provisions.
- All construction joints of cast-in-place concrete elements shall be bonded.
- Plan dimensions and details relative to existing plans are subject to nominal construction variations. The Contractor shall field verify existing dimensions and details affecting new construction and make necessary approved adjustments prior to construction or ordering of materials. Such variations shall not be cause for additional compensation for a change in the scope of the work, however, the Contractor will be paid for the quantity actually furnished at the unit price for the work.
- The limits and quantities of removal and replacement shown are based on the boring data and may be modified by the District Geotechnical and Field Engineers for variable subsurface conditions encountered in the field.
- All Junction Chambers to have Type I Frame and Closed Lid (Standard 604001) unless noted otherwise. Cost of Frame and Lid is included with cost of Junction Chamber.

ABBREVIATIONS

℄	centerline
C.I.P.	cast-in-place
CMP	corrugated metal pipe
cts.	centers
dia.	diameter
EB	Eastbound
E.F.	each face
Elev.	elevation
I.F.	inside face
Inv.	invert
Lt.	left
O.F.	outside face
PGL	profile grade line
R.O.W.	right-of-way
Rt.	right
Sta.	station
typ.	typical
WB	Westbound

DESIGN SPECIFICATIONS

2002 AASHTO

LOADING HS20-44

Allow 50#/sq.ft. for future wearing surface

DESIGN STRESSES

FIELD UNITS

$f'_c = 3,500$ psi
 $f_y = 60,000$ psi (reinforcement)

PRECAST UNITS

$f'_c = 5,000$ psi
 $f_y = 65,000$ psi (Welded Wire Fabric)

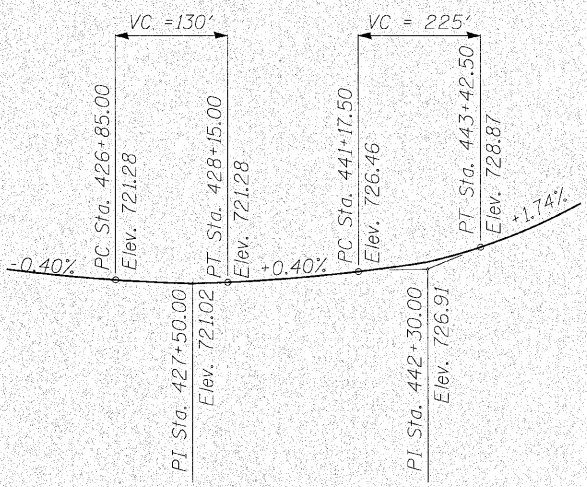

PROFILE GRADE

(Along the Edge of a Lane Measured Normal to the ℄ U.S. Route 30)

DESIGNED	MT
CHECKED	RB
DRAWN	JHP
CHECKED	SPK

PARTIAL GENERAL PLAN (2 OF 4)
U.S. ROUTE 30 OVER
HICKORY CREEK TRIBUTARY 1
F.A.P. ROUTE 353 SEC. (12&13)WRS-4
WILL COUNTY
STATION 441+23.00
STRUCTURE NO. 099-4626

INFRASTRUCTURE ENGINEERING INCORPORATED
33 West Monroe | Suite 1540 | Chicago, IL 60603
P 312.425.9560 | F 312.425.9564 | www.infrastructure-eng.com