

F.A.P. RTE.	SECTION	COUNTY	TOTAL SHEETS	SHEET NO.
353	(12&13)WRS-3	WILL	1235	86
STA. 161+00		TO STA. 174+00		
FED. ROAD DIST. NO.	ILLINOIS	FED. AID PROJECT		
CONTRACT NO. 62479				

PROP. CURVE CLUS30-1
 PI STA. = 169+77.15
 $\Delta = 15^\circ 53' 35''$ (RT)
 $D = 1^\circ 59' 59''$
 $R = 2,865.00'$
 $T = 399.92'$
 $L = 794.71'$
 $E = 27.78'$
 P.C. STA. = 165+77.23
 P.T. STA. = 173+71.94
 $e = 0.0272$

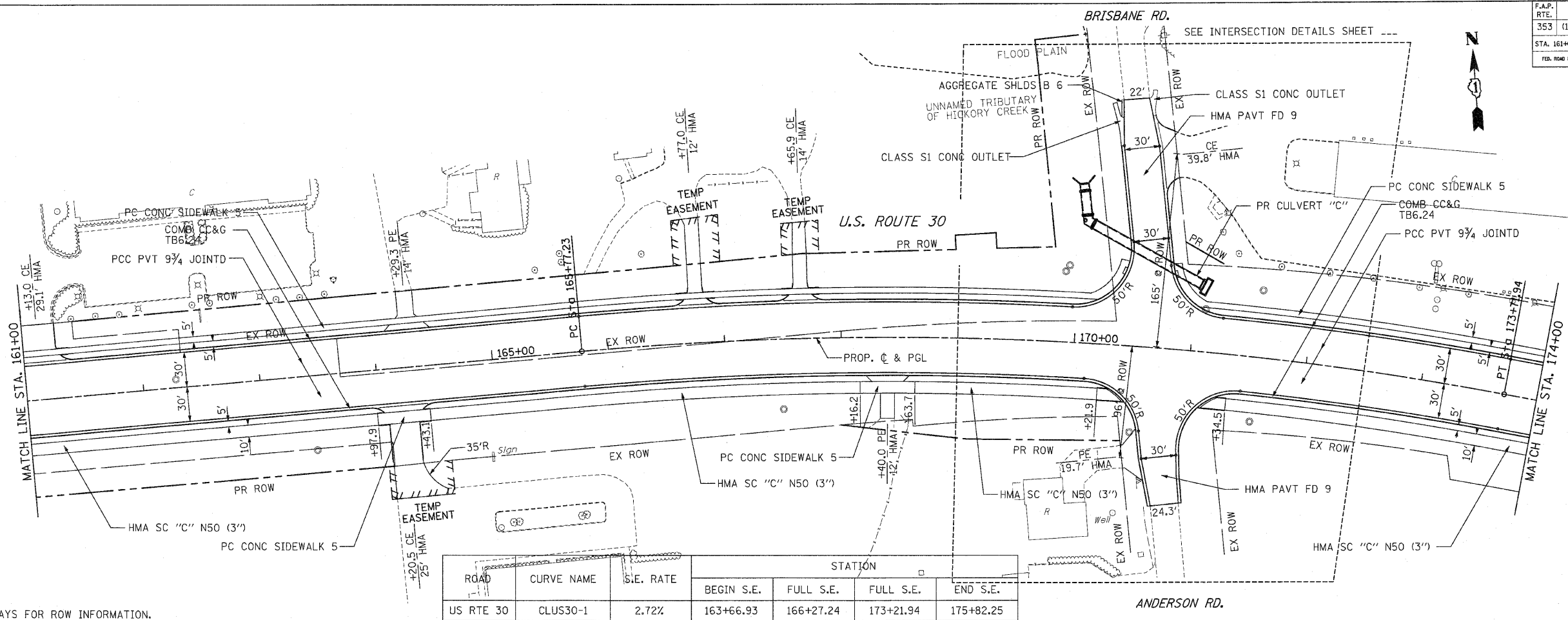

ROAD	CURVE NAME	S.I.E. RATE	STATION			
			BEGIN S.E.	FULL S.E.	FULL S.E.	END S.E.
US RTE 30	CLUS30-1	2.72%	163+66.93	166+27.24	173+21.94	175+82.25

NOTE: SEE PLAT OF HIGHWAYS FOR ROW INFORMATION.

