

| | | | | |
|---------------------|--------------|------------------|--------------|----------|
| F.A.P. RTE. | SECTION | COUNTY | TOTAL SHEETS | SHEET NO |
| 353 | (12&13)WRS-3 | WILL | 1235 | 116 |
| STA. | TO STA. | | | |
| FED. ROAD DIST. NO. | ILLINOIS | FED. AID PROJECT | | |

CONTRACT NO. 62479

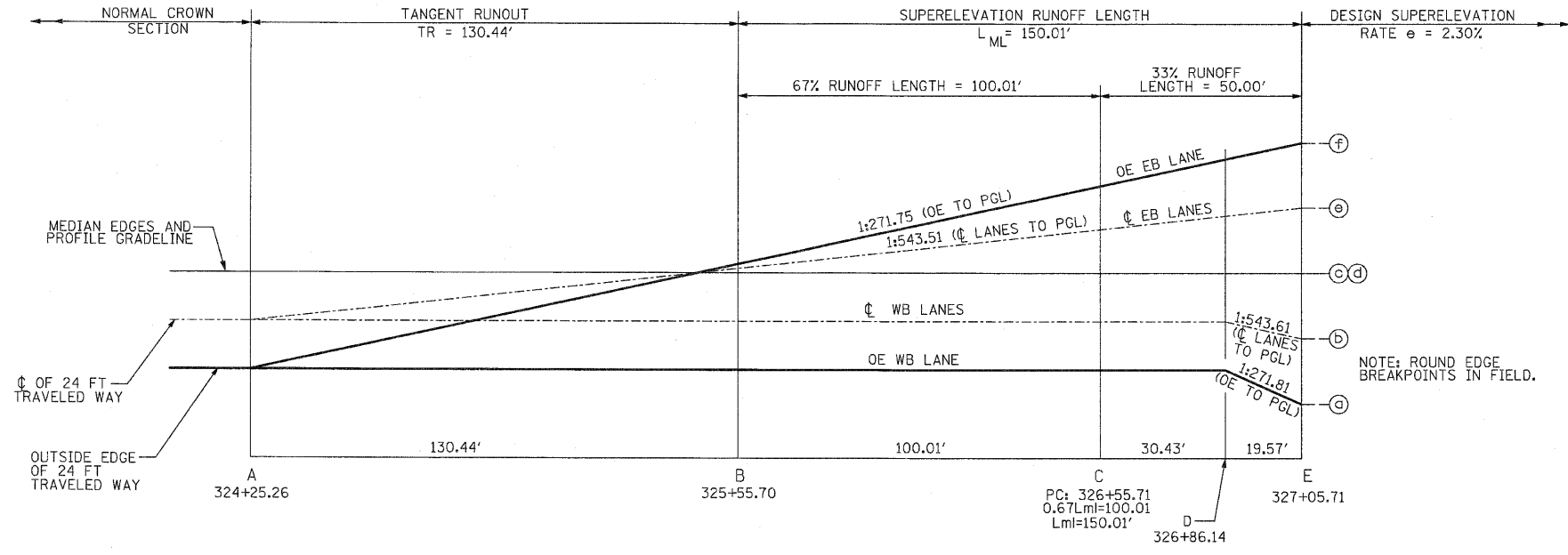

CLUS 30-6
DIVIDED HIGHWAY SECTION

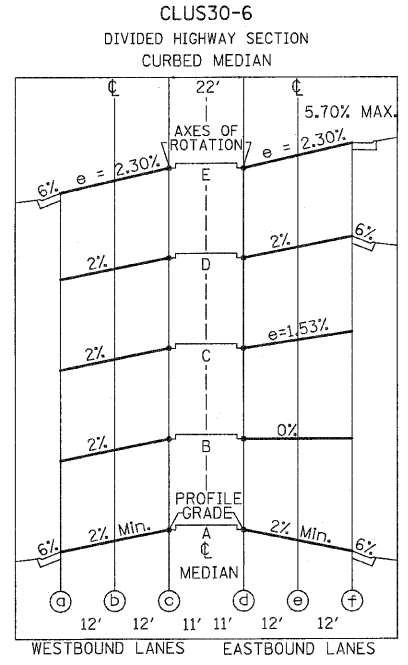

CLUS30-6 TO CLUS30-7
TRANSITION
DIVIDED HIGHWAY SECTION
CURBED MEDIAN

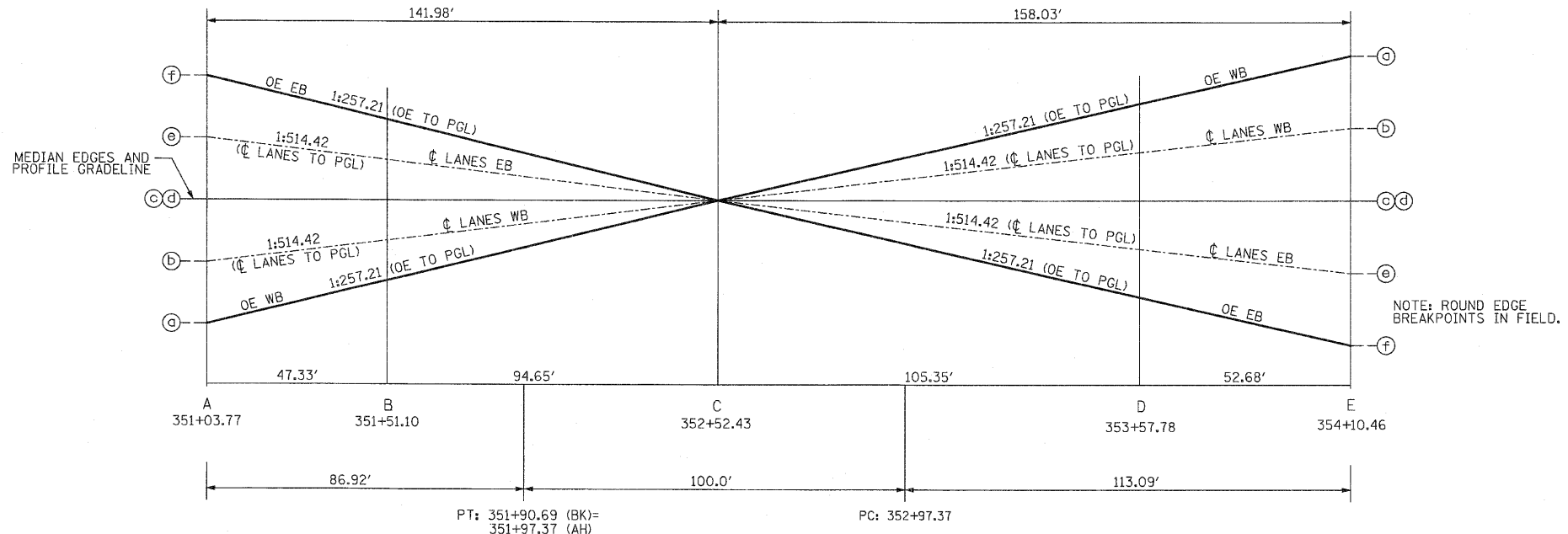

CLUS30-6 TO CLUS30-7
TRANSITION
DIVIDED HIGHWAY SECTION

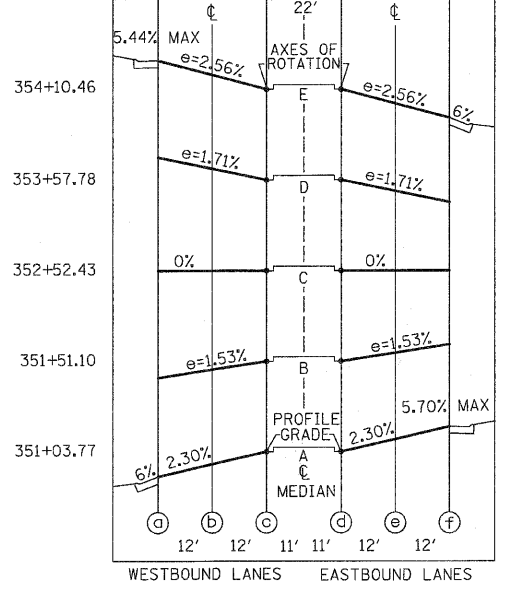

NOTE:
WB C&G BEGINS TRANSITION FROM 6% FLAG SLOPE TO 5.44% MAX FLAG SLOPE @ STA 353+75.89.
EB C&G BEGINS TRANSITION FROM 6% FLAG SLOPE TO 5.70% MAX FLAG SLOPE @ STA 351+22.29.

| REVISIONS | |
|-----------|------|
| NAME | DATE |
| | |
| | |
| | |
| | |
| | |
| | |
| | |
| | |
| | |
| | |

ILLINOIS DEPARTMENT OF TRANSPORTATION
SUPERELEVATION DETAILS
U.S. RTE. 30 (LINCOLN HIGHWAY)
SCALE: 1" = NTS
DATE: / /
DRAWN BY: BAE
CHECKED BY: GB