

F.A.P. RTE. NO.	SECTION	COUNTY	TOTAL SHEETS	SHEET NO.
353	(12&13)WRS-3	WILL	1235	122
STA. 202+00	TO STA. 230+00			
FED. ROAD DIST. NO.	ILLINOIS	FED. AID PROJECT		
CONTRACT NO. 62479				

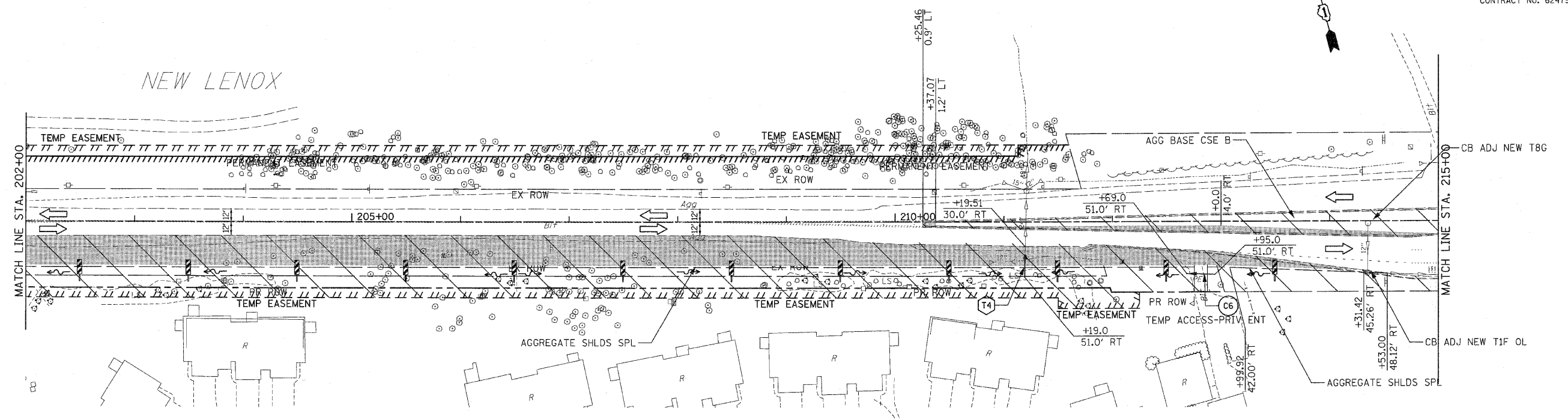

PIPE NO.	PIPE CULVERT (TEMPORARY)				SLOPE		INVERT		TRENCH BACKFILL
	LENGTH	DIAMETER	CLASS	TYPE	(FT/FT)	U.S.	D.S.		
C6	26	15	D	1	0.014	720.43	720.08	2.1	

PIPE NO.	PIPE				SLOPE		INVERT		TRENCH BACKFILL
	LENGTH	DIAMETER	TYPE	(FT/FT)	U.S.	D.S.			
T4	21	24	1	.005	718.34	718.23	2.9		

STRUCTURE	STATION	OFFSET	STRUCTURE TYPE		RIM ELEVATION	INVERT ELEVATION			
			TYPE	FRAME		NORTH	EAST	SOUTH	WEST
T3	224+10.0	56.2	RT	IN B	732.0	EX728.95	EX728.95	EX728.95	EX728.95

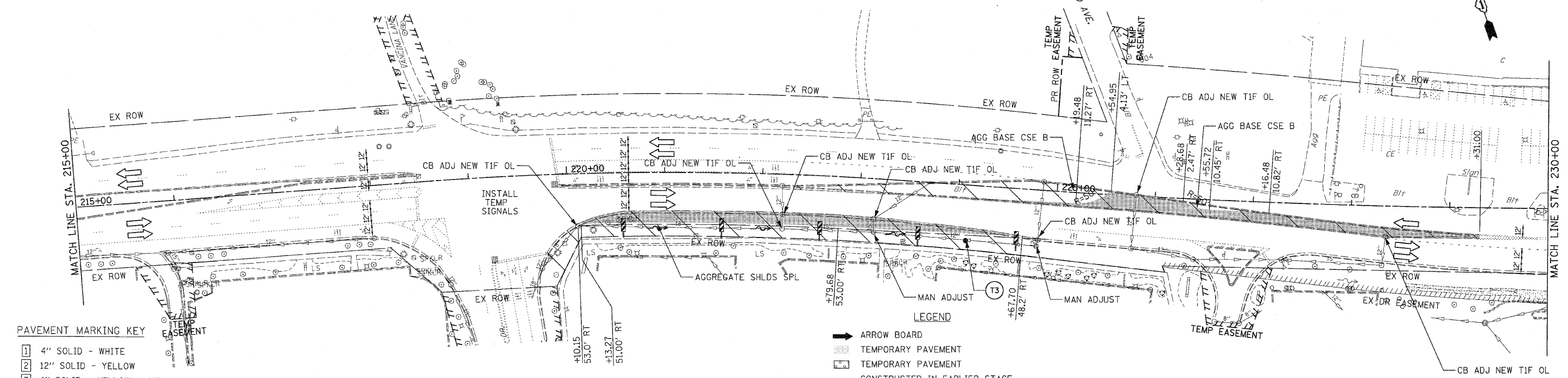

- PAVEMENT MARKING KEY**
- 1 4" SOLID - WHITE
  - 2 12" SOLID - YELLOW
  - 3 4" SOLID - YELLOW @ 11" C-C
  - 4 24" STOP BAR - WHITE
  - 5 12" SOLID - WHITE
  - 6 6" SOLID - WHITE
  - 7 6"-6 1/2" DASH-WHITE
  - 8 4" SOLID - YELLOW
  - 9 4" 30'/10' DASH WHITE

- LEGEND**
- ➔ ARROW BOARD
  - ▨ TEMPORARY PAVEMENT
  - ▨ TEMPORARY PAVEMENT
  - ▨ CONSTRUCTED IN EARLIER STAGE
  - ▨ CONSTRUCTION ZONE
  - ⊥ TYPE III BARRICADE WITH FLASHING LIGHTS
  - ⊥ TYPE II BARRICADE
  - ⊥ DRUM OR VERTICAL BARRICADE
  - ➔ DIRECTION INDICATOR BARRICADE WITH STEADY BURN MONODIRECTIONAL LIGHT
  - ⊥ FL FLASHING LIGHT
  - ⊙(XX) TEMPORARY STRUCTURE NUMBER
  - ⊙(XX) TEMPORARY PIPE NUMBER

REVISIONS		ILLINOIS DEPARTMENT OF TRANSPORTATION
NAME	DATE	
		<b>MAINTENANCE OF TRAFFIC</b> PRE-STAGE 1 U.S. RTE. 30 (LINCOLN HIGHWAY) STA. 202+00 TO STA. 230+00 SCALE: 1" = 50' DATE: / / DRAWN BY: BAE CHECKED BY: GB