

DO NOT INSTALL FRAME AND LIDS, TYPE 1, CLOSED LID ON CULVERT K DURING THIS STAGE. OPENING IN CULVERT SHOULD BE COVERED.

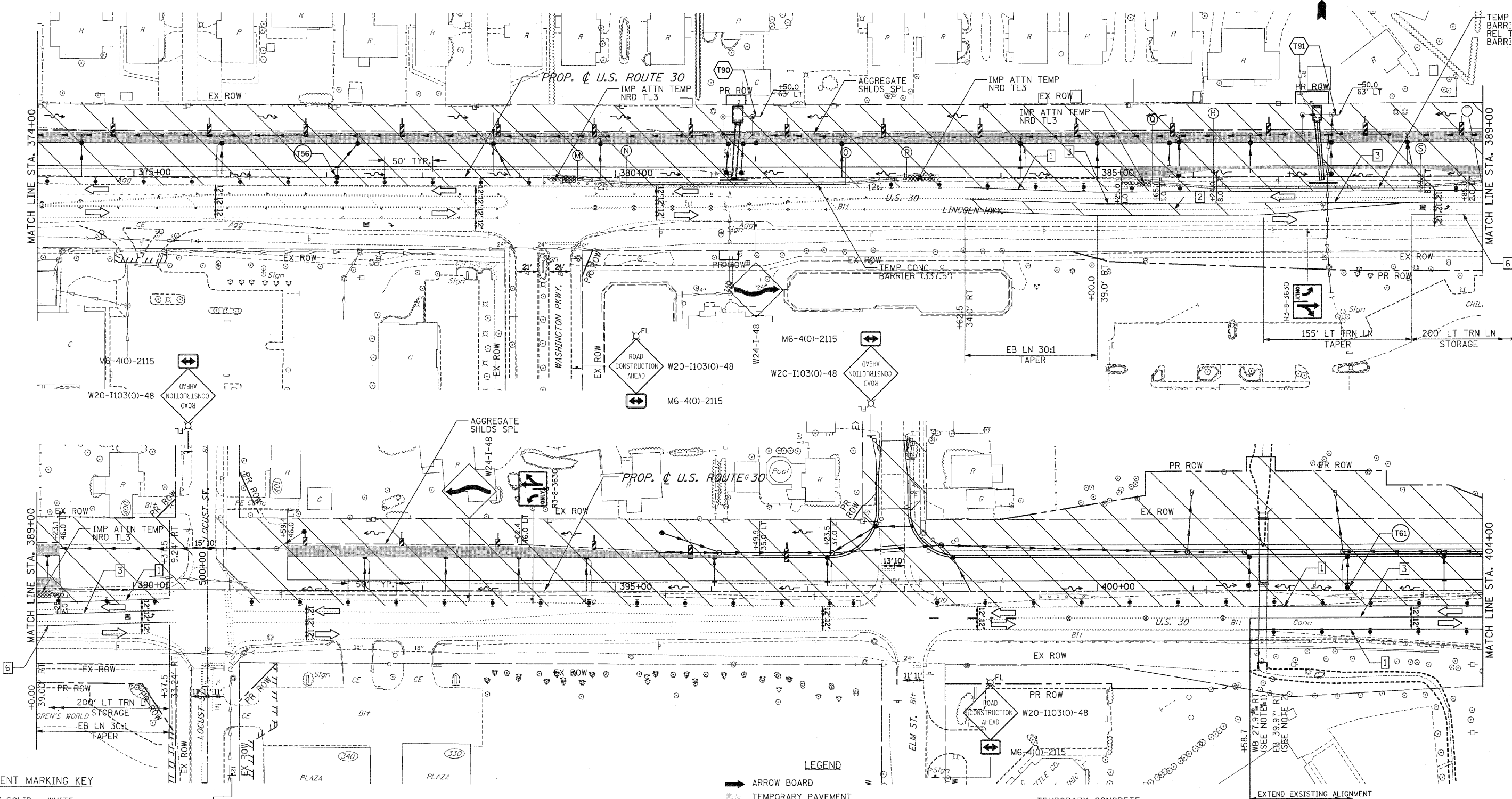

PAVEMENT MARKING KEY

- 1 4" SOLID - WHITE
- 2 12" SOLID - YELLOW
- 3 4" SOLID - YELLOW @ 11" C-C
- 4 24" STOP BAR - WHITE
- 5 12" SOLID - WHITE
- 6 6" SOLID - WHITE
- 7 6"-6'/2" DASH-WHITE
- 8 4" SOLID - YELLOW
- 9 4" 30'/10" DASH WHITE

LEGEND

- ARROW BOARD
- TEMPORARY PAVEMENT
- TEMPORARY PAVEMENT CONSTRUCTED IN EARLIER STAGE
- CONSTRUCTION ZONE
- TYPE III BARRICADE WITH FLASHING LIGHTS
- TYPE II BARRICADE
- DRUM OR VERTICAL BARRICADE
- DIRECTION INDICATOR BARRICADE WITH STEADY BURN MONODIRECTIONAL LIGHT
- FLASHING LIGHT

NOTES:

1. STATION AND OFFSET DATA GIVEN TO INSIDE EDGE OF TRAVELED WAY (YELLOW LINE).
2. STATION AND OFFSET GIVEN TO OUTSIDE EDGE OF TRAVELED WAY.

- XX TEMPORARY STRUCTURE NUMBER
- XX TEMPORARY PIPE NUMBER

TEMPORARY CONCRETE BARRIER LAYOUT (TO FF)

| LOCATION | STATION | OFFSET |
|----------|-----------|-----------|
| M | 379+60.68 | 2.79' RT |
| N | 380+11.18 | 7.00' RT |
| O | 382+39.01 | 7.00' RT |
| P | 383+02.12 | 1.74' RT |
| Q | 385+57.55 | 6.74' RT |
| R | 386+20.67 | 12.00' RT |
| S | 388+35.84 | 12.00' RT |
| T | 388+98.96 | 6.74' RT |

| REVISIONS | |
|-----------|------|
| NAME | DATE |
| | |
| | |
| | |

ILLINOIS DEPARTMENT OF TRANSPORTATION
MAINTENANCE OF TRAFFIC
 STAGE 1
 U.S. RTE. 30 (LINCOLN HIGHWAY)
 STA. 374+00 TO STA. 404+00
 SCALE: 1" = 50'
 DATE: / /
 DRAWN BY: BAE
 CHECKED BY: GB