

F.A.P. RTE.	SECTION	COUNTY	TOTAL SHEETS	SHEET NO.
353	(12&13)WRS-3	WILL	1235	158
STA. 318+00		TO STA. 346+00		
FED. ROAD DIST. NO.	ILLINOIS	FED. AID PROJECT		
CONTRACT NO. 62479				

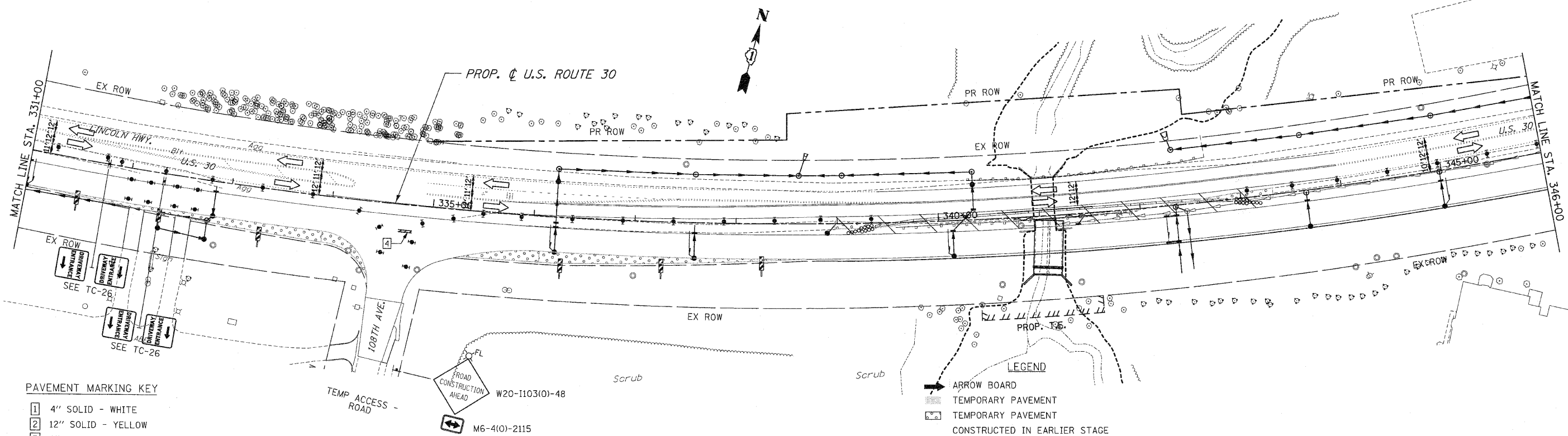
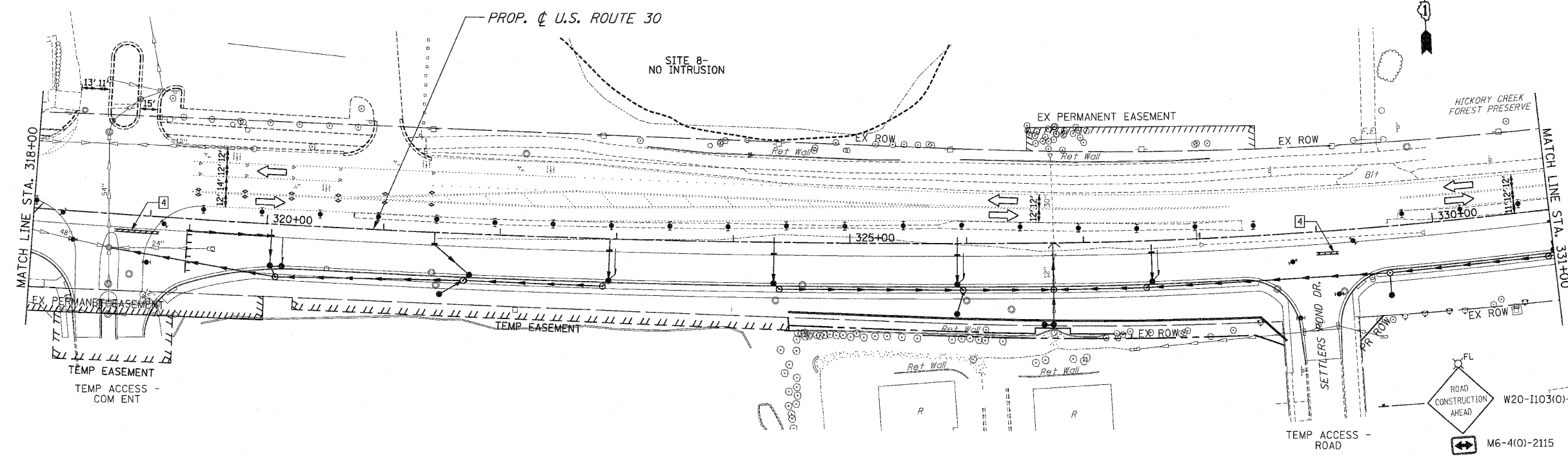

- PAVEMENT MARKING KEY**
- 1 4" SOLID - WHITE
 - 2 12" SOLID - YELLOW
 - 3 4" SOLID - YELLOW @ 11" C-C
 - 4 24" STOP BAR - WHITE
 - 5 12" SOLID - WHITE
 - 6 6" SOLID - WHITE
 - 7 6"-6'/2' DASH-WHITE
 - 8 4" SOLID - YELLOW
 - 9 4" 30'/10' DASH WHITE

- LEGEND**
- ARROW BOARD
 - TEMPORARY PAVEMENT
 - TEMPORARY PAVEMENT CONSTRUCTED IN EARLIER STAGE
 - CONSTRUCTION ZONE
 - TYPE III BARRICADE WITH FLASHING LIGHTS
 - TYPE II BARRICADE
 - DRUM OR VERTICAL BARRICADE
 - DIRECTION INDICATOR BARRICADE WITH STEADY BURN MONODIRECTIONAL LIGHT
 - FLASHING LIGHT

REVISIONS	
NAME	DATE

ILLINOIS DEPARTMENT OF TRANSPORTATION
MAINTENANCE OF TRAFFIC
 PRE-STAGE 2
 U.S. RTE. 30 (LINCOLN HIGHWAY)
 STA. 318+00 TO STA. 346+00
 SCALE : 1" = 50' DRAWN BY : BAE
 DATE : 10/12/2010 CHECKED BY : GB