

F.A.P. RTE.	SECTION	COUNTY	TOTAL SHEETS	SHEET NO.
353	(12&13)WRS-3	WILL	1235	162
STA. 118+00		TO STA. 146+00		
FED. ROAD DIST. NO.	ILLINOIS	FED. AID PROJECT		

CONTRACT NO. 62479

STAGE 2 GENERAL NOTES

STAGE 2 CONSTRUCTION

CONSTRUCT THE US RTE 30 EB PASSING AND DRIVING LANES AT THE FOLLOWING LOCATIONS:
 EAST OF WALONA TO WEST OF SCHOOLHOUSE
 EAST OF SCHOOLHOUSE TO WEST OF RETAIL DR.
 EAST OF RETAIL DR. TO EAST OF RIDGEMORE
 EAST OF ELSNER RD. TO WEST OF WASHINGTON PKWY.
 EAST OF WASHINGTON PKWY. TO WEST OF LOCUST ST.
 EAST OF LOCUST ST TO WEST OF US RTE 45.

CONSTRUCT PART OF THE FOLLOWING STRUCTURES (SEE STRUCTURE PLANS):

- CULVERT J
- CULVERT D
- CULVERT E
- CULVERT L
- NOISE WALL A (ALL)
- NOISE WALL B (ALL)

CONSTRUCT HALF OF THE FOLLOWING SIDESTREETS, MAINTAINING ACCESS AT ALL TIMES:

- WALONA
- RETAIL DR.

CONSTRUCT THE FOLLOWING SIDESTREETS, WHILE DETOUR IS IN PLACE:

- MARLEY
- SPENCER
- ANDERSON
- JOLIET HWY.
- BLUESTONE BAY
- PRESTANCIA DR.
- OWENS RD.
- HACKBERRY RD.
- ELM ST.

STAGE 2 TRAFFIC

EB AND WB US RTE 30 TRAFFIC WILL REMAIN THE SAME AS THE PREVIOUS STAGE EXCEPT FOR THE FOLLOWING CHANGES:

LEFT TURN LANE SHALL BE PROVIDED AT THE WEST ENTRANCE TO THE HIGH SCHOOL.

LEFT TURN LANE SHALL BE PROVIDED AT WASHINGTON PARKWAY.

DETOURS WILL BE ALLOWED AT THE FOLLOWING SIDE STREETS:

- MARLEY RD
- ANDERSON RD
- JOLIET HWY.
- BLUESTONE BAY
- PRESTANCIA
- OWENS RD
- HACKBERRY
- ELM ST

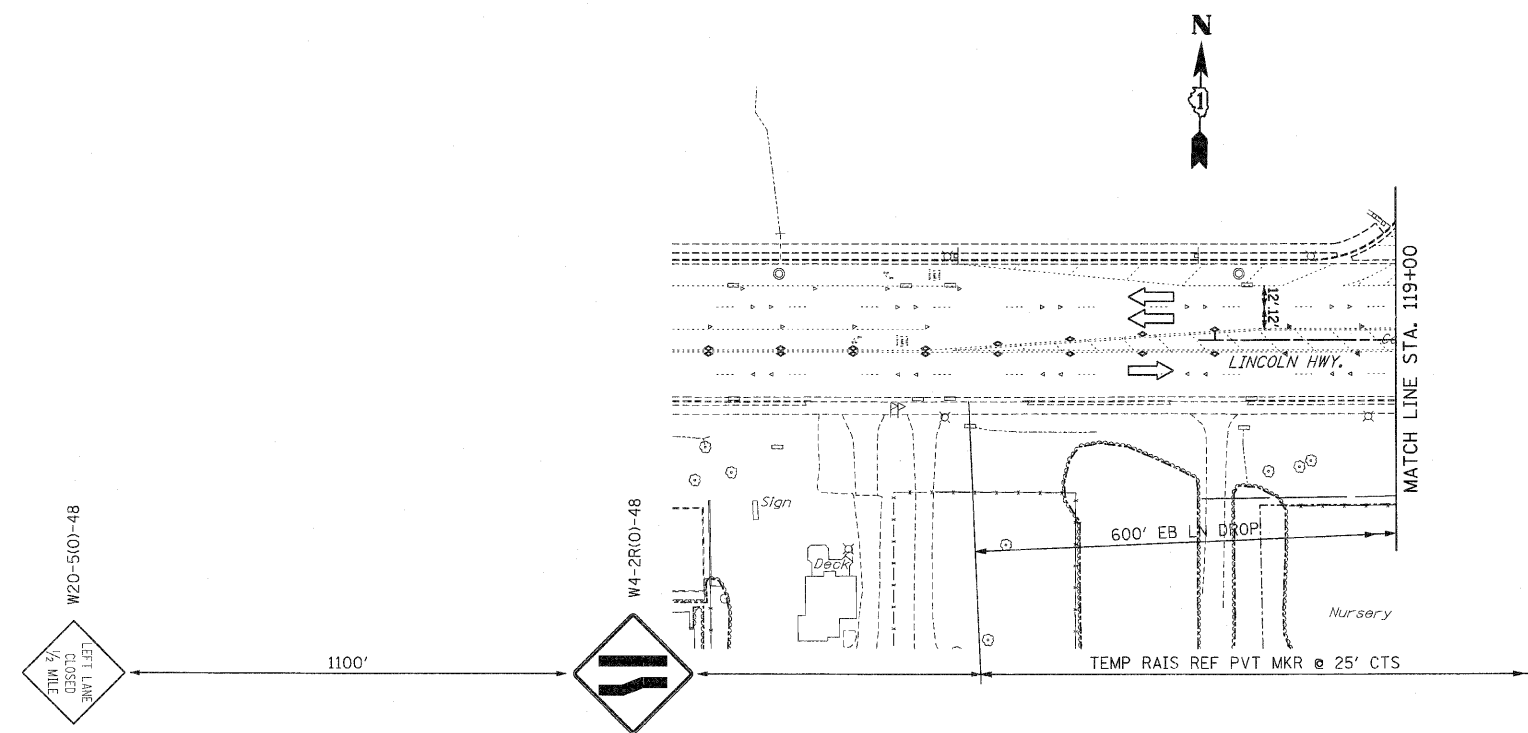

PAVEMENT MARKING KEY

- | | |
|---|-----------------------------|
| 1 | 4" SOLID - WHITE |
| 2 | 12" SOLID - YELLOW |
| 3 | 4" SOLID - YELLOW @ 11" c-c |
| 4 | 24" STOP BAR - WHITE |
| 5 | 12" SOLID - WHITE |
| 6 | 6" SOLID - WHITE |
| 7 | 6"-6'/2" DASH-WHITE |
| 8 | 4" SOLID - YELLOW |
| 9 | 4" 30'/10' DASH WHITE |

LEGEND

- ➔ ARROW BOARD
- ▨ TEMPORARY PAVEMENT
- ▨ TEMPORARY PAVEMENT CONSTRUCTED IN EARLIER STAGE
- ▨ CONSTRUCTION ZONE
- ⊥ TYPE III BARRICADE WITH FLASHING LIGHTS
- ⊥ TYPE II BARRICADE
- ⊥ DRUM OR VERTICAL BARRICADE
- ➔ DIRECTION INDICATOR BARRICADE WITH STEADY BURN MONODIRECTIONAL LIGHT
- ⊗^{FL} FLASHING LIGHT

REVISIONS	
NAME	DATE

ILLINOIS DEPARTMENT OF TRANSPORTATION

MAINTENANCE OF TRAFFIC

STAGE 2
 U.S. RTE. 30 (LINCOLN HIGHWAY)
 GENERAL NOTES

SCALE : 1" = 50'
 DATE : / / DRAWN BY : BAE
 CHECKED BY : GB