

F.A.P. RTE.	SECTION	COUNTY	TOTAL SHEETS	SHEET NO.
353	12&13WRS-3	WILL	1235	312
STA. 303+00		TO STA. 318+00		
FED. ROAD DIST. NO.	ILLINOIS	FED. AID PROJECT		

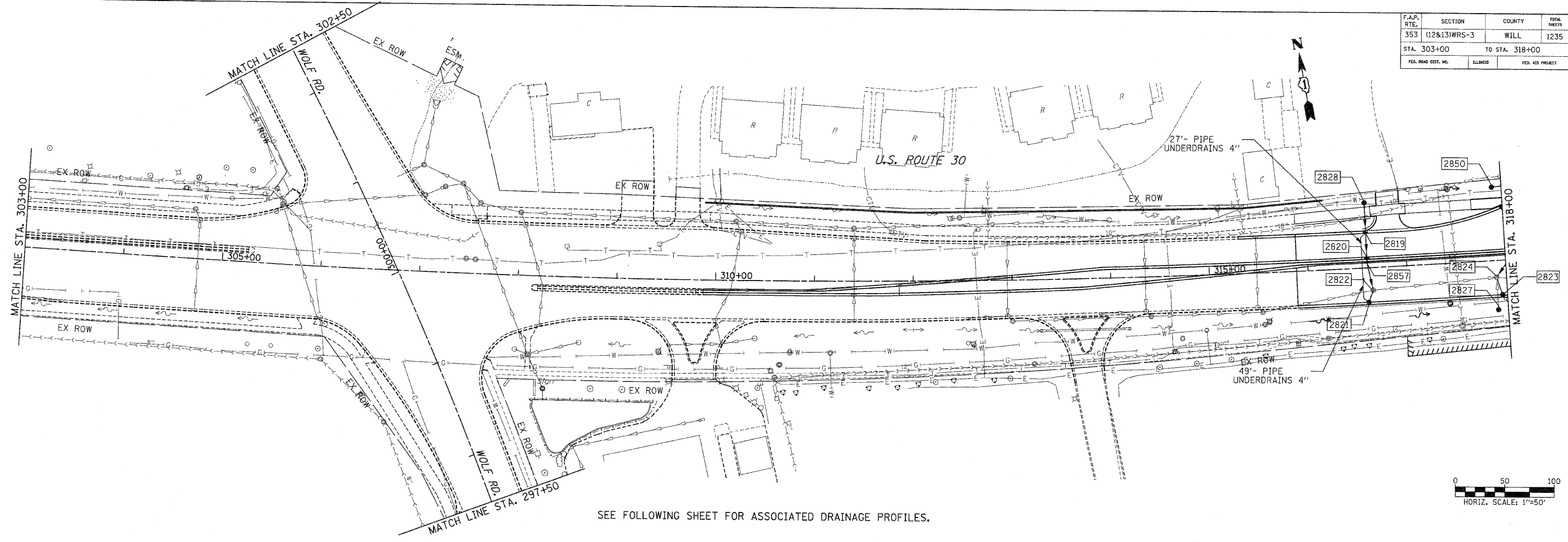

SEE FOLLOWING SHEET FOR ASSOCIATED DRAINAGE PROFILES.

PIPE TABLE

STRUCTURE		INVERT		SLOPE (FT/FT)	STORM SEWER *			TRENCH BACKFILL (CU YD)
U. S.	D. S.	U. S.	D. S.		TYPE	LENGTH (1)	LENGTH (2)	
2821	2822	717.81	717.80	0.0010	2	13	12	2.0
2828	2819	716.79	716.62	0.0050	2	34	12	0.0
2819	2820	716.62	716.50	0.0050	2	24	12	5.2
2820	2857	716.50	716.47	0.0050	2	6	12	1.5
2857	2822	716.47	716.33	0.0050	2	28	12	6.7
2827	2824	714.00	713.84	0.0050	2	33	12	5.7
2823	2824	716.77	716.68	0.0050	2	19	12	2.8

* TOTAL LENGTH FROM STRUCTURE TO STRUCTURE = STORM SEWER LENGTH (1) + STORM SEWER (WATER MAIN REQUIREMENTS) LENGTH (2)

STRUCTURE TABLE

STR. #	STATION	OFFSET	TYPE	FRAME	RIM ELEV	INVERT ELEVATION				UNDER DRAIN CONNECT	STR TOP SLAB
						NORTH	EAST	SOUTH	WEST		
2819	316+60.00	-35.0	IN B	24	721.97	716.62		716.62		YES	TAPERED
2820	316+60.00	-11.0	IN B	24	722.45	716.50		716.50		-	TAPERED
2821	316+60.00	35.0	CB C	24	721.97	717.81				YES	-
2822	316+65.00	23.0	EMH A5	1 CL	722.18	716.33	713.59	717.80	713.60	-	-
2823	317+95.00	35.0	CB C	24	720.93	716.77				-	-
2824	317+90.00	17.0	EMH A5	1 CL	721.33	715.39	713.47	713.84	713.46	-	-
2827	317+90.00	50.0	CB C	8	718.51	714.00				-	-
2828	316+60.00	-67.0	CB C	8	720.95			716.79		-	-
2829	319+46.00	-35.0	CB C	24	719.84		715.69			-	-
2850	317+90.00	-77.0	CB C	8	718.50		714.34			-	-
2857	316+60.00	-5.0	IN B	11V	722.13	716.47		716.47		-	TAPERED

NOTES:

- FOR DRAINAGE NOTES SEE FIRST PAGE DRAINAGE AND UTILITY PLANS.

REVISIONS		ILLINOIS DEPARTMENT OF TRANSPORTATION
NAME	DATE	
		DRAINAGE AND UTILITIES U.S. RTE. 30 (LINCOLN HIGHWAY)

SCALE: 1" = 50' DRAWN BY: BAE
 DATE: / / CHECKED BY: GB