

F.A.P. RTE.	SECTION	COUNTY	TOTAL SHEETS	SHEET NO.
353	(12&13)WRS-3	WILL	1235	316
STA. 331+00		TO STA. 346+00		
FED. ROAD DIST. NO.	ILLINOIS	FED. AID PROJECT		

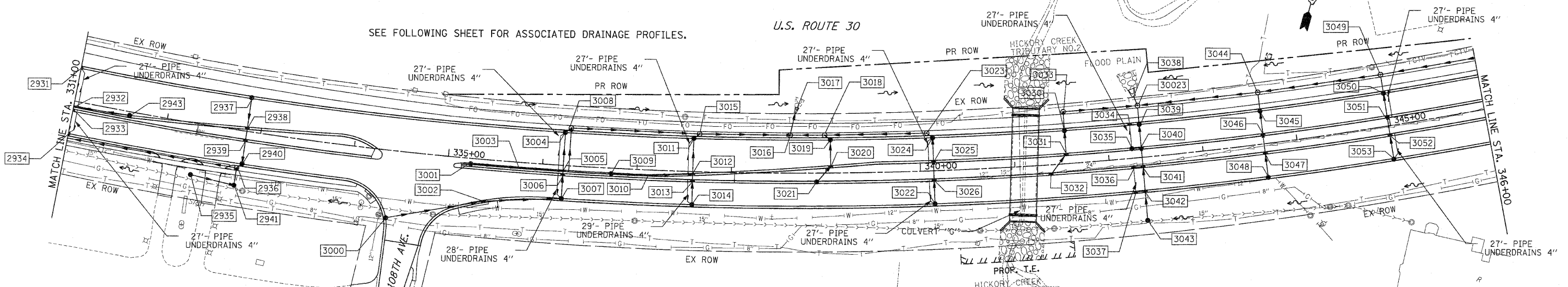

SEE FOLLOWING SHEET FOR ASSOCIATED DRAINAGE PROFILES.

U.S. ROUTE 30

PIPE TABLE

STR. #	STATION	STRUCTURE			RIM ELEV	INVERT ELEVATION				UNDER DRAIN CONNECT	STR TOP SLAB
		OFFSET	TYPE	FRAME		NORTH	EAST	SOUTH	WEST		
2931	331+00.00	-35.0	CB C	24	727.07		722.90			YES	-
2932	331+00.00	5.0	IN B	11V	727.99	722.50	722.58	722.50		-	TAPERED
2933	331+00.00	11.0	IN B	24	727.62	722.44		722.44		-	TAPERED
2934	331+00.00	35.0	CB A4	24	728.17	722.20		722.20		YES	TAPERED
2935	332+33.55	54.5	CB C	8	728.75		723.13			-	-
2936	332+80.00	40.0	MH A4	1 CL	729.90	723.45		722.48	722.48	-	TAPERED
2937	332+85.00	-35.0	CB C	24	728.39			724.22		-	-
2938	332+85.00	-4.5	IN B	24	728.79	723.91		723.91		-	TAPERED
2939	332+85.00	11.0	IN B	24	728.94	723.76		723.76		-	TAPERED
2940	332+85.00	35.0	CB A4	24	729.49	723.52		723.52		-	TAPERED
2941	332+80.00	58.6	CB A4	8	726.78	722.66			722.66	-	FLAT
2943	331+60.00	4.0	CB C	11V	728.42				723.18	-	-
3000	334+41.60	71.6	CB C	24	729.66		725.50			-	-
3001	335+24.00	5.0	CB C	11V	728.88		724.72			-	-
3002	335+40.47	43.2	IN B	24	729.49	724.99			724.99	-	TAPERED
3003	335+75.00	5.0	IN B	11V	728.68		724.31	724.58	724.47	-	TAPERED
3004	336+22.00	-35.0	CB A4	24	728.31	723.88		723.88		YES	FLAT
3005	336+22.00	5.0	IN B	11V	728.49	724.08		724.33	724.08	-	TAPERED
3006	336+22.00	11.0	IN B	24	728.86	724.36		724.36		-	TAPERED
3007	336+22.00	35.0	CB C	24	729.41	724.48				YES	-
3008	336+28.00	-40.0	MH A4	1 CL	728.59		723.84	723.84		-	FLAT
3009	336+73.00	5.0	CB C	11V	728.29		724.13			-	-
3010	337+12.00	5.0	IN B	11V	728.13		723.94		723.94	-	TAPERED
3011	337+59.00	-35.0	CB A4	24	727.76	723.05		723.05		YES	FLAT
3012	337+59.00	2.2	IN B	24	728.01	723.24		723.58	723.70	-	TAPERED
3013	337+59.00	11.0	IN B	24	728.31	723.62		723.62		-	TAPERED
3014	337+59.00	35.0	CB C	24	728.96	723.74				YES	-
3015	337+65.00	-40.0	MH A4	1 CL	728.06		723.01	723.15	723.15	-	FLAT
3016	338+62.00	-40.0	MH A4	1 CL	727.65	722.32	722.32		722.53	-	FLAT
3017	338+67.00	-63.6	FES 21	-	722.24			722.20		-	-
3018	339+00.00	-40.0	MH A4	1 CL	727.50		722.41	722.95	722.41	-	FLAT
3019	339+05.00	-35.0	CB A4	24	727.18	722.98		722.98		-	FLAT
3020	339+05.00	-7.8	IN B	24	727.66	723.12		723.12		-	TAPERED
3021	338+90.00	11.0	CB C	24	727.79	723.24				-	-
3022	340+14.00	35.0	CB C	24	727.84	723.12				-	-
3023	340+08.00	-40.0	MH A4	1 CL	727.10		722.74	722.74	722.74	YES	FLAT
3024	340+14.00	-35.0	CB A4	24	726.80	722.77		722.77		YES	FLAT
3025	340+14.00	-11.0	IN B	24	727.29	722.89		722.89		-	TAPERED
3026	340+14.00	11.0	IN B	24	727.29	723.00		723.00		-	TAPERED
3030	341+55.00	-35.0	CB A4	24	727.29	721.84		721.84		-	FLAT
3031	341+55.00	-11.0	IN B	24	726.73	721.96		721.96		-	TAPERED
3032	341+38.00	11.0	IN B	24	726.80	722.10				-	TAPERED
3033	341+55.00	-55.0	MH A4	1 CL	726.33		721.74	721.74		-	FLAT
3034	342+25.00	-35.0	IN B	24	725.99		721.82			YES	TAPERED
3035	342+25.00	-11.0	CB C	24	726.54		722.38			-	-
3036	342+25.00	11.0	IN B	24	726.54		722.38			-	TAPERED
3037	342+25.00	35.0	IN B	24	727.09		722.93			YES	TAPERED
3038	342+32.00	-65.1	FES 36	-	719.07			718.50		-	-
3039	342+35.00	-35.0	CB A4	24	725.99	718.62		718.62		-	FLAT
3040	342+35.00	-11.0	IN B	24	726.54	718.73		718.73	721.77	-	TAPERED
3041	342+35.00	11.0	IN B	24	726.54	718.82		718.82	722.33	-	TAPERED
3042	342+35.00	35.0	IN B	24	727.09	718.93		718.93	722.88	-	TAPERED
3043	342+35.00	67.0	CB C	8	722.77	719.07				-	-
3044	343+65.00	-55.0	MH A5	1 CL	726.62		718.95	722.20	718.95	-	FLAT
3045	343+65.00	-35.0	CB A4	24	726.47	722.30		722.30		-	FLAT
3046	343+65.00	-11.0	IN B	24	727.02	722.42		722.42		-	TAPERED
3047	343+65.00	11.0	IN B	24	727.02	722.53		722.53		-	TAPERED
3048	343+65.00	35.0	CB C	24	727.57	722.65				-	-
3049	344+98.00	-55.0	MH A5	1 CL	727.39		719.74	722.97	719.74	-	FLAT
3050	344+98.00	-35.0	CB A4	24	727.24	723.07		723.07		YES	FLAT
3051	344+98.00	-11.0	IN B	24	727.79	723.19		723.19		-	TAPERED
3052	344+98.00	11.0	IN B	24	727.79	723.30		723.30		-	TAPERED
3053	344+98.00	35.0	CB C	24	728.34	723.42				YES	TAPERED
30023	342+35.00	-55.0	MH A5	1 CL	726.14	718.53	718.17	718.53	721.26	-	FLAT

STRUCTURE	INVERT		SLOPE (FT/FT)	TYPE	STORM SEWER			TRENCH BACKFILL (CU YD)
	U. S.	D. S.			LENGTH (1)	LENGTH (2)	DIA (INCH)	
2937 2938	724.22	723.91	0.0100	2	31	12	4.6	
2938 2939	723.91	723.76	0.0100	2	15	12	4.3	
2939 2940	723.76	723.52	0.0100	2	24	12	6.7	
2940 2936	723.52	723.45	0.0100	2	7	12	2.4	
2935 2941	723.13	722.66	0.0100	2	47	12	0.0	
2941 2936	722.66	722.48	0.0100	2	0	19	0.0	
2936 2930	722.48	721.18	0.0070	2	41	144	134.7	
2931 2932	722.90	722.50	0.0100	2	40	12	6.1	
2943 2932	723.18	722.58	0.0100	2	60	12	10.4	
2932 2933	722.50	722.44	0.0100	2	6	15	1.3	
2933 2934	722.44	722.20	0.0100	2	24	15	6.8	
2934 2930	722.20	722.13	0.0100	2	0	7	2.5	
3000 3002	725.50	724.99	0.0050	2	71	15	13.6	
3002 3007	724.99	724.58	0.0050	2	82	12	14.2	
3001 3003	724.72	724.47	0.0050	2	51	12	6.7	
3003 3005	724.31	724.08	0.0050	2	47	12	7.1	
3007 3006	724.48	724.36	0.0050	2	24	12	4.2	
3006 3005	724.36	724.33	0.0050	2	6	12	1.4	
3005 3004	724.08	723.88	0.0050	2	40	12	0.9	
3004 3008	723.88	723.84	0.0050	2	8	12	6.1	
3008 3015	723.84	723.15	0.0050	2	137	15	26.0	
3009 3010	724.13	723.94	0.0050	2	39	12	5.1	
3010 3012	723.94	723.70	0.0050	2	47	12	6.2	
3014 3013	723.74	723.62	0.0050	2	24	12	4.7	
3013 3012	723.62	723.58	0.0050	2	9	15	1.5	
3012 3011	723.24	723.05	0.0050	2	37	18	5.8	
3011 3015	723.05	723.01	0.0050	2	8	18	1.4	
3015 3016	723.01	722.53	0.0050	2	97	18	66.3	
3022 3026	723.12	723.00	0.0050	2	24	12	3.6	
3026 3025	723.00	722.89	0.0050	2	22	12	0.0	
3025 3024	722.89	722.77	0.0050	1	24	12	3.2	
3024 3023	722.77	722.74	0.0044	1	8	12	1.0	
3023 3018	722.74	722.41	0.0030	2	108	15	69.3	
3021 3020	723.24	723.12	0.0050	2	24	12	0.0	
3020 3019	723.12	722.98	0.0050	2	27	12	3.6	
3019 3018	722.98	722.95	0.0050	2	7	12	1.1	
3018 3016	722.41	722.32	0.0024	2	38	18	8.8	
3016 3017	722.32	722.20	0.0050	1	24	21	3.3	
3053 3052	723.42	723.30	0.0050	2	24	12	4.2	
3052 3051	723.30	723.19	0.0050	2	22	12	0.0	
3051 3050	723.19	723.07	0.0050	2	24	12	3.6	
3050 3049	723.07	722.97	0.0050	2	20	12	6.8	
3049 3044	719.74	718.95	0.0060	2	133	30	159.9	
3048 3047	722.65	722.53	0.0050	2	24	12	4.2	
3047 3046	722.53	722.42	0.0050	2	22	12	0.0	
3046 3045	722.42	722.30	0.0050	2	24	12	3.6	
3045 3044	722.30	722.20	0.0050	2	20	12	6.8	
3044 30023	718.95	718.17	0.0060	2	130	30	162.1	
3032 3031	722.10	721.84	0.0050	2	28	12	0.0	
3031 3030	721.96	721.84	0.0050	2	24	12	3.6	
3030 3033	721.84	721.74	0.0050	2	20	12	7.2	
3033 30023	721.74	721.26	0.0060	2	80	15	31.8	
3043 3042	719.07	718.93	0.0044	2	32	12	0.0	
3037 3042	722.93	722.88	0.0050	2	10	12	1.3	
3042 3041	718.93	718.82	0.0044	2	0	24	19.0	
3036 3041	722.38	722.33	0.0050	2	10	12	0.0	
3041 3040	718.82	718.73	0.0044	2	22	12	0.0	
3035 3040	722.38	722.33	0.0050	2	10	12	1.3	
3040 3039	718.73	718.62	0.0044	2	24	12	18.2	
3034 3039	721.82	721.77	0.0050	2	10	12	1.3	
3039 30023								