

F.A.P. RTE.	SECTION	COUNTY	TOTAL SHEETS	SHEET NO.
353	(12&13)WRS-3	WILL	1235	326
STA. 404+00		TO STA. 419+00		
FED. ROAD DIST. NO.		ILLINOIS	FED. AID PROJECT	

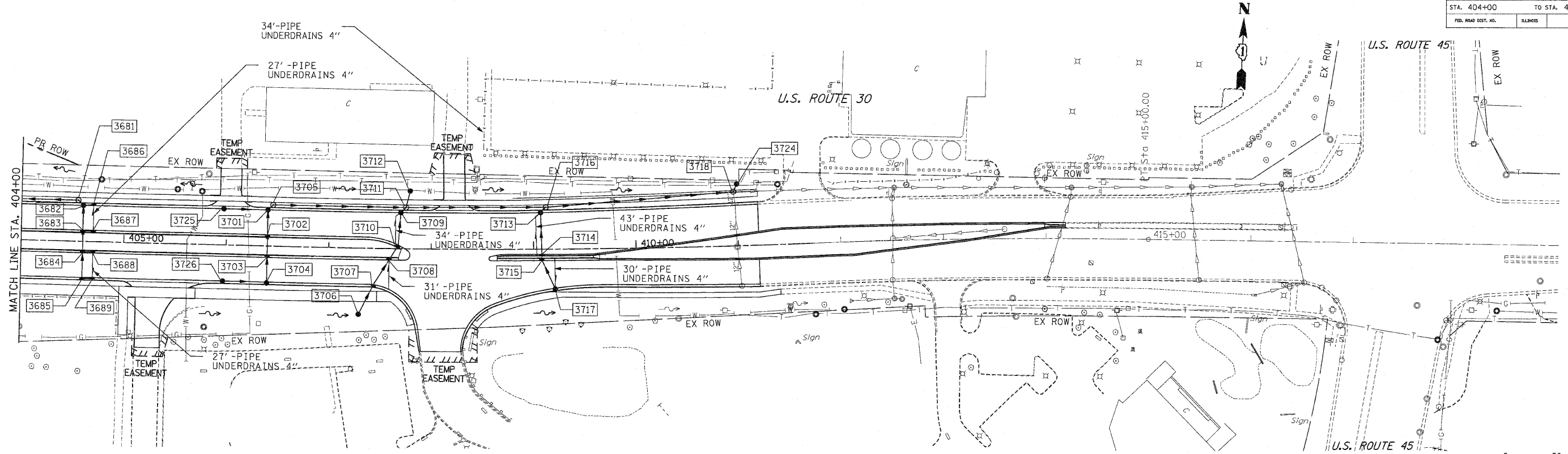

PIPE TABLE

STRUCTURE		INVERT		SLOPE (FT/FT)	TYPE	STORM SEWER*		DIA INCH	TRENCH BACKFILL (CU YD)
U. S.	D. S.	U. S.	D. S.			LENGTH (1)	LENGTH (2)		
3726	3704	727.89	727.46	0.0100	2	43		12	5.7
3704	3703	727.46	727.22	0.0100	2	24		12	4.7
3703	3702	727.22	727.00	0.0100	2	22		12	0.0
3702	3701	727.00	726.76	0.0100	2	24		12	5.7
3725	3701	727.80	727.37	0.0100	2	43		12	6.5
3701	3705	726.76	726.69	0.0100	2	7		12	1.8
3705	3711	726.69	725.39	0.0100	2	130		12	41.6
3712	3711	725.82	725.69	0.0100	2	17		12	0.0
3706	3707	725.74	725.58	0.0050	2	33		12	0.0
3707	3708	725.58	725.43	0.0050	2	29		12	9.7
3708	3710	725.43	725.35	0.0050	2	17		12	6.2
3710	3709	725.35	725.19	0.0050	2	32		12	10.8
3709	3711	725.19	725.15	0.0050	2	7		12	2.6
3711	3716	725.15	723.92	0.0090	2	137		18	93.7
3717	3715	725.65	725.35	0.0100	2	30		12	7.0
3715	3714	725.35	725.29	0.0100	2	6		12	1.7
3714	3713	725.29	724.89	0.0100	2	41		12	11.3
3713	3716	724.89	724.81	0.0100	2	7		12	2.3
3716	3718	723.92	722.07	0.0100	2	153	32	18	180.2
3724	3718	722.64	722.56	0.0100	2	8		12	0.0
3689	3685	728.43	728.33	0.0100	2	10		12	1.3
3685	3684	728.33	728.09	0.0100	2	24		12	4.2
3688	3684	728.91	728.81	0.0100	2	10		12	1.3
3684	3683	728.09	727.87	0.0100	2	22		12	0.0
3687	3683	728.91	728.81	0.0100	2	10		12	1.3
3683	3682	727.87	727.63	0.0100	2	24		12	5.2
3686	3682	728.43	728.33	0.0100	2	10		12	1.3
3682	3681	727.63	727.56	0.0100	2	7		12	1.7
3681	3676	727.56	726.85	0.0071	2	100		12	32.0

\* TOTAL LENGTH FROM STRUCTURE TO STRUCTURE = STORM SEWER LENGTH (1) + STORM SEWER (WATER MAIN REQUIREMENTS) LENGTH (2)

STRUCTURE TABLE

STR. #	STATION	OFFSET	STRUCTURE		RIM ELEV	INVERT ELEVATION				UNDER DRAIN CONNECT.	STR TOP SLAB
			TYPE	FRAME		NORTH	EAST	SOUTH	WEST		
3701	406+40.00	-35.0	CB A4	24	731.91	726.76		726.76	727.37	-	FLAT
3702	406+40.00	-11.0	IN B	24	732.39	727.00		727.00		-	TAPERED
3703	406+40.00	11.0	IN B	24	732.39	727.22		727.22		-	TAPERED
3704	406+40.00	35.0	IN B	24	731.91	727.46	727.46			-	TAPERED
3705	406+45.00	-40.0	MH A4	1 CL	732.44		726.69	726.69		-	TAPERED
3706	407+30.00	65.0	CB C	8	729.40	725.74				-	-
3707	407+44.00	35.3	IN B	24	731.49	725.58		725.58		-	TAPERED
3708	407+59.00	11.0	IN B	24	731.92	725.43		725.43	YES	-	TAPERED
3709	407+70.00	-35.0	CB A4	24	731.39	725.19		725.19	YES	-	TAPERED
3710	407+68.00	-3.5	IN B	24	731.68	725.35		725.35		-	TAPERED
3711	407+75.00	-40.0	MH A4	1 CL	731.92	725.65	725.15	725.15	725.39	-	TAPERED
3712	407+79.00	-56.1	CB A4	8	729.98			725.82		-	FLAT
3713	409+07.00	-35.6	CB A4	24	730.75	724.89		724.89	YES	-	TAPERED
3714	409+08.00	5.0	IN B	11V	730.90	725.29		725.29		-	TAPERED
3715	409+08.00	11.0	IN B	24	731.23	725.35		725.35		-	TAPERED
3716	409+12.00	-40.8	MH A4	1 CL	731.26		723.92	724.81	723.92	-	TAPERED
3717	409+20.76	37.9	CB C	24	730.22	725.65			YES	-	-
3718	410+96.43	-52.7	MH A5	1 CL	728.20	722.56	717.45	722.97EX	722.07	-	FLAT
3724	411+00.00	-60.1	CB A4	8	726.80			722.64		-	FLAT
3725	405+97.00	-35.0	CB C	11V	732.09		727.80			-	-
3726	405+97.00	35.0	CB C	11V	732.09		727.89			-	-
3681	404+55.00	-40.0	MH A4	1 CL	735.10			727.56	727.56	-	-
3682	404+60.00	-35.0	CB A4	24	732.63	727.63	728.33	727.63		-	-
3683	404+60.00	-11.0	IN B	24	733.11	727.87	728.81	727.87		-	-
3684	404+60.00	11.0	IN B	24	733.11	728.09	728.81	728.09		-	-
3685	404+60.00	35.0	IN B	24	732.63		728.33			-	-
3686	404+70.00	-35.0	CB C	24	732.59			728.43	YES	-	YES
3687	404+70.00	-11.0	CB C	24	733.07			728.91		-	-
3688	404+70.00	11.0	CB C	24	733.07			728.91		-	-
3689	404+70.00	35.0	CB C	24	732.59			728.43	YES	-	YES

NOTES:

1. FOR DRAINAGE NOTES SEE FIRST PAGE DRAINAGE AND UTILITY PLANS.

REVISIONS		ILLINOIS DEPARTMENT OF TRANSPORTATION
NAME	DATE	
		DRAINAGE AND UTILITIES U.S. RTE. 30 (LINCOLN HIGHWAY)
SCALE: 1" = 50'		DRAWN BY: BAE
DATE: / /		CHECKED BY: GB