

F.A.P. RTE.	SECTION	COUNTY	TOTAL SHEETS	SHEET NO.
353	(12&13)WRS-3	WILL.	1235	399
STA.	TO STA.			
FED. ROAD DIST. NO.	ILLINOIS	FED. AID PROJECT		
CONTRACT NO. 62479				

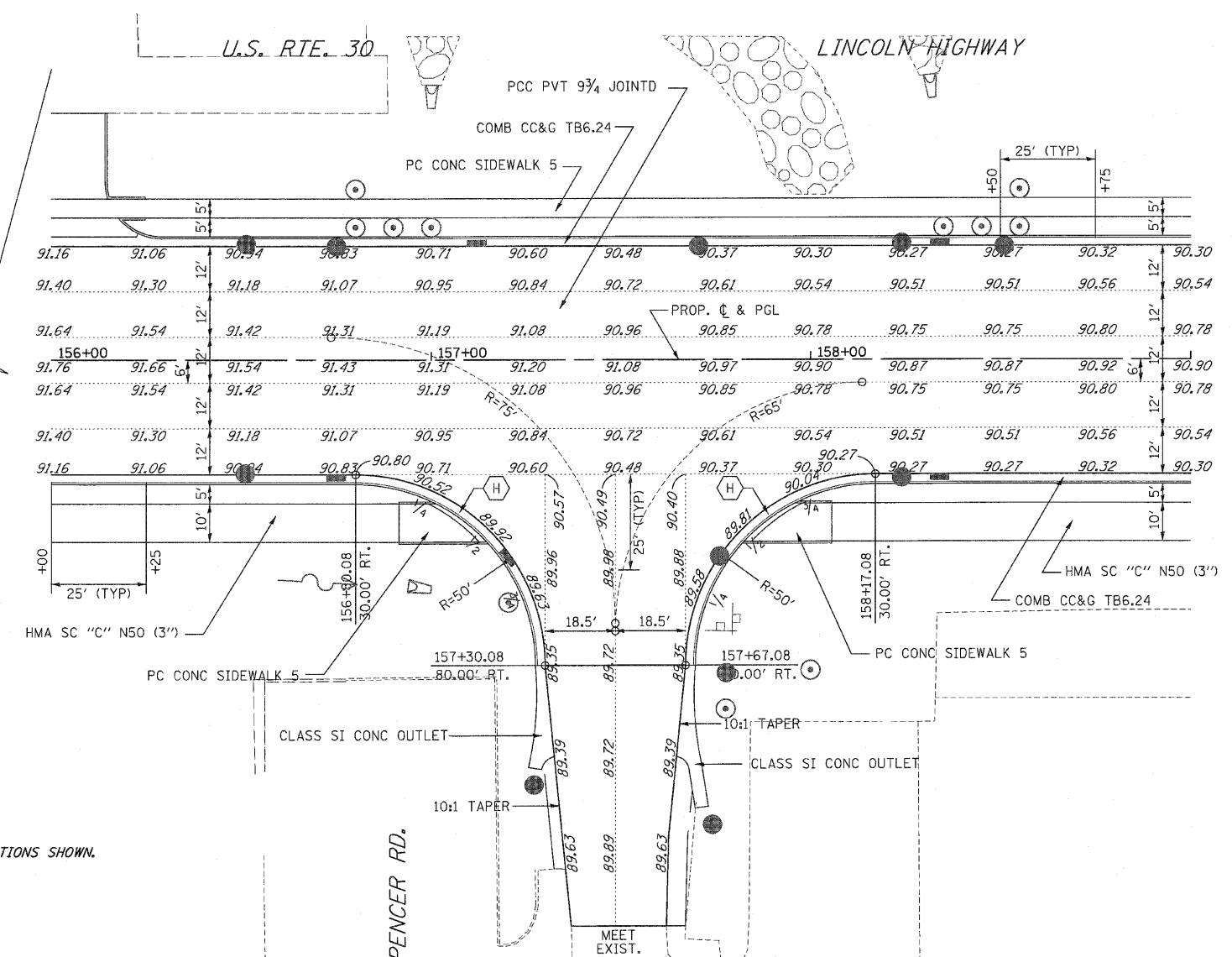
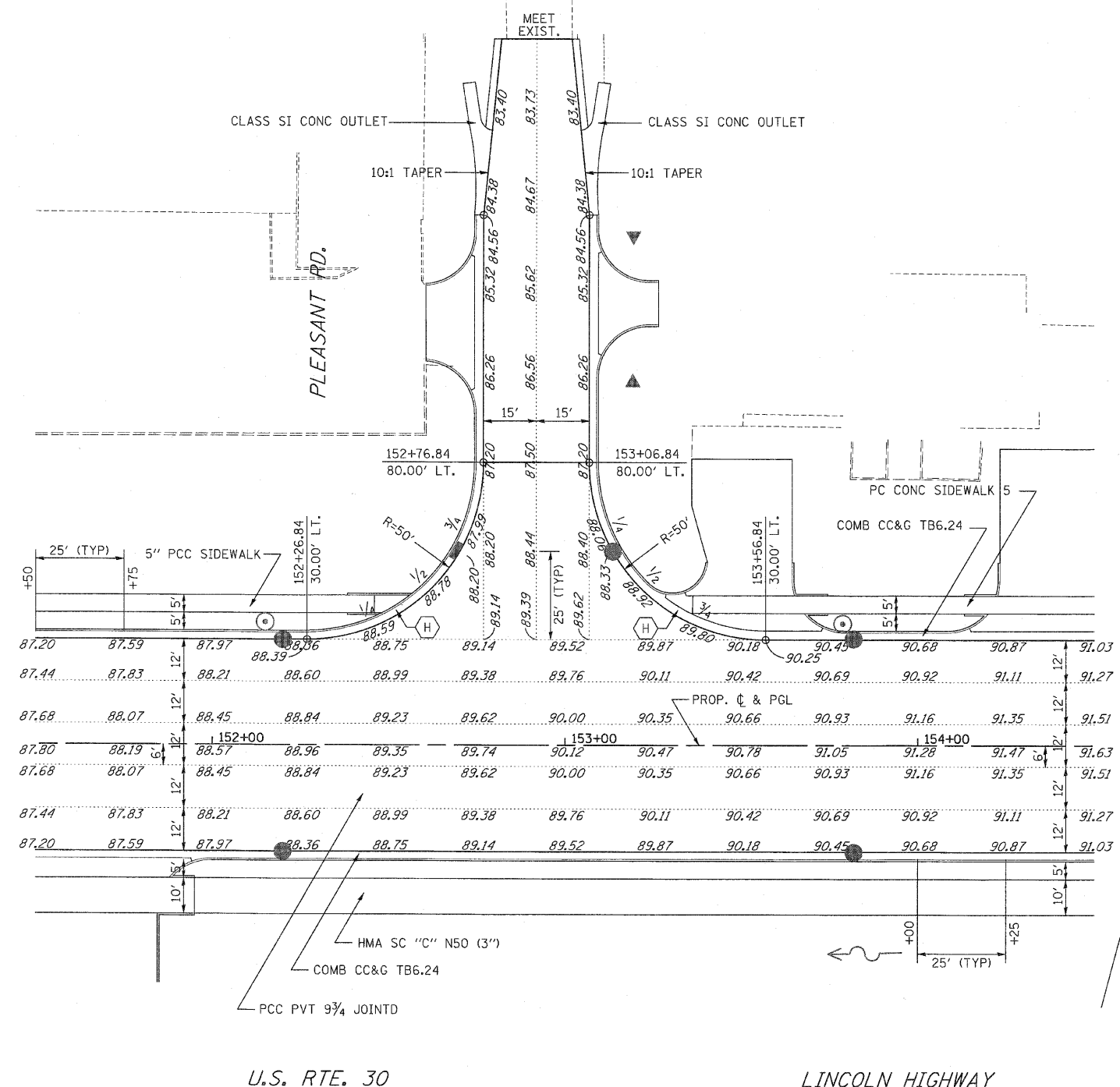

87.20	87.59	87.97	88.36	88.75	89.14	89.52	89.87	90.18	90.45	90.68	90.87	91.03
87.44	87.83	88.21	88.60	88.99	89.38	89.76	90.11	90.42	90.69	90.92	91.11	91.27
87.68	88.07	88.45	88.84	89.23	89.62	90.00	90.35	90.66	90.93	91.16	91.35	91.51
87.80	88.19	88.57	88.96	89.35	89.74	90.12	90.47	90.78	91.05	91.28	91.47	91.63
87.68	88.07	88.45	88.84	89.23	89.62	90.00	90.35	90.66	90.93	91.16	91.35	91.51
87.44	87.83	88.21	88.60	88.99	89.38	89.76	90.11	90.42	90.69	90.92	91.11	91.27
87.20	87.59	87.97	88.36	88.75	89.14	89.52	89.87	90.18	90.45	90.68	90.87	91.03

91.16	91.06	90.94	90.83	90.71	90.60	90.48	90.37	90.30	90.27	90.27	90.32	90.30
91.40	91.30	91.18	91.07	90.95	90.84	90.72	90.61	90.54	90.51	90.51	90.56	90.54
91.64	91.54	91.42	91.31	91.19	91.08	90.96	90.85	90.78	90.75	90.75	90.80	90.78
91.76	91.66	91.54	91.43	91.31	91.20	91.08	90.97	90.90	90.87	90.87	90.92	90.90
91.64	91.54	91.42	91.31	91.19	91.08	90.96	90.85	90.78	90.75	90.75	90.80	90.78
91.40	91.30	91.18	91.07	90.95	90.84	90.72	90.61	90.54	90.51	90.51	90.56	90.54
91.16	91.06	90.94	90.83	90.71	90.60	90.48	90.37	90.30	90.27	90.27	90.32	90.30

NOTE: ADD 600.00 FT. TO ELEVATIONS SHOWN.

- NOTES:
- SEE DISTRICT ONE STANDARD DETAILS (BD 01) AND (BD 02) FOR DRIVEWAY CONSTRUCTION DETAILS. SEE PLAN AND PROFILES FOR DRIVEWAY LOCATIONS AND DIMENSIONS.
 - SEE STATE STANDARD 424001-02 FOR SIDEWALK RAMPS ACCESSIBLE TO THE DISABLED, MARKED AS (H) ON THESE SHEETS. SEE PAVEMENT MARKING PLANS FOR LOCATION VERIFICATION.

REVISIONS	
NAME	DATE

ILLINOIS DEPARTMENT OF TRANSPORTATION
INTERSECTION DETAILS
 U.S. RTE. 30 (LINCOLN HIGHWAY)
 & PLEASANT ST. / SPENCER RD.
 SCALE: 1" = 20'
 DATE: 10/12/2010
 DRAWN BY:
 CHECKED BY: