

F.A.P. RTE.	SECTION	COUNTY	TOTAL SHEETS	SHEET NO.
353	(12&13)WRS-3	WILL	1235	476
STA.		TO STA.		
FED. ROAD DIST. NO.		ILLINOIS	FED. AID PROJECT	
CONTRACT NO. 62479				

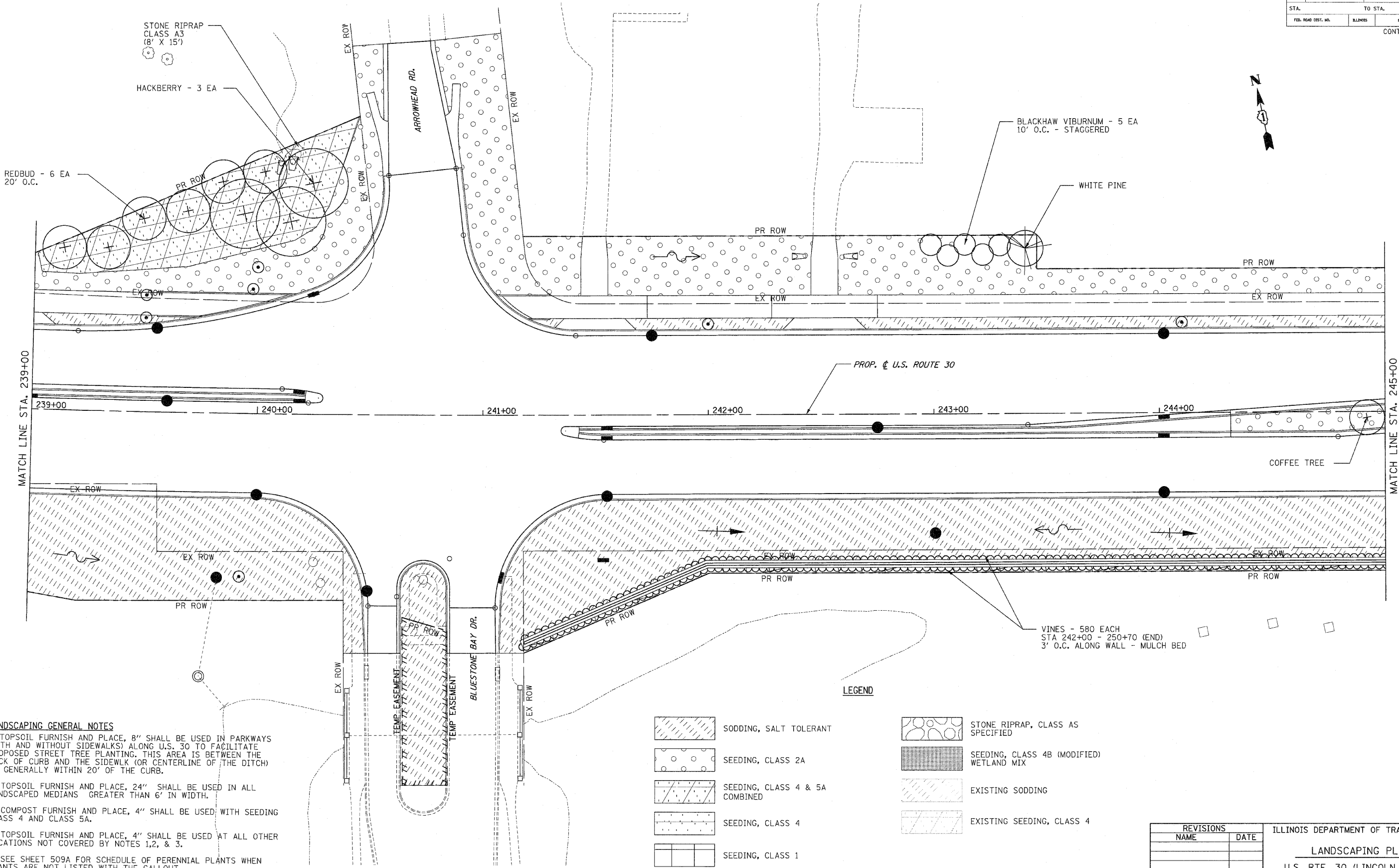

LANDSCAPING GENERAL NOTES

1. TOPSOIL FURNISH AND PLACE, 8" SHALL BE USED IN PARKWAYS (WITH AND WITHOUT SIDEWALKS) ALONG U.S. 30 TO FACILITATE PROPOSED STREET TREE PLANTING. THIS AREA IS BETWEEN THE BACK OF CURB AND THE SIDEWALK (OR CENTERLINE OF THE DITCH) OR GENERALLY WITHIN 20' OF THE CURB.
2. TOPSOIL FURNISH AND PLACE, 24" SHALL BE USED IN ALL LANDSCAPED MEDIANS GREATER THAN 6' IN WIDTH.
3. COMPOST FURNISH AND PLACE, 4" SHALL BE USED WITH SEEDING CLASS 4 AND CLASS 5A.
4. TOPSOIL FURNISH AND PLACE, 4" SHALL BE USED AT ALL OTHER LOCATIONS NOT COVERED BY NOTES 1, 2, & 3.
5. SEE SHEET 509A FOR SCHEDULE OF PERENNIAL PLANTS WHEN PLANTS ARE NOT LISTED WITH THE CALLOUT.

LEGEND

	SODDING, SALT TOLERANT		STONE RIPRAP, CLASS AS SPECIFIED
	SEEDING, CLASS 2A		SEEDING, CLASS 4B (MODIFIED) WETLAND MIX
	SEEDING, CLASS 4 & 5A COMBINED		EXISTING SODDING
	SEEDING, CLASS 4		EXISTING SEEDING, CLASS 4
	SEEDING, CLASS 1		
	PERENNIAL PLANTS		

REVISIONS	
NAME	DATE

ILLINOIS DEPARTMENT OF TRANSPORTATION

LANDSCAPING PLANS

U.S. RTE. 30 (LINCOLN HIGHWAY)

STA. 239+00 TO STA. 245+00

SCALE : 1" = 20' DRAWN BY : BAE
DATE : 10/12/2010 CHECKED BY : GB