

F.A.P. RTE.	SECTION	COUNTY	TOTAL SHEETS	SHEET NO.
353	(12&13)WRS-3	WILL	1235	480
STA.	TO STA.			
FED. ROAD DIST. NO.	SUBNO.	FED. AID PROJECT	CONTRACT NO. 62479	

LANDSCAPING GENERAL NOTES

1. TOPSOIL FURNISH AND PLACE, 8" SHALL BE USED IN PARKWAYS (WITH AND WITHOUT SIDEWALKS) ALONG U.S. 30 TO FACILITATE PROPOSED STREET TREE PLANTING. THIS AREA IS BETWEEN THE BACK OF CURB AND THE SIDEWALK (OR CENTERLINE OF THE DITCH) OR GENERALLY WITHIN 20' OF THE CURB.
2. TOPSOIL FURNISH AND PLACE, 24" SHALL BE USED IN ALL LANDSCAPED MEDIANS GREATER THAN 6' IN WIDTH.
3. COMPOST FURNISH AND PLACE, 4" SHALL BE USED WITH SEEDING CLASS 4 AND CLASS 5A.
4. TOPSOIL FURNISH AND PLACE, 4" SHALL BE USED AT ALL OTHER LOCATIONS NOT COVERED BY NOTES 1,2, & 3.
5. SEE SHEET 509A FOR SCHEDULE OF PERENNIAL PLANTS WHEN PLANTS ARE NOT LISTED WITH THE CALLOUT.

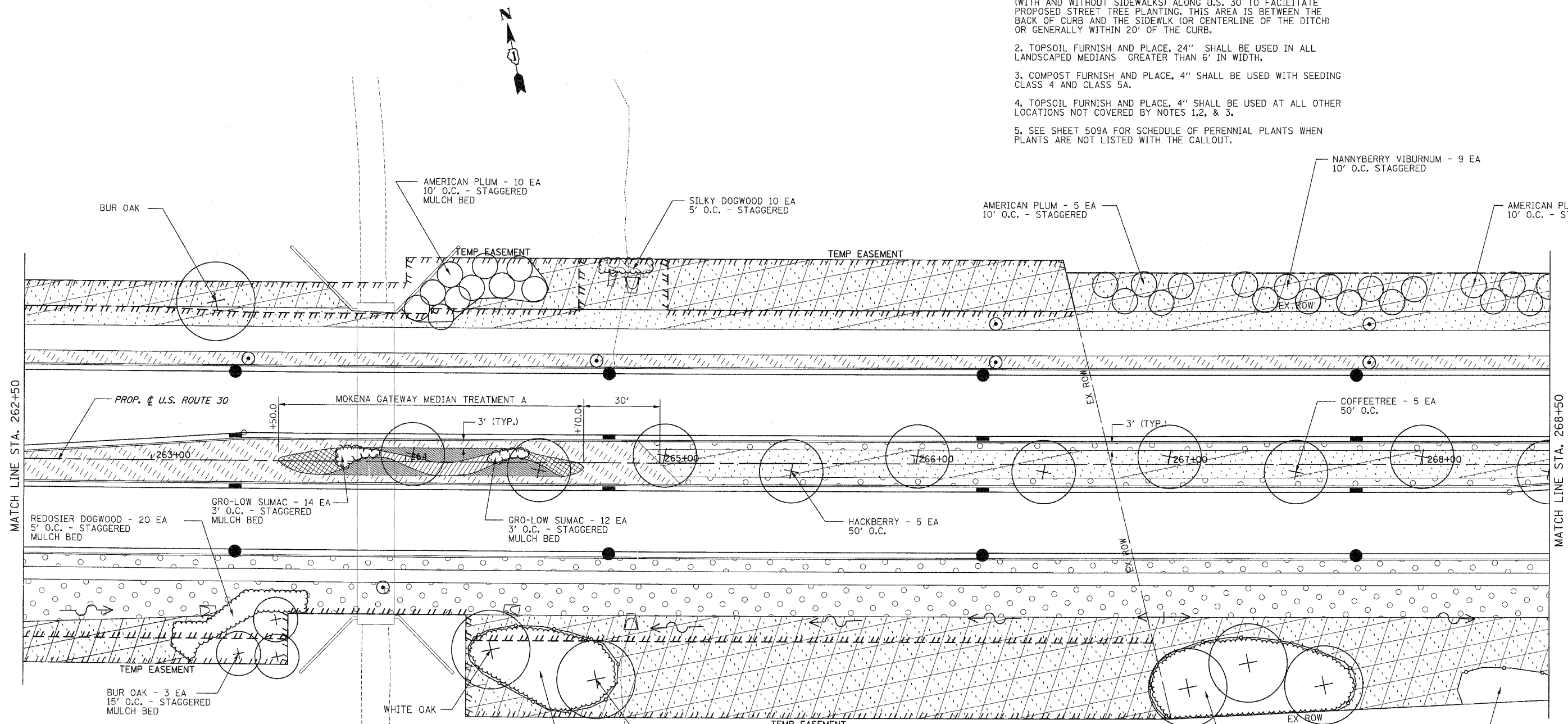

- LEGEND**
- SODDING, SALT TOLERANT
 - SEEDING, CLASS 2A
 - SEEDING, CLASS 4 & 5A COMBINED
 - SEEDING, CLASS 4
 - SEEDING, CLASS 1
 - PERENNIAL PLANTS
 - STONE RIPRAP, CLASS AS SPECIFIED
 - SEEDING, CLASS 4 (MODIFIED)
 - SEEDING, CLASS 4B (MODIFIED) WETLAND MIX
 - EXISTING SODDING
 - EXISTING SEEDING, CLASS 4

- AMERICAN PLUM - 10 EA 10' O.C. - STAGGERED MULCH BED
- SILKY DOGWOOD 10 EA 5' O.C. - STAGGERED
- AMERICAN PLUM - 5 EA 10' O.C. - STAGGERED
- AMERICAN PLUM - 5 EA 10' O.C. - STAGGERED
- GRO-LOW SUMAC - 14 EA 3' O.C. - STAGGERED MULCH BED
- GRO-LOW SUMAC - 12 EA 3' O.C. - STAGGERED MULCH BED
- HACKBERRY - 5 EA 50' O.C.
- REDOSTIER DOGWOOD - 20 EA 5' O.C. - STAGGERED MULCH BED
- BUR OAK - 3 EA 15' O.C. - STAGGERED MULCH BED
- WHITE OAK
- CRIMSON SPIRE OAK
- SHAGBARK HICKORY, CONTAINER - 8 EA BITTERNUT HICKORY, CONTAINER - 7 EA 10' O.C. - STAGGERED MULCH BED

- MOKENA GATEWAY MEDIAN TREATMENT A - 150 S.Y. PERENNIAL PLANTS, ORNAMENTAL TYPE, GALLON POT - 10.70 UNIT**
- RUDBECKIA SPECIOSA 'VIETTE'S LITTLE SUZY' (DWARF BLACK-EYED SUSAN) - 12" O.C. - 348 EA
 - SPOROBOLUS HETEROLEPSIS - (PRAIRIE DROPSIED) 12" O.C. - 232 EA
 - BAPTISIA 'SOLAR FLARE' (YELLOW FALSE INDIGO) - 18" O.C. - 35 EA
 - SORGHASTRUM NUTANS (INDIAN GRASS) - 18" O.C. - 20 EA
 - ECHINACEA PURPUREA 'SUNSET' (SUNSET CONEFLOWER) 12" O.C. - 260 EA
 - SCHIZACHYRIUM SCOPARIUM (LITTLE BLUESTEM) 12" O.C. - 175 EA

REVISIONS	
NAME	DATE

ILLINOIS DEPARTMENT OF TRANSPORTATION
LANDSCAPING PLANS
 U.S. RTE. 30 (LINCOLN HIGHWAY)
 STA. 262+50 TO STA. 268+50
 SCALE : 1" = 20'
 DATE : 10/12/2010
 DRAWN BY : BAE
 CHECKED BY : GB