

SECTION	COUNTY	TOTAL SHEETS	SHEET NO.
112 & 113 WRS-3	WIL		
STA.	TO STA.		
FED. ROAD DIST. NO.	ILLINOIS FED. AID PROJECT		

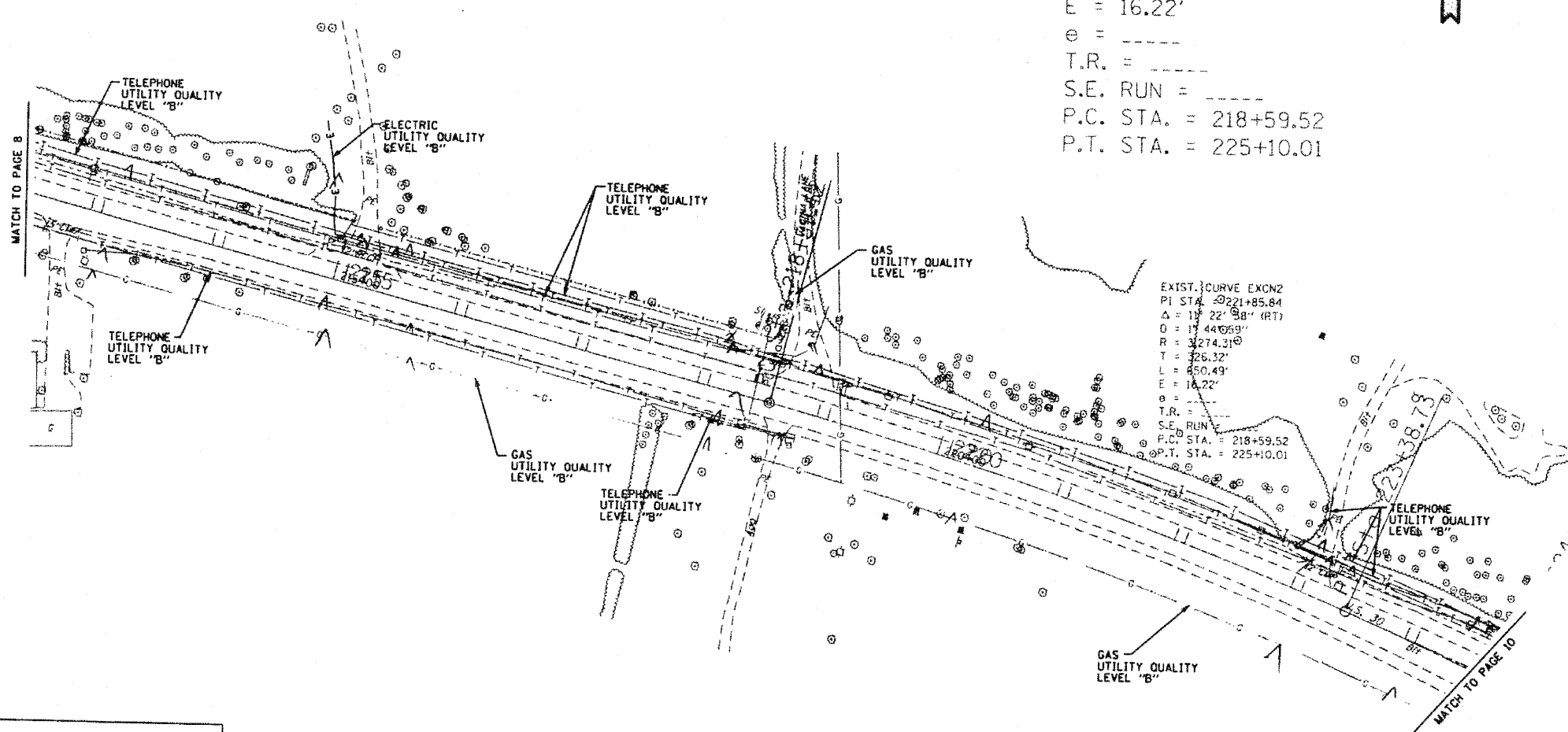

R = 3,274.31'  
 T = 326.32'  
 L = 650.49'  
 E = 16.22'  
 e = -----  
 T.R. = -----  
 S.E. RUN = -----  
 P.C. STA. = 218+59.52  
 P.T. STA. = 225+10.01



EXIST. CURVE EXCN2  
 PI STA. = 221+85.84  
 $\Delta = 117^{\circ} 22' 38''$  (RT)  
 O = 17' 44.059"  
 R = 3,274.31'  
 T = 326.32'  
 L = 650.49'  
 E = 16.22'  
 e = -----  
 T.R. = -----  
 S.E. RUN = -----  
 P.C. STA. = 218+59.52  
 P.T. STA. = 225+10.01

—T—T—T—	TELEPHONE
—W—W—W—	WATER
—G—G—G—	GAS
—CTV—CTV—CTV—	CABLE TELEVISION
—FO—FO—FO—	FIBER OPTIC
—E—E—E—	ELECTRIC

**TBE GROUP, INC.**  
 CIVIL ENGINEERING \* TRANSPORTATION \* ENVIRONMENTAL  
 PLANNING \* UTILITY ENGINEERING/LOCATING

IL09500213, 222, 233  
 Checked by: *[Signature]*  
 PAGE 9 OF 25  
 Utility Quality Level "B" : Designating

Utility shown on these plans as depicted in the legend have been investigated by TBE Group, Inc in accordance with SUE Industry Standards. All other information shown has been provided to TBE Group, Inc by others. TBE's SUE field investigation was performed during the period 10-13-04 through 04-21-05. Changes to utilities after these dates may have been made and therefore may result in variances from this plan. Consideration should be given to updating this plan if deemed advisable prior to final design and construction.



205 W. WACKER DRIVE  
 SUITE 1020  
 CHICAGO, IL 60606  
 (312) 704-1970

REVISIONS	
NAME	DATE

ILLINOIS DEPARTMENT OF TRANSPORTATION  
 US RT. 30 from William Street to Wolf Road and US RT. 30 from Wolf Road to US RT. 45 in Frankfort, Illinois-Will County  
 Contract No: 62479  
 Section No.: 112 & 113 WRS-4

DRAWN BY - KLC  
 SCALE : 1" = 50'