

BENCH MARK: BM 208
STA. 173+49.760, 35.343' LT., ELEV. 658.542
RAILROAD SPIKE IN NORTH FACE OF SECOND
POWER POLE EAST OF ANDERSON ROAD,
NORTH SIDE OF ROUTE 30.
EXISTING STRUCTURE: N/A
PROPOSED IMPROVEMENTS:
CONSTRUCTION OF A NEW 7'-0" X 5'-0" BOX CULVERT
DURING STAGE 1 CONSTRUCTION OF US 30, WITH
TEMPORARY CLOSURE OF BRISBANE ROAD.

STATION 170+61.58
BUILT BY
STATE OF ILLINOIS
FAP 353 SECT. (12 & 13) WRS-3
LOADING HS20
STR. NO. 099-C012

DESIGN SPECIFICATIONS
AASHTO 2002 SPECIFICATIONS.
LOADING HS20-44
ALLOW 50*/SQ.FT. FOR FUTURE WEARING SURFACE.
DESIGN STRESSES

NAME PLATE

NOTE: SEE STANDARD DRAWING 515001
FOR NAME PLATE DETAILS.

GENERAL NOTES

1. REINFORCEMENT BARS SHALL CONFORM TO THE REQUIREMENTS OF ASTM A 706 GR60. SEE SPECIAL PROVISIONS.
2. CAST-IN-PLACE BARREL SHALL BE POURED MONOLITHICALLY WITH WINGWALLS.
3. EXPOSED EDGES SHALL HAVE A 3/4" CHAMFER.
4. IN ACCORDANCE WITH ARTICLE 540.04 OF THE STANDARD SPECIFICATIONS, IT SHALL BE THE RESPONSIBILITY OF THE CONTRACTOR TO DIVERT STREAM FLOW DURING CONSTRUCTION IN ORDER TO KEEP THE CONSTRUCTION AREAS FREE OF WATER. THE METHOD OF WATER DIVERSION SHALL BE SUBJECT TO THE APPROVAL OF THE ENGINEER AND THE COST SHALL BE INCLUDED WITH "PRECAST CONCRETE, BOX CULVERT 7'x5". CLEAN FILL (GRANULAR) MATERIAL WILL ONLY BE ALLOWED.
5. THE PRECAST CONCRETE BOX CULVERT SHALL CONFORM TO THE REQUIREMENTS OF AASHTO M259 (DESIGN FILL HEIGHT- 3'-0")
6. THE CONTRACTOR SHALL PREPARE IN-STREAM WORK PLANS (ALL COFFERDAMS, WORK PADS, AND EROSION AND SEDIMENT CONTROL, ETC.) AND SUBMIT TO THE ENGINEER AND THE U.S. ARMY CORP OF ENGINEERS FOR REVIEW AND APPROVAL. THE CONTRACTOR SHOULD EXPECT TO HAVE TO ATTEND MEETINGS AT THE USACE OFFICE TO DISCUSS THEIR WORK PLAN IN ORDER TO SECURE THEIR PERMIT. THE COST OF ALL IN-STREAM WORK ITEMS WILL NOT BE PAID FOR SEPARATELY, BUT SHALL BE CONSIDERED AS INCLUDED IN THE UNIT BID PRICES OF THE CONTRACT, AND NO ADDITIONAL COMPENSATION WILL BE ALLOWED.

FIELD UNITS
f'c = 3,500 PSI
fy = 60,000 PSI (REINFORCEMENT)
PRECAST UNITS
f'c = 5,000 PSI
fy = 60,000 PSI (REINFORCEMENT)

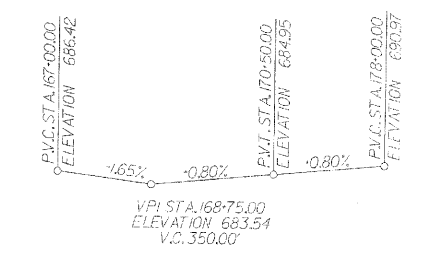

PROFILE GRADE - US 30
@ P.G. W.B.D. & E.B.D.

TOTAL BILL OF MATERIALS

ITEM	UNIT	QUANTITY
REINFORCEMENT BARS	POUND	7,294
NAME PLATES	EACH	1
CONCRETE BOX CULVERTS	CU. YD.	37.2
PRECAST CONCRETE BOX CULVERT 7' x 5'	FOOT	126.0
FRAMES AND LIDS, TYPE I, CLOSED LID	EACH	2

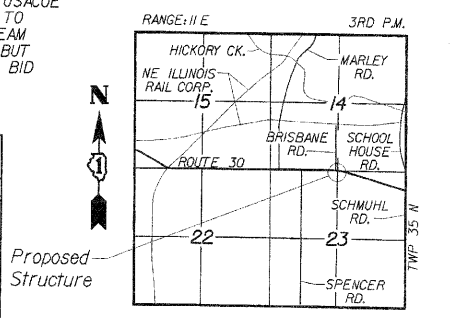

LOCATION SKETCH



Wayne A. Truex 7-6-10
Approved 11-30-10

DLZ 85 W. Algonquin Rd. Ste. 220
Arlington Heights IL 60005
DLZ Illinois, Inc.

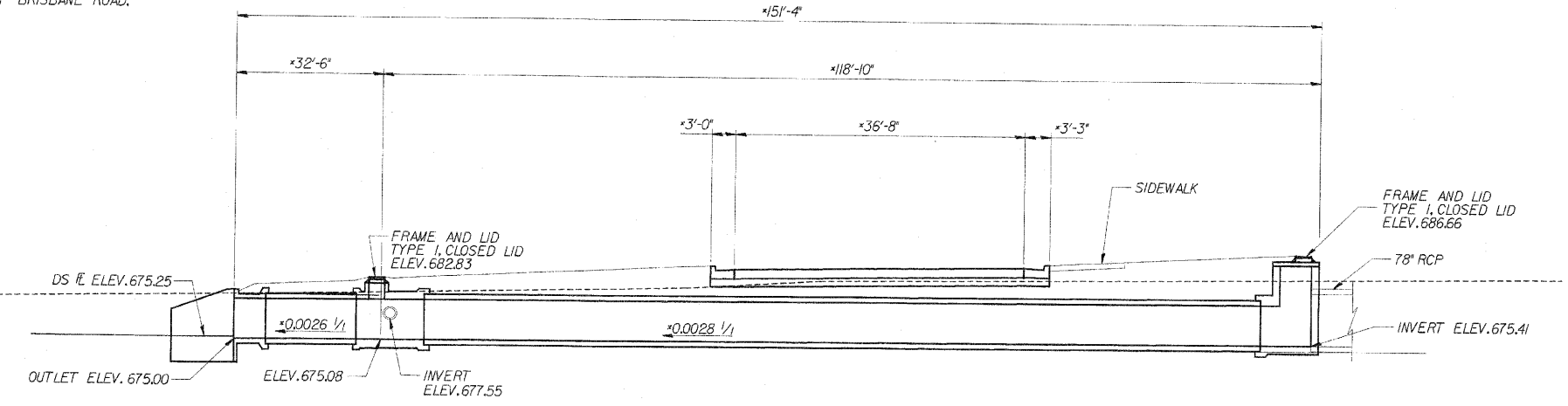

LONGITUDINAL SECTION

* MEASURED ALONG CENTERLINE OF CULVERT

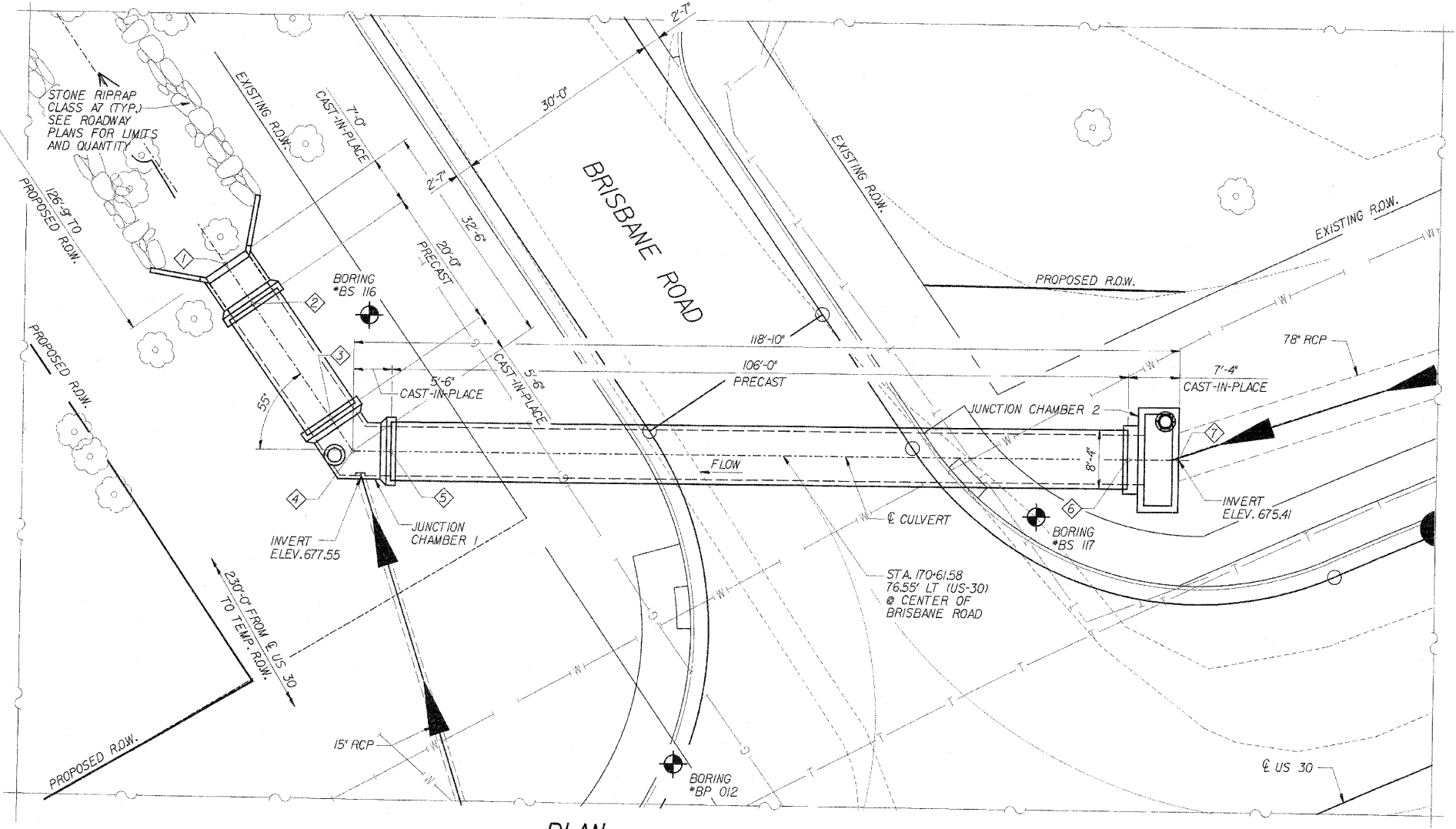

PLAN

DESIGNED	ASP
CHECKED	CDS
DRAWN	BEM
CHECKED	ASP

PT.	STATION	OFFSET
◇	170+01.04	135.42' LT.
◇	170+02.12	128.51' LT.
◇	170+05.22	108.77' LT.
◇	170+06.09	103.34' LT.
◇	170+10.88	100.97' LT.
◇	171+04.67	56.82' LT.
◇	171+11.26	53.89' LT.

REVISIONS	
NAME	DATE

CULVERT 'C'
GENERAL PLAN
U.S. ROUTE 30 (LINCOLN HIGHWAY)
F.A.P. 353 (U.S. 30)
SECTION (12 & 13) WRS-3
STATION 170+61.58, 76.55' LT.
WILL COUNTY
STRUCTURE NUMBER 099-C012

STATION INCREASE