

ROUTE NO.	SECTION	COUNTY	TOTAL SHEETS	SHEET NO.
PAP 363	*	WILL	1235	739
FED. ROAD DIST.	ILLINOIS	FED. AID PROJECT		

* SECT. 12 & 13) WRS-3
* CONTRACT NO. 62479

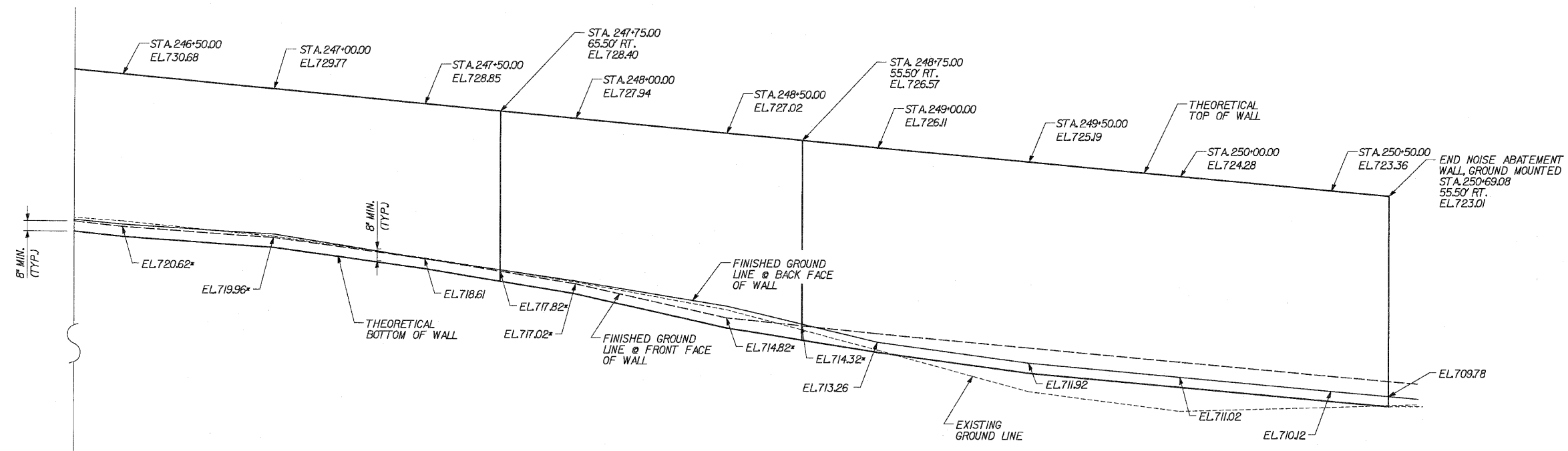

ELEVATION
(LOOKING @ BACK FACE)
* DENOTES FRONT FACE ELEVATION
GIVEN AS CONTROLLING ELEVATION

MATCH LINE STA. 246+34

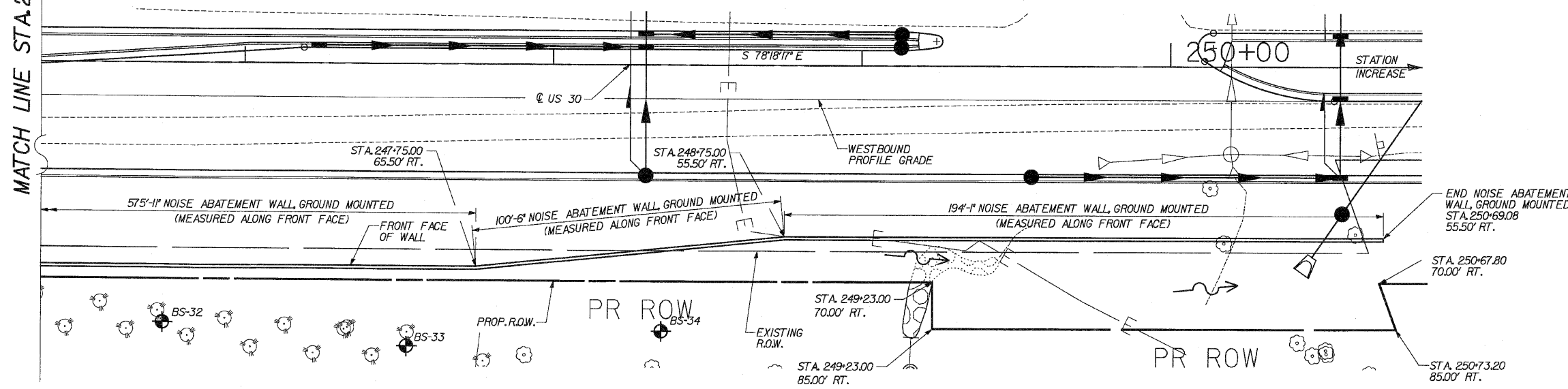

PLAN

NOTE:
STATIONS & OFFSETS ARE
FROM ϕ US 30 TO FRONT
FACE OF WALL.

DLZ 85 W. Algonquin Rd. Ste. 220
Arlington Heights IL 60005
DLZ Illinois, Inc.

DESIGNED	ASP
CHECKED	WSP
DRAWN	BGC
CHECKED	WSP

REVISIONS	
NAME	DATE

NOISE WALL B
PLAN & ELEVATION
U.S. ROUTE 30 (LINCOLN HIGHWAY)
F.A.P. 353 (U.S. 30)
SECTION (12 & 13) WRS-3
STATION 241+7.85 TO 250+69.08
WILL COUNTY