

- IRON PIPE OR ROD FOUND † PK NAIL SET
- + CUT CROSS FOUND OR SET • REPLACED AFTER CONSTRUCTION
- T1 THESE STAKES REFERENCE FOUND OR SET MONUMENTATION. SET 5/8 INCH IRON ROD FLUSHED WITH GROUND TO THE FOUND IRON STAKE. IDENTIFIED BY COLORED PLASTIC CAP BEARING SURVEYORS REGISTRATION NUMBER.
- T2
- T3
- BT1 THESE STAKES, IN CULTIVATED AREAS, REFERENCE FOUND OR SET MONUMENTATION. BURIED 5/8 INCH IRON ROD 20 INCHES BELOW GROUND TO THE FOUND IRON STAKE. IDENTIFIED BY COLORED PLASTIC CAP BEARING SURVEYORS REGISTRATION NUMBER.
- BT2
- BT3
- STAKING OF PROPOSED RIGHT OF WAY. SET DIVISION OF HIGHWAYS SURVEY MARKER TO MONUMENT THE POSITION SHOWN. IDENTIFIED BY INSCRIPTION DATA AND SURVEYORS REGISTRATION NUMBER.
- M STAKING OR PROPOSED RIGHT OF WAY IN CULTIVATED AREAS. BURIED 5/8 INCH METAL ROD 20 INCHES BELOW GROUND TO MARK FUTURE SURVEY MARKER POSITION. IDENTIFIED BY COLOR PLASTIC CAP BEARING SURVEYORS REGISTRATION NUMBER.
- ⊕ PERMANENT SURVEY MARKER, I D O T STD. 2135 (TO BE SET BY OTHERS)
- RIGHT OF WAY STAKING PROPOSED TO BE SET.

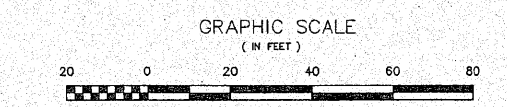
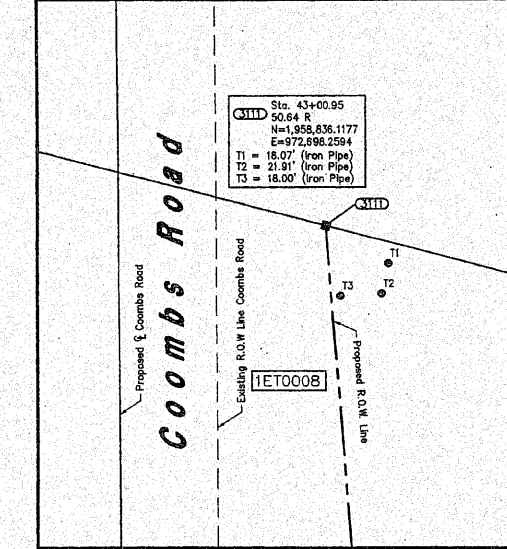

W-T **W-T LAND SURVEYING, INC.**
LAND AND CONSTRUCTION SURVEYORS
39 EAST SCULLY DRIVE
SCHAUMBURG, ILLINOIS 60193
ph. (847)895-3640
fax. (847)895-9985

PLAT OF HIGHWAYS
STATE OF ILLINOIS
DEPARTMENT OF TRANSPORTATION
F.A.P. 345 (US ROUTE 20)

SECTION PLANK RD & WELD RD KANE COUNTY
PROJECT JOB NO. R-91-069-01
STATION N/A TO STATION N/A
SCALE: N/A SHEET 13 OF 15

BUREAU OF LAND ACQUISITION
201 WEST CENTER COURT
SCHAUMBURG, ILLINOIS 60196-1096

2007K088001
SANDY WEGMAN
RECORDER - KANE COUNTY, IL
RECORDED: 8/23/2007 12:46 PM
REC.FEE: 70.00
PAGES: 15

Mail To:
Illinois Department of Transportation
ATTN: Land Acquisition - 5th Floor
201 West Center Court
Schaumburg, IL 60196-1096

FOR INFORMATION ONLY

