

F.A.P. RTE.	SECTION	COUNTY	TOTAL SHEETS	SHEET NO.
345	8WRS-2	KANE	72	45
STA. 99+00.00		TO STA. 114+00.00		
FED. ROAD DIST. NO.	ILLINOIS	FED. AID PROJECT		

FOR INFORMATION ONLY

EXIST. CURVE 1
 PI STA. = 99+98.57
 $\Delta = 14^\circ 12' 29''$ (RT)
 $D = 3^\circ 54' 13''$
 $R = 1,467.81'$
 $T = 182.93'$
 $L = 363.98'$
 $E = 11.36'$
 $\theta =$
 $T.R. =$
 $S.E. RUN =$
 $P.C. STA. = 98+15.64$
 $P.T. STA. = 101+79.62$

PROP. CURVE C2
 PI STA. = 100+34.16
 $\Delta = 12^\circ 13' 05''$ (RT)
 $D = 1^\circ 08' 45''$
 $R = 5,000.00'$
 $T = 535.14'$
 $L = 1,066.22'$
 $E = 28.56'$
 $\theta = 0.022$
 $T.R. = 150'$
 $S.E. RUN = 165'$
 $P.C. STA. = 94+97.22$
 $P.T. STA. = 105+63.45$

PIN# 06-18-100-002
 BUSINESS

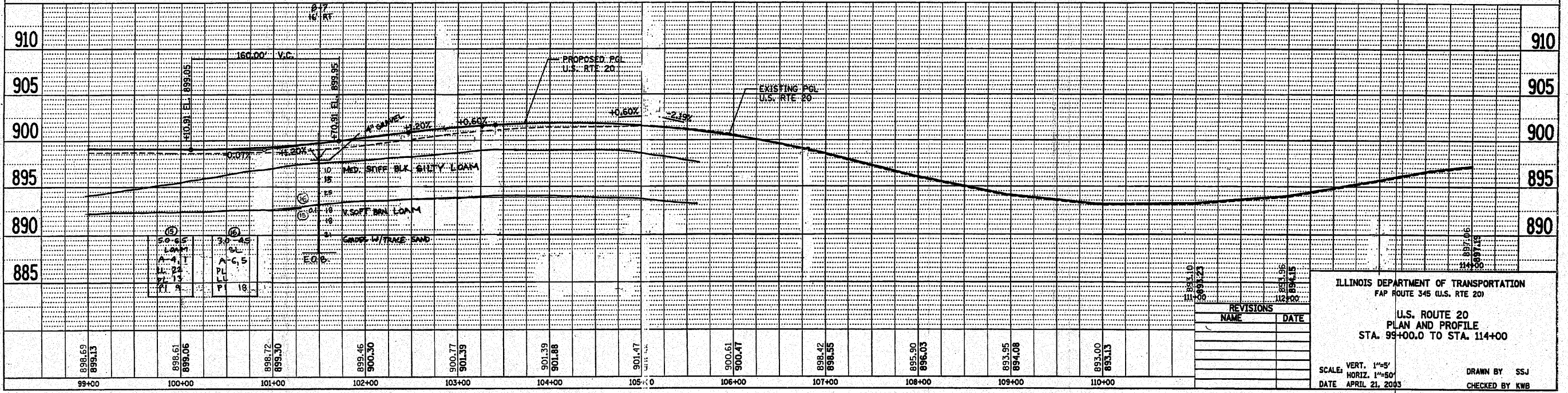
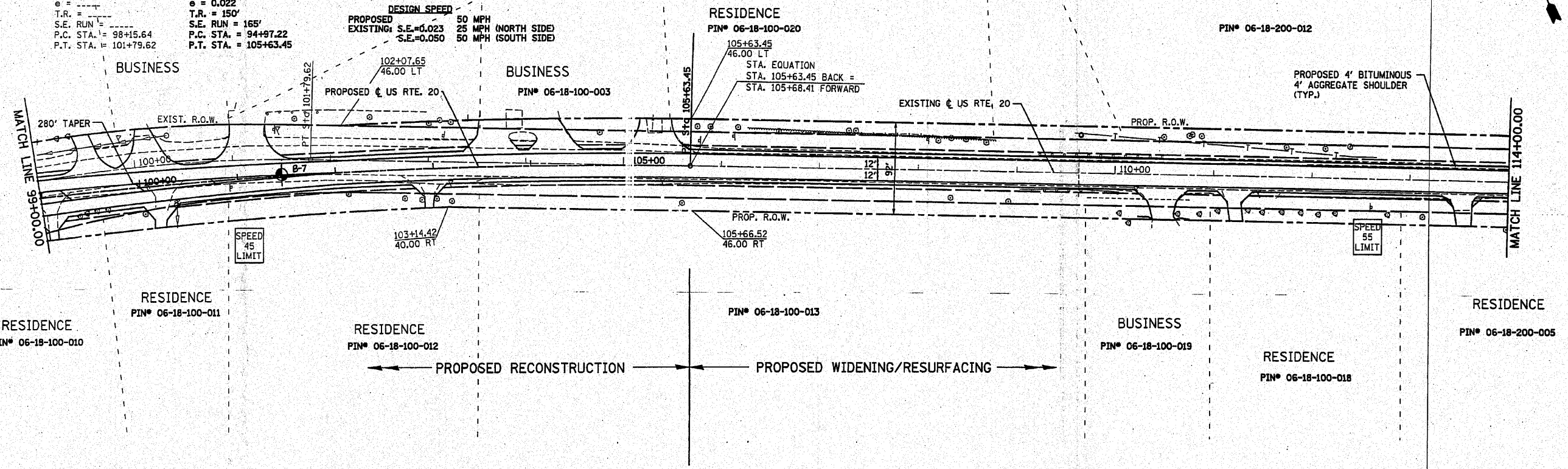

ILLINOIS DEPARTMENT OF TRANSPORTATION
 FAP ROUTE 345 (U.S. RTE 20)

U.S. ROUTE 20
 PLAN AND PROFILE
 STA. 99+00.0 TO STA. 114+00.0

SCALE: VERT. 1"=5'
 HORIZ. 1"=50'
 DATE APRIL 21, 2003

DRAWN BY SSJ
 CHECKED BY KWB

REVISIONS	
NAME	DATE

DATE	BY

PLAN
 DRAWN BY: []
 CHECKED BY: []
 DATE: []

DATE	BY

PROFILE
 DRAWN BY: []
 CHECKED BY: []
 DATE: []