

SECTION 36, TOWNSHIP 36, RANGE 12  
 SECTION 25, TOWNSHIP 36, RANGE 12  
 SECTION 31, TOWNSHIP 36, RANGE 13  
 SECTION 30, TOWNSHIP 36, RANGE 13

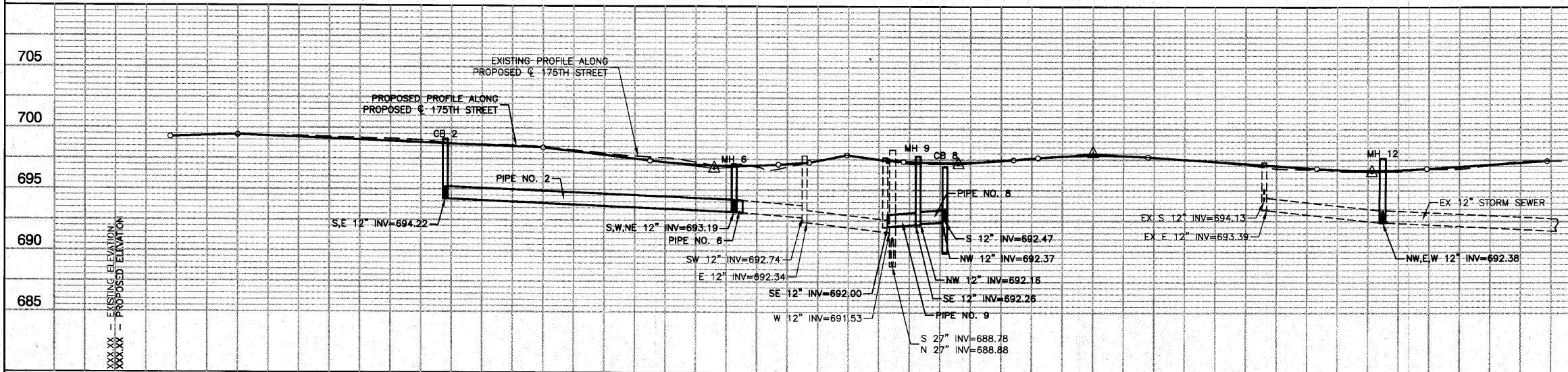
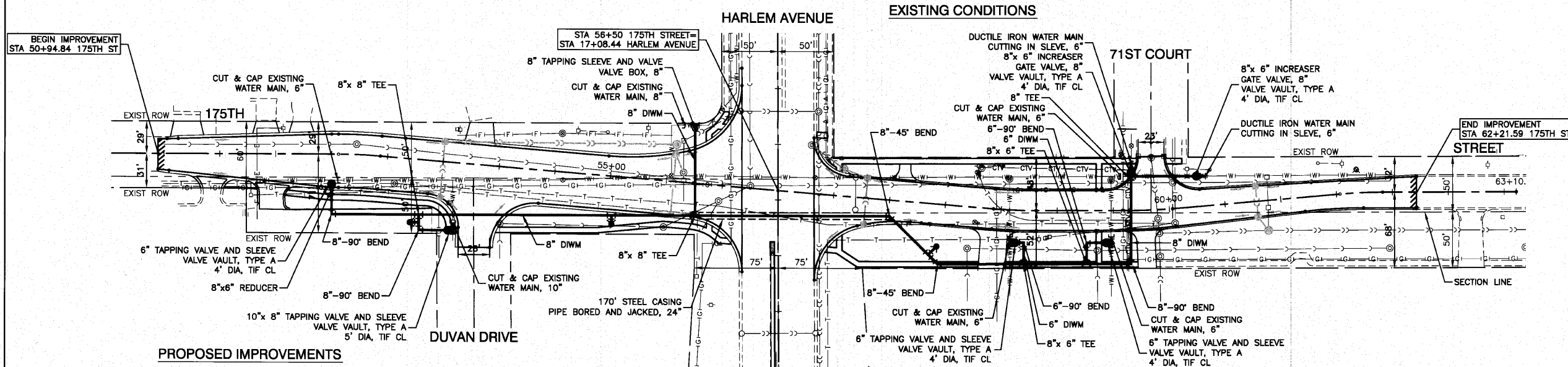
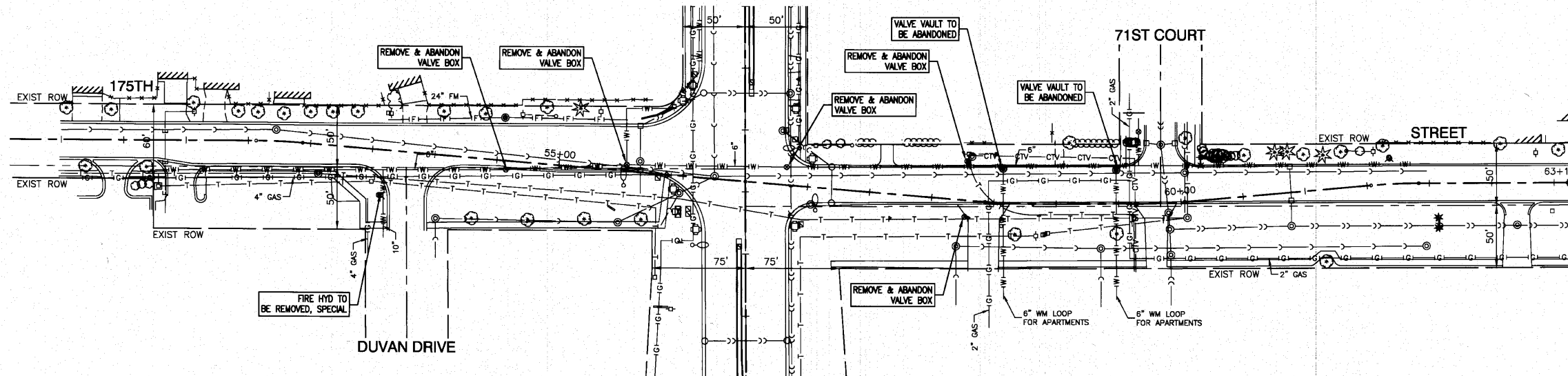
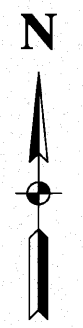

**NOTES:**

- ALL OFFSETS TO CURBLINE STRUCTURES ARE GIVEN TO THE EDGE OF PAVEMENT. OFFSETS FOR FLARED END SECTIONS ARE GIVEN AT PIPE CONNECTIONS. ALL OTHER OFFSETS ARE GIVEN TO THE CENTER OF THE STRUCTURE.
- ALL RIM ELEVATIONS FOR CURBLINE STRUCTURES ARE EDGE OF PAVEMENT ELEVATIONS.
- [W.M.R.] DENOTES WATER MAIN REQUIREMENTS
- (XX.X) DENOTES CUBIC YARDS TRENCH BACKFILL
- SEE SHEET 22 FOR DRAINAGE IMPROVEMENTS.

**BENCH MARK:**  
 SQUARE CUT IN NORTH SIDE OF CONC BASE OF FENCE POST AT THE NORTH EAST CORNER OF STATE OF ILLINOIS PUMPING STATION AT THE NORTH EAST CORNER OF HICKORY STREET AND HARLEM AVENUE. ELEVATION=698.19

FILE NAME = 06608-ST18M-01 - WMO1	USER NAME =	DESIGNED = WPD	REVISED =	<b>STATE OF ILLINOIS DEPARTMENT OF TRANSPORTATION</b>	<b>175TH STREET AT HARLEM AVENUE INTERSECTION IMPROVEMENTS WATER MAIN RELOCATION PLAN 175TH STREET</b>		F.A.P. RTE. = 348	SECTION = 06-00104-00-CH	COUNTY = COOK	TOTAL SHEETS = 60	SHEET NO. = 24
PLOT SCALE = 1"=50'	DRAWN = AG	CHECKED = WPD	REVISED =		SCALE: H 1"=50' V 1"=5'	SHEET NO. 24 OF 60 SHEETS	STA. 50+94.84 TO STA. 62+21.59	FED. ROAD DIST. NO. 1	ILLINOIS	FED. AID PROJECT #HSIP-8003 (851)	CONTRACT NO. 83453
PLOT DATE = 10-14-10	CHECKED = AG	DRAWN = AG	REVISED =								
		CHECKED = AG	REVISED =								