

NOTES:

- ① PROPOSED FIBER OPTIC CABLE IN CONDUIT, SM24F
- ② TERMINATE FIBERS AT DISTRIBUTION ENCLOSURE IN CABINET
- ③ PROPOSED ELECTRIC CABLE IN CONDUIT, TRACER, NO. 14 1C
- ④ SPLICE FIBERS IN CABINET
- ⑤ EXISTING 12F MM FIBER OPTIC AND TRACER CABLES TO REMAIN
- ⑥ REMOVE COPPER INTERCONNECT CABLE FROM CONDUIT
- ⑦ COIL 40' OF FIBER OPTIC CABLE SLACK IN DOUBLE HANDHOLE
- ⑧ POSSIBLE UTILITY CONFLICT

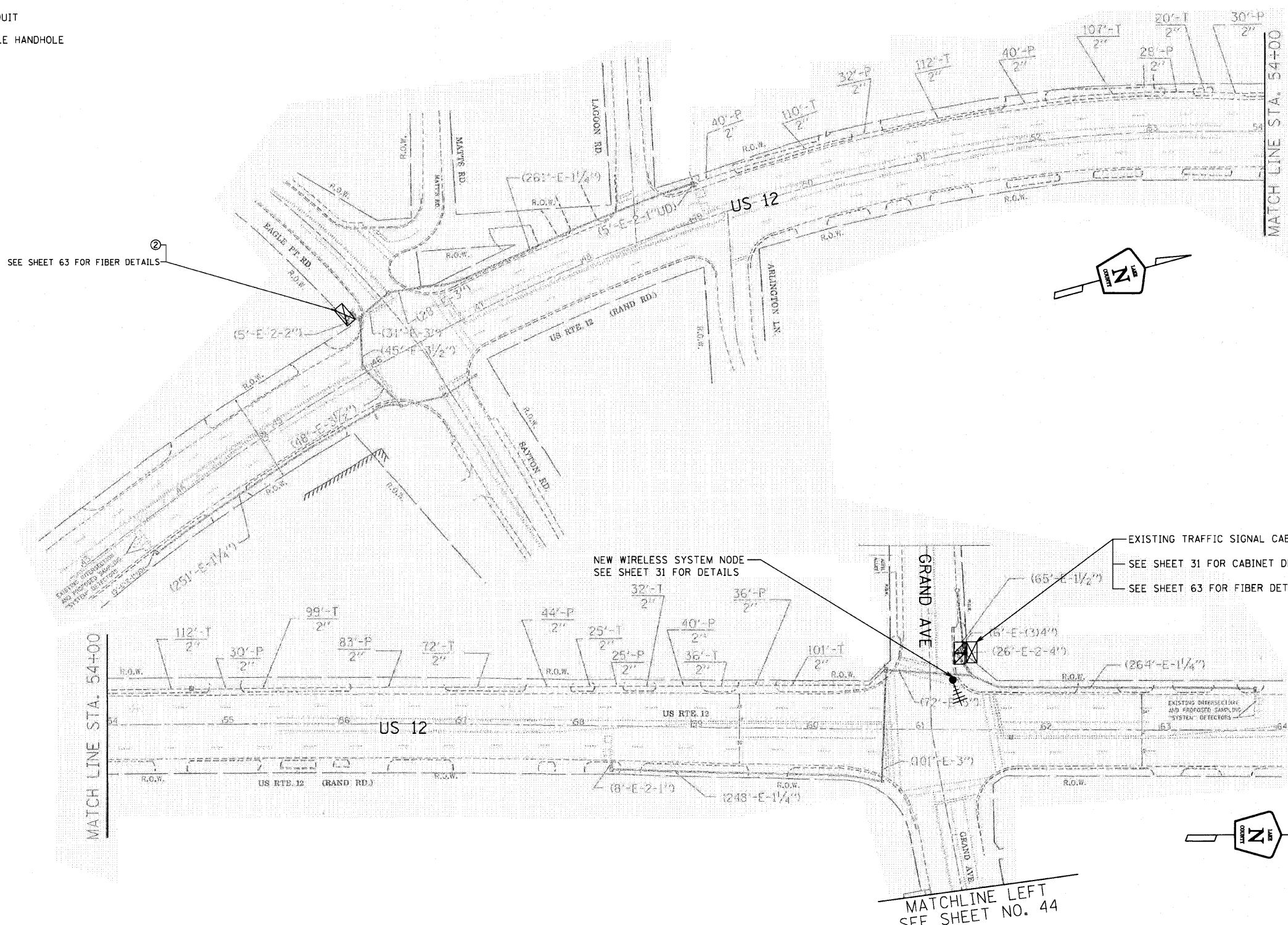
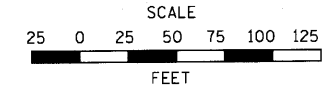

NEW WIRELESS SYSTEM NODE  
SEE SHEET 31 FOR DETAILS

EXISTING TRAFFIC SIGNAL CABINET  
SEE SHEET 31 FOR CABINET DETAILS  
SEE SHEET 63 FOR FIBER DETAILS

MATCHLINE LEFT  
SEE SHEET NO. 44



USER NAME = JM	DESIGNED - DG	REVISED -
	DRAWN - JM	REVISED -
PLOT SCALE =	CHECKED - DG	REVISED -
PLOT DATE = 10-05-2010	DATE - 10-05-2010	REVISED -

STATE OF ILLINOIS  
DEPARTMENT OF TRANSPORTATION

US 12 INTERCONNECT	
FROM EAGLE PT RD./SAYTON RD. TO GRAND AVE.	
SCALE: 1"=50'	SHEET 1 OF 12

ROUTE	SECTION	SECTION NUMBER	SHEET	SHEETS
FAU 181		09-00999-07-TL	43	72
C3-1			CONTRACT NO. 09472	