

NOTES:

- ① PROPOSED FIBER OPTIC CABLE IN CONDUIT, SM24F
- ② TERMINATE FIBERS AT DISTRIBUTION ENCLOSURE IN CABINET
- ③ PROPOSED ELECTRIC CABLE IN CONDUIT, TRACER, NO. 14 1C
- ④ SPLICE FIBERS IN CABINET
- ⑤ EXISTING 12F MM FIBER OPTIC AND TRACER CABLES TO REMAIN
- ⑥ REMOVE COPPER INTERCONNECT CABLE FROM CONDUIT
- ⑦ COIL 40' OF FIBER OPTIC CABLE SLACK IN DOUBLE HANDHOLE
- ⑧ POSSIBLE UTILITY CONFLICT

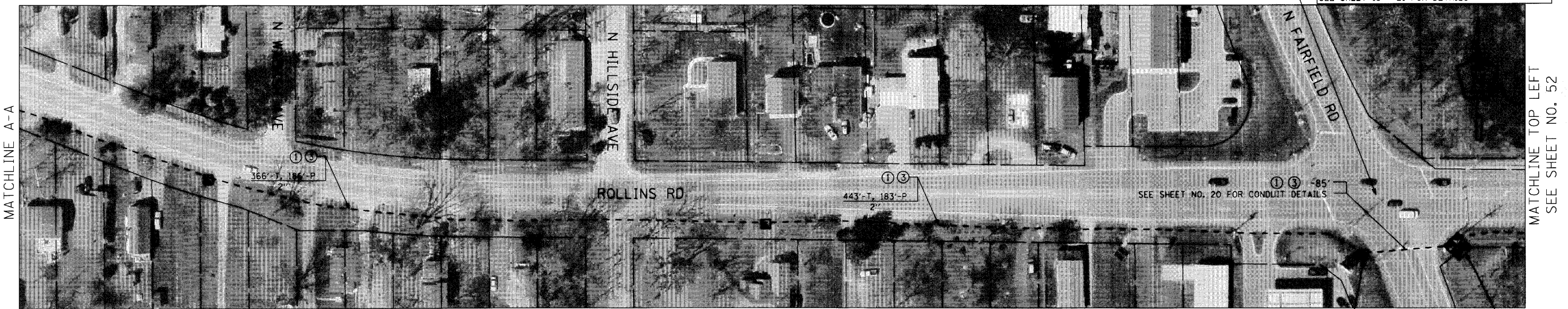
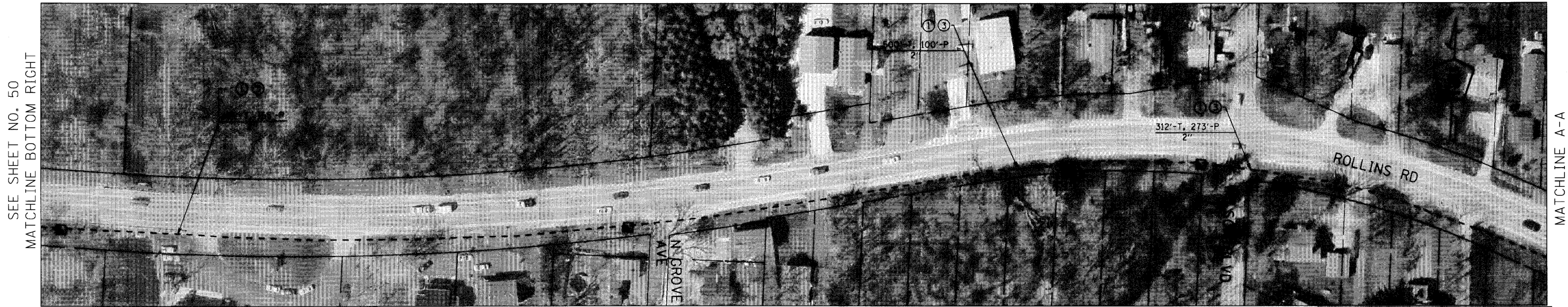
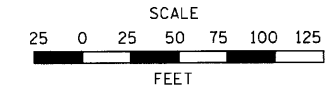

SEE SHEET NO. 20 FOR CONDUIT DETAILS

SEE SHEET NO. 20 FOR HANDHOLE DETAILS

SEE SHEET NO. 20 FOR CABINET DETAILS
 SEE SHEET NO. 63 FOR FIBER DETAILS



USER NAME = JM	DESIGNED - DG	REVISED -
PLOT SCALE =	DRAWN - JM	REVISED -
PLOT DATE = 10-05-2010	CHECKED - DC	REVISED -
	DATE - 10-05-2010	REVISED -

**STATE OF ILLINOIS
 DEPARTMENT OF TRANSPORTATION**

ROLLINS ROAD INTERCONNECT FROM GRAND AVE. TO CEDAR LAKE RD.	
ROUTE FAU 181	SECTION SECTION NUMBER 09-00999-07-TL
SCALE: 1"=50'	SHEET 9 OF 12

SHEET 51	SHEETS 72
CONTRACT NO. 09472	