

NOTES:

1. SEE "REMOVAL AND ADJUSTMENT PLANS" FOR REMOVAL OF EXISTING ITEMS.
2. CONTRACTOR SHALL MAINTAIN ACCESS TO ENTRANCES AT ALL TIMES AND PROVIDE TEMPORARY ENTRANCES WHERE REQUIRED DURING CONSTRUCTION.
3. THE CONTRACTOR SHALL APPLY TYPE III PAVEMENT MARKING TAPE AS DIRECTED BY THE ENGINEER. THIS ITEM SHALL BE INCLUDED IN THE COST OF TEMPORARY PAVEMENT MARKINGS.

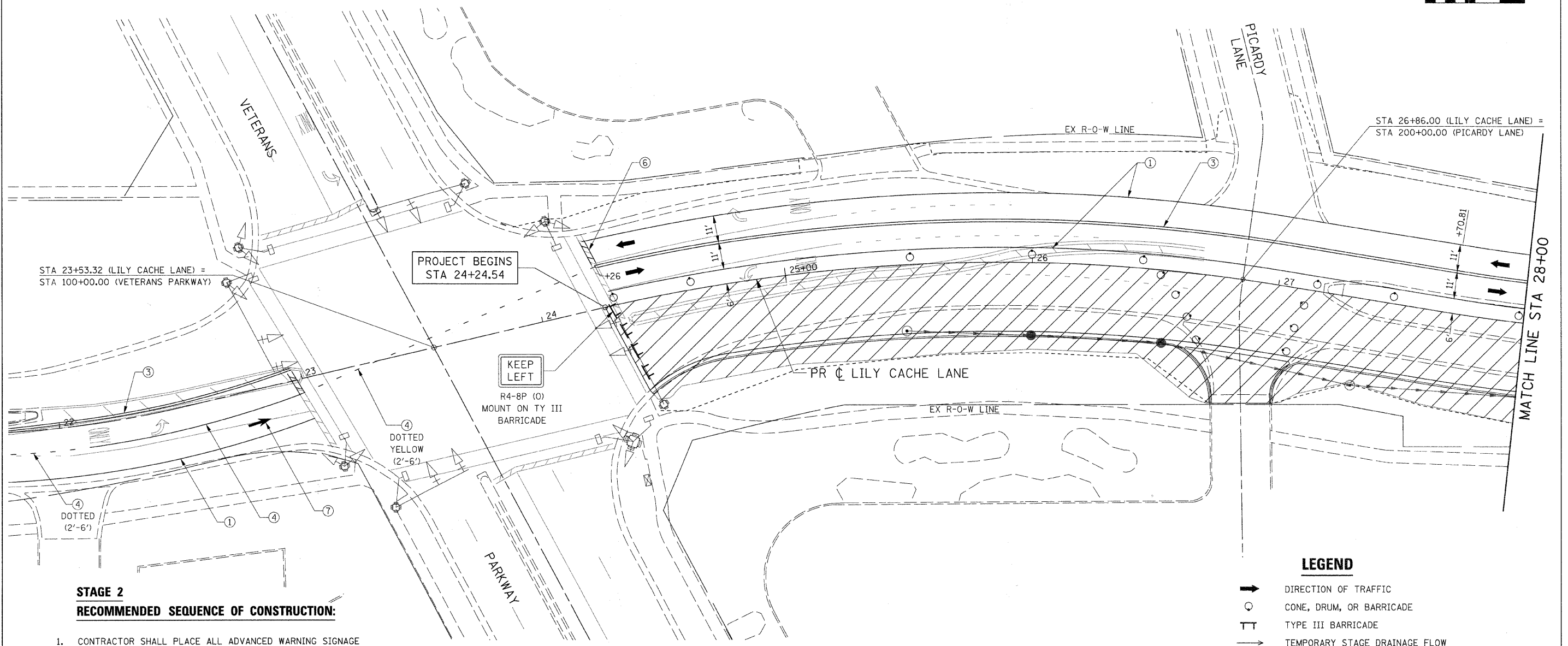
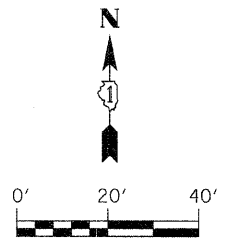

**STAGE 2
RECOMMENDED SEQUENCE OF CONSTRUCTION:**

1. CONTRACTOR SHALL PLACE ALL ADVANCED WARNING SIGNAGE PRIOR TO BEGINNING ANY CONSTRUCTION IN ACCORDANCE WITH STANDARD 701501.
2. CONTRACTOR SHALL REMOVE ALL CONFLICTING PAVEMENT MARKINGS AND PLACE ALL TEMPORARY PAVEMENT MARKINGS AS SHOWN ON THE PLANS.
3. TRAFFIC WILL BE SHIFTED TO TWO 11' LANES ON THE NORTH SIDE OF EXISTING PAVEMENT, UNLESS OTHERWISE SHOWN.
4. REMOVE THE SOUTH SIDE EXISTING CURB AND GUTTER AND CONSTRUCT THE PROPOSED TEMPORARY WIDENING AND CURB AND GUTTER AS SHOWN.

LEGEND

- ➔ DIRECTION OF TRAFFIC
- CONE, DRUM, OR BARRICADE
- ⊥ TYPE III BARRICADE
- ➔ TEMPORARY STAGE DRAINAGE FLOW
- ▨ STAGE CONSTRUCTION LIMITS
- ▨ TEMPORARY PAVEMENT
- ▨ TEMPORARY PAVEMENT REMOVAL
- ① TEMP. PAVEMENT MARKING - LINE 4" (WHITE)
- ② TEMP. PAVEMENT MARKING - LINE 4" (YELLOW)
- ③ TEMP. PAVEMENT MARKING - LINE 4" (DOUBLE YELLOW)
- ④ TEMP. PAVEMENT MARKING - LINE 6" (WHITE)
- ⑤ TEMP. PAVEMENT MARKING - LINE 12" (YELLOW)
- ⑥ TEMP. PAVEMENT MARKING - LINE 24" (WHITE)
- ⑦ TEMP. PAVEMENT MARKING - LETTERS & SYMBOLS

FILE NAME = G:\S09021\CADD_Sheets\9021M072-01.dgn	USER NAME = IE Consultants	DESIGNED -	REVISED -	STATE OF ILLINOIS DEPARTMENT OF TRANSPORTATION	SUGGESTED STAGING PLAN STAGE 2 - LILY CACHE LANE	F.A.U.	SECTION	COUNTY	TOTAL SHEETS	SHEET NO.	
PLOT SCALE = 20.0000' / IN.	CHECKED -	REVISED -	1578			06-00046-01-PV	WILL	244	97		
PLOT DATE = 10/22/2010	DATE -	REVISED -	CONTRACT NO. 63503								
						ILLINOIS FED. AID PROJECT					
						SCALE:	SHEET NO. OF SHEETS STA. 24+24.54 TO STA. 28+00				