

PLAN	REVISIONS	DATE
NO.	BY	
NO.	BY	
NO.	BY	
NO.	BY	
NO.	BY	
NO.	BY	
NO.	BY	
NO.	BY	
NO.	BY	
NO.	BY	

PROFILE	REVISIONS	DATE
NO.	BY	
NO.	BY	
NO.	BY	
NO.	BY	
NO.	BY	
NO.	BY	
NO.	BY	
NO.	BY	
NO.	BY	
NO.	BY	

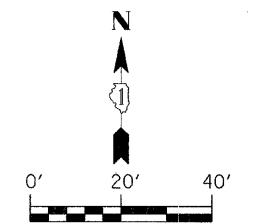

- ALL STORM SEWER IS TO BE RUBBER GASKET AND IS PAID FOR AS "STORM SEWERS, RUBBER GASKET, CLASS A" OF THE TYPE AND DIAMETER SPECIFIED IN THE SUMMARY OF QUANTITIES AND SCHEDULE OF QUANTITIES.
- N-2.26 STA. 43+10, 27.5' LT. INLET, TY A, TY 3V F & G EOP ELEV. 672.51 S FL ELEV. 668.60
  - N-2.27 STA. 43+05, 32.0' RT. MANHOLE, TY A (6' DIA) W/ RESTRICTOR TY 1 FRAME - CLID RIM ELEV. 673.10 N FL ELEV. 666.35 E FL ELEV. 663.15 W FL ELEV. 662.15
  - SS-2.26 12" RCCP TY 2, CLASS A 61' @ 3.68%
  - SS-2.27 48" RCCP TY 2, CLASS A 280' @ 0.20%
  - N-2.28 STA. 45+85, 32.0' RT. MANHOLE, TY A (6' DIA) TY 1 FRAME - CLID RIM ELEV. 673.35 N FL ELEV. 667.65 E FL ELEV. 663.80 W FL ELEV. 663.70
  - N-2.29 STA. 47+28, 27.5' LT. INLET, TY A, TY 3 F & G EOP ELEV. 671.49 E FL ELEV. 668.00
  - N-2.30 STA. 47+50, 27.5' LT. CATCH BASIN, TY D (3' DIA) TY 3 F & G EOP ELEV. 671.52 W FL ELEV. 667.90 S FL ELEV. 667.80
  - N-2.31 STA. 47+28, 27.5' RT. CATCH BASIN, TY D (6' DIA) TY 15 FRAME & LID EOP ELEV. 671.49 N FL ELEV. 664.20 W FL ELEV. 664.10
  - N-2.32 STA. 47+50, 27.5' RT. CATCH BASIN, TY D (6' DIA) TY 15 FRAME & LID EOP ELEV. 671.52 N FL ELEV. 666.90 E FL ELEV. 664.35 W FL ELEV. 664.25
  - SS-2.28 48" RCCP TY 2, CLASS A 143' @ 0.21%
  - SS-2.29 12" RCCP TY 1, CLASS A 22' @ 0.45%
  - SS-2.30 12" RCCP TY 2, CLASS A 58' @ 1.55%
  - SS-2.31 48" RCCP TY 1, CLASS A 22' @ 0.23%
  - SS-2.65 12" RCCP TY 2, CLASS A 76' @ 3.03%

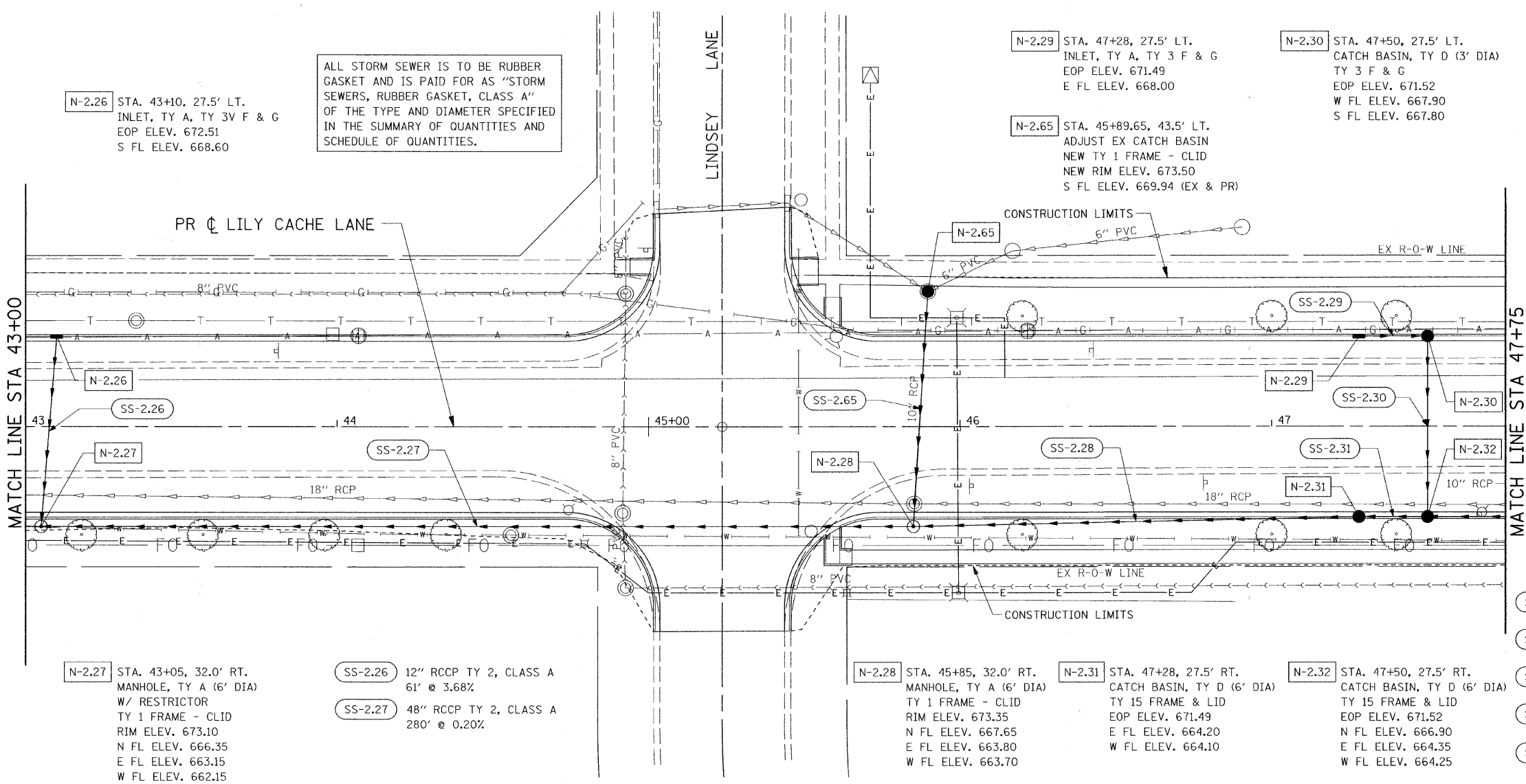
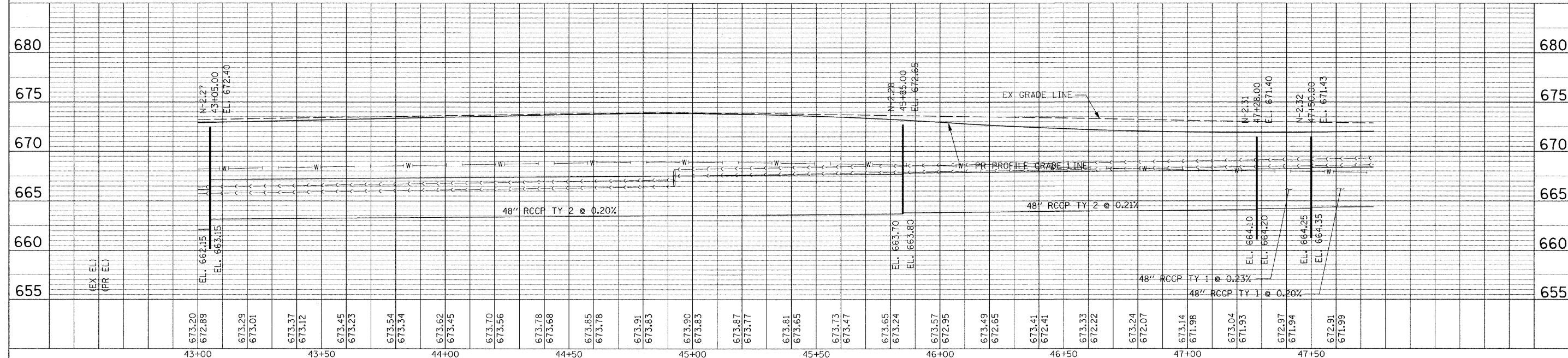

FILE NAME = G:\S09021\CADD_Sheets\9021D05.dgn	USER NAME = IE Consultants	DESIGNED -	REVISED -	<b>STATE OF ILLINOIS DEPARTMENT OF TRANSPORTATION</b>	<b>LILY CACHE LANE DRAINAGE AND UTILITY PLAN</b>				F.A.U. RTE. 1578	SECTION 06-00046-01-PV	COUNTY WILL	TOTAL SHEETS 244	SHEET NO. 148
PLOT SCALE = 20.0000' / IN.	CHECKED -	REVISED -	REVISED -		SCALE:	SHEET NO. OF SHEETS	STA. 43+00 TO STA. 47+75	CONTRACT NO. 63503		ILLINOIS FED. AID PROJECT			
PLOT DATE = 11/16/2010	DATE -	REVISED -	REVISED -										