

- SS-2.56 15" RCCP TY 2, CLASS A  
90' @ 0.56%
- SS-2.58 12" RCCP TY 2, CLASS A  
90' @ 0.61%
- SS-2.59 12" RCCP TY 2, CLASS A  
47' @ 1.90%
- SS-2.60 12" RCCP TY 2, CLASS A  
105' @ 0.62%

N-2.59 STA. 58+90, 22.0' LT.  
INLET, TY A, TY 3V F & G  
EOP ELEV. 676.88  
S FL ELEV. 673.20

ALL STORM SEWER IS TO BE RUBBER GASKET AND IS PAID FOR AS "STORM SEWERS, RUBBER GASKET, CLASS A" OF THE TYPE AND DIAMETER SPECIFIED IN THE SUMMARY OF QUANTITIES AND SCHEDULE OF QUANTITIES.

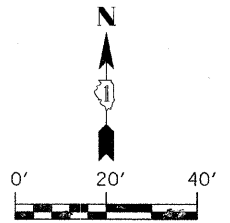

PLAN	DATE
REVISION	BY
NO. 1	DATE
NO. 2	BY
NO. 3	DATE
NO. 4	BY
NO. 5	DATE
NO. 6	BY
NO. 7	DATE
NO. 8	BY
NO. 9	DATE
NO. 10	BY
NO. 11	DATE
NO. 12	BY
NO. 13	DATE
NO. 14	BY
NO. 15	DATE
NO. 16	BY
NO. 17	DATE
NO. 18	BY
NO. 19	DATE
NO. 20	BY
NO. 21	DATE
NO. 22	BY
NO. 23	DATE
NO. 24	BY
NO. 25	DATE
NO. 26	BY
NO. 27	DATE
NO. 28	BY
NO. 29	DATE
NO. 30	BY
NO. 31	DATE
NO. 32	BY
NO. 33	DATE
NO. 34	BY
NO. 35	DATE
NO. 36	BY
NO. 37	DATE
NO. 38	BY
NO. 39	DATE
NO. 40	BY
NO. 41	DATE
NO. 42	BY
NO. 43	DATE
NO. 44	BY
NO. 45	DATE
NO. 46	BY
NO. 47	DATE
NO. 48	BY
NO. 49	DATE
NO. 50	BY
NO. 51	DATE
NO. 52	BY
NO. 53	DATE
NO. 54	BY
NO. 55	DATE
NO. 56	BY
NO. 57	DATE
NO. 58	BY
NO. 59	DATE
NO. 60	BY
NO. 61	DATE
NO. 62	BY
NO. 63	DATE
NO. 64	BY
NO. 65	DATE
NO. 66	BY
NO. 67	DATE
NO. 68	BY
NO. 69	DATE
NO. 70	BY
NO. 71	DATE
NO. 72	BY
NO. 73	DATE
NO. 74	BY
NO. 75	DATE
NO. 76	BY
NO. 77	DATE
NO. 78	BY
NO. 79	DATE
NO. 80	BY
NO. 81	DATE
NO. 82	BY
NO. 83	DATE
NO. 84	BY
NO. 85	DATE
NO. 86	BY
NO. 87	DATE
NO. 88	BY
NO. 89	DATE
NO. 90	BY
NO. 91	DATE
NO. 92	BY
NO. 93	DATE
NO. 94	BY
NO. 95	DATE
NO. 96	BY
NO. 97	DATE
NO. 98	BY
NO. 99	DATE
NO. 100	BY

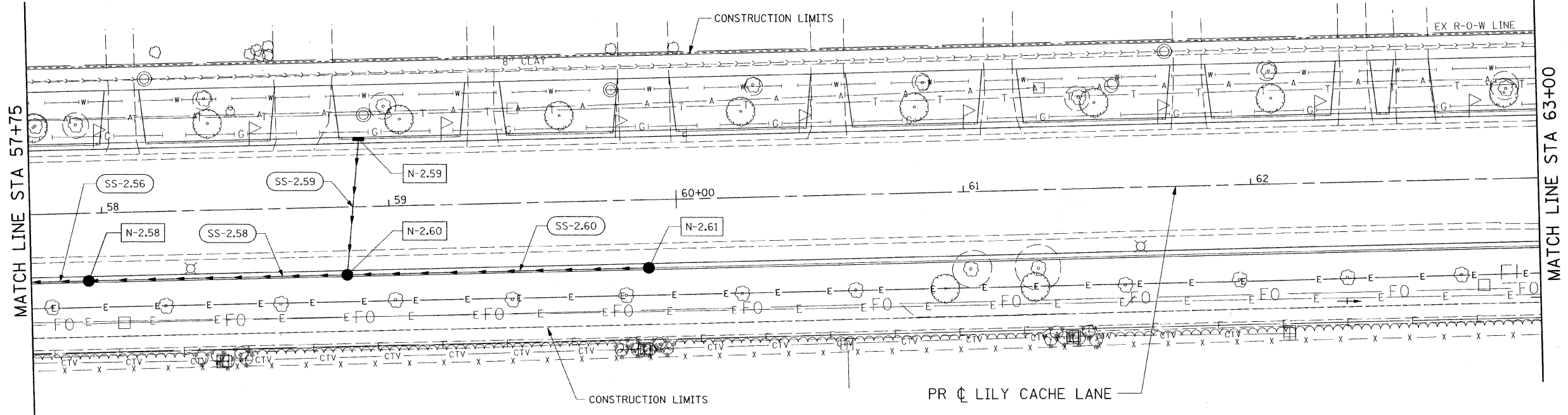

N-2.58 STA. 57+95, 22.0' RT.  
CATCH BASIN, TY D (4' DIA)  
TY 15 FRAME & LID  
EOP ELEV. 676.42  
E FL ELEV. 668.95  
W FL ELEV. 668.85

N-2.60 STA. 58+85, 22.0' RT.  
CATCH BASIN, TY D (4' DIA)  
TY 15 FRAME & LID  
EOP ELEV. 676.85  
N FL ELEV. 672.30  
E FL ELEV. 669.60  
W FL ELEV. 669.50

N-2.61 STA. 59+90, 22.0' RT.  
CATCH BASIN, TY D (3' DIA)  
TY 15 FRAME & LID  
EOP ELEV. 677.56  
E FL ELEV. 670.25

PROFILE	DATE
REVISION	BY
NO. 1	DATE
NO. 2	BY
NO. 3	DATE
NO. 4	BY
NO. 5	DATE
NO. 6	BY
NO. 7	DATE
NO. 8	BY
NO. 9	DATE
NO. 10	BY
NO. 11	DATE
NO. 12	BY
NO. 13	DATE
NO. 14	BY
NO. 15	DATE
NO. 16	BY
NO. 17	DATE
NO. 18	BY
NO. 19	DATE
NO. 20	BY
NO. 21	DATE
NO. 22	BY
NO. 23	DATE
NO. 24	BY
NO. 25	DATE
NO. 26	BY
NO. 27	DATE
NO. 28	BY
NO. 29	DATE
NO. 30	BY
NO. 31	DATE
NO. 32	BY
NO. 33	DATE
NO. 34	BY
NO. 35	DATE
NO. 36	BY
NO. 37	DATE
NO. 38	BY
NO. 39	DATE
NO. 40	BY
NO. 41	DATE
NO. 42	BY
NO. 43	DATE
NO. 44	BY
NO. 45	DATE
NO. 46	BY
NO. 47	DATE
NO. 48	BY
NO. 49	DATE
NO. 50	BY
NO. 51	DATE
NO. 52	BY
NO. 53	DATE
NO. 54	BY
NO. 55	DATE
NO. 56	BY
NO. 57	DATE
NO. 58	BY
NO. 59	DATE
NO. 60	BY
NO. 61	DATE
NO. 62	BY
NO. 63	DATE
NO. 64	BY
NO. 65	DATE
NO. 66	BY
NO. 67	DATE
NO. 68	BY
NO. 69	DATE
NO. 70	BY
NO. 71	DATE
NO. 72	BY
NO. 73	DATE
NO. 74	BY
NO. 75	DATE
NO. 76	BY
NO. 77	DATE
NO. 78	BY
NO. 79	DATE
NO. 80	BY
NO. 81	DATE
NO. 82	BY
NO. 83	DATE
NO. 84	BY
NO. 85	DATE
NO. 86	BY
NO. 87	DATE
NO. 88	BY
NO. 89	DATE
NO. 90	BY
NO. 91	DATE
NO. 92	BY
NO. 93	DATE
NO. 94	BY
NO. 95	DATE
NO. 96	BY
NO. 97	DATE
NO. 98	BY
NO. 99	DATE
NO. 100	BY

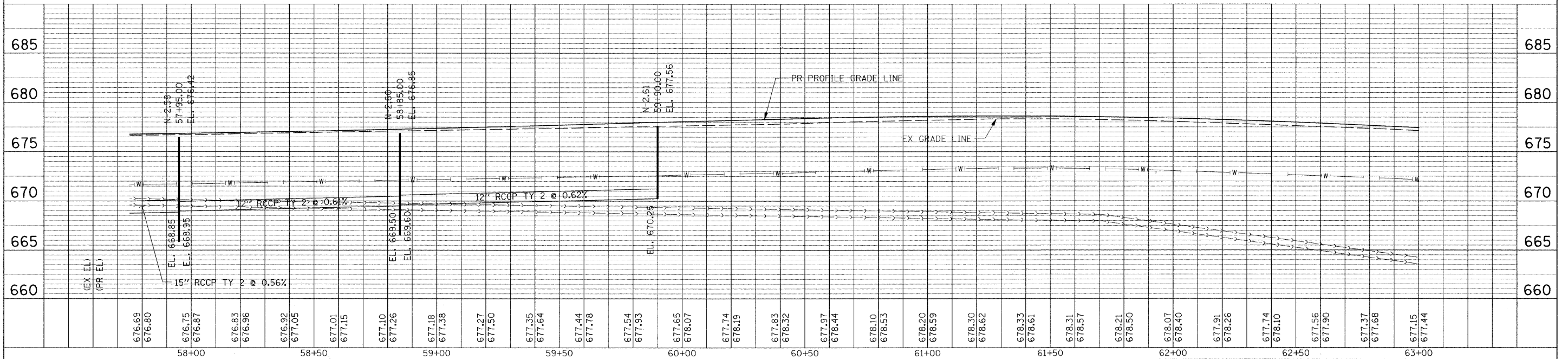

FILE NAME = G:\S09021\CADD_Sheets\9021DF08.dgn	USER NAME = IE Consultants	DESIGNED -	REVISIONS -	<b>STATE OF ILLINOIS DEPARTMENT OF TRANSPORTATION</b>	<b>LILY CACHE LANE DRAINAGE AND UTILITY PLAN</b>			F.A.U. RTE. 1578	SECTION 06-00046-01-PV	COUNTY WILL	TOTAL SHEETS 244	SHEET NO. 151
	PLLOT SCALE = 20.0000' / IN.	DRAWN -	REVISIONS -		SCALE:	SHEET NO. OF SHEETS	STA. 57+75 TO STA. 65+00	CONTRACT NO. 63503		ILLINOIS FED. AID PROJECT		
	PLLOT DATE = 11/16/2010	CHECKED -	REVISIONS -									
		DATE -	REVISIONS -									