

PLAN	REVIEWED	BY	DATE
	PLOTTED		
	NOTE BOOK		
	FILE NAME		
	NO.		

PROFILE	REVIEWED	BY	DATE
	PLOTTED		
	NOTE BOOK		
	FILE NAME		
	NO.		

SEC GROUP, INC.  
 PROJECT CONTACT: A. JAIN  
 VILLAGE OF CARPENTERSVILLE  
 420 N. First Street  
 Carpentersville, IL 61814  
 618.336.1779  
 FILE NAME: 060324-17-17.dgn  
 PLOT DRIVER: parlat  
 PEN TABLE: standard-trans.tbl

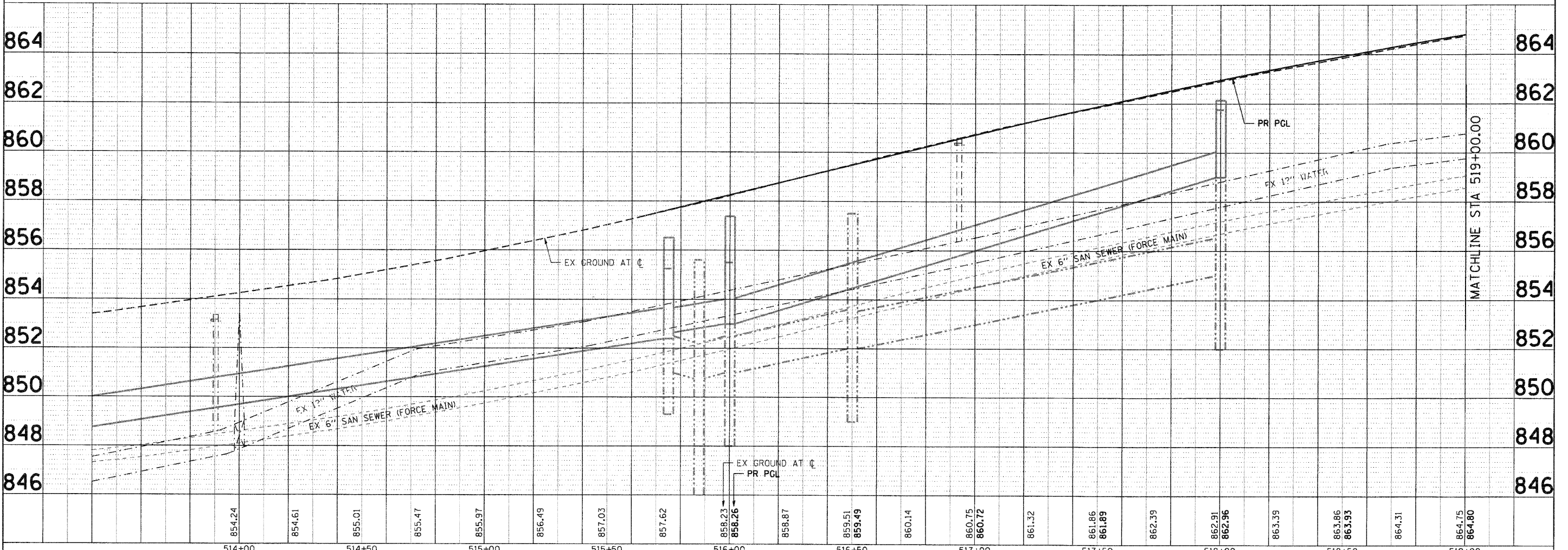
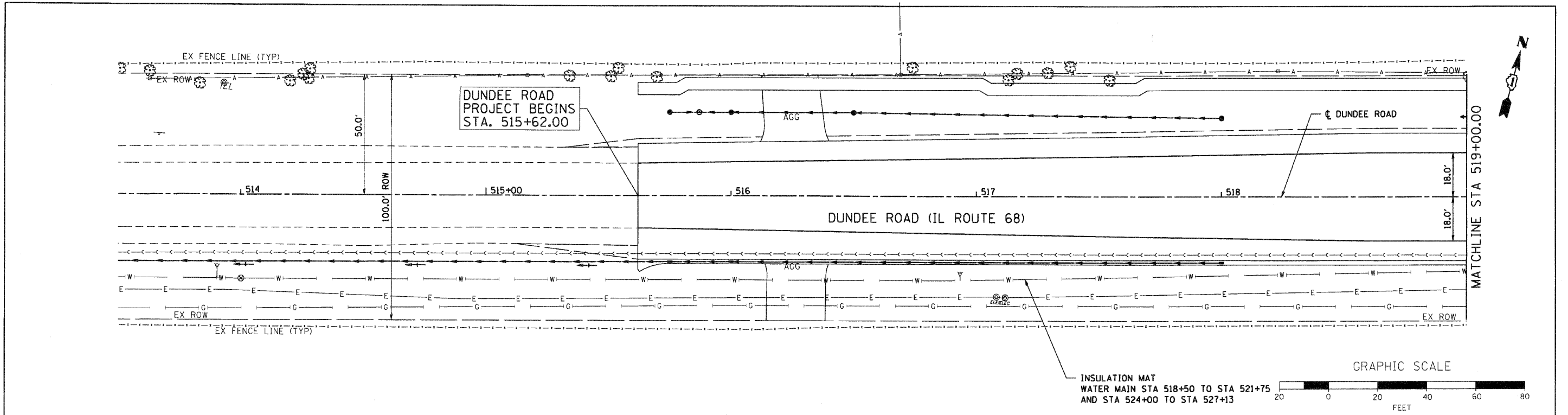

<p>SEC Group, Inc.          An HDR Group Company          420 N. First Street          Carpentersville, IL 61814          618.336.1779          www.secgroup.com</p>	USER NAME = CHeerke DESIGNED - C. PIEPER DRAWN - R. BEST CHECKED - T. HAMILTON DATE - 10/25/10	REVISED - REVISED - REVISED - REVISED -	<b>VILLAGE OF CARPENTERSVILLE</b> <b>WATERMAIN AND SANITARY SEWER PLAN AND PROFILE</b> <b>DUNDEE ROAD (IL ROUTE 68)</b>	F.A. RTE. SECTION COUNTY TOTAL SHEETS SHEET NO. 06-00074-00-PP KANE 211 86 FAU 2414, FAU 1280, FAP 343 CONTRACT NO. 63504 FED. ROAD DIST. NO. [ILLINOIS] FED. AID PROJECT
	PLOT SCALE = 1" = 20' PLOT DATE = 11/1/2010	SCALE: 1" = 20' SHEET NO. 17 OF 20 SHEETS STA. BEGIN TO STA. 519+00		